



TRAFFIC CRASH REPORT

LOCAL REPORT NUMBER *	32188	CRASH SEVERITY	HIT/SKIP
		1 - FATAL	1 - SOLVED
		2 - INJURY	2 - UNSOLVED
		3 - PDO	

LOCAL INFORMATION

<input type="checkbox"/> PHOTOS TAKEN	<input type="checkbox"/> PDO UNDER STATE REPORTABLE DOLLAR AMOUNT	<input type="checkbox"/> PRIVATE PROPERTY	REPORTING AGENCY NCIC *	REPORTING AGENCY NAME *	NUMBER OF UNITS	UNIT IN ERROR
<input checked="" type="checkbox"/> OH-2	<input type="checkbox"/> OH-1P	<input type="checkbox"/> OTHER	08304	MASON POLICE	02	02

COUNTY *	CITY *	CITY, VILLAGE, TOWNSHIP *	CRASH DATE *	TIME OF CRASH	DAY OF WEEK
83		MASON	09202016	1240	TUE

DEGREES / MINUTES / SECONDS	DECIMAL DEGREES
LATITUDE: 39° 21' 34.12" N	LATITUDE: 39.356701
LONGITUDE: -84° 17' 25.00" W	LONGITUDE: -84.290276

ROADWAY DIVISION	DIVIDED LANE DIRECTION OF TRAVEL	NUMBER OF THRU LANES	ROAD TYPES OR MILEPOST ²
<input checked="" type="checkbox"/> DIVIDED	<input type="checkbox"/> N - NORTHBOUND	02	AL - ALLEY CR - CIRCLE HE - HEIGHTS MP - MILEPOST PL - PLACE ST - STREET WA - WAY

LOCATION ROUTE TYPE ¹	LOCATION ROUTE NUMBER	LOC PREFIX N,S,E,W	LOCATION ROAD NAME	LOCATION ROAD TYPE ²	ROUTE TYPES ¹
			KINGS MILLS	RD	IR - INTERSTATE ROUTE (INC. TURNPIKE) CR - NUMBERED COUNTY ROUTE US - US ROUTE TR - NUMBERED TOWNSHIP ROUTE SR - STATE ROUTE

DISTANCE FROM REFERENCE	DIR FROM REF	REFERENCE ROUTE TYPE ¹	REFERENCE ROUTE NUMBER	REF PREFIX N,S,E,W	REFERENCE NAME (ROAD, MILEPOST, HOUSE #)	REFERENCE ROAD TYPE ²
40	E				COX SMITH	RD

REFERENCE POINT USED	CRASH LOCATION	LOCATION OF FIRST HARMFUL EVENT
1 - INTERSECTION	01 - NOT AN INTERSECTION	1 - ON ROADWAY
2 - MILE POST	02 - FOUR-WAY INTERSECTION	2 - ON SHOULDER
3 - HOUSE NUMBER	03 - T-INTERSECTION	3 - IN MEDIAN
	04 - Y-INTERSECTION	4 - ON ROADSIDE
	05 - TRAFFIC CIRCLE/ROUNDBOAT	5 - ON GORE
	06 - FIVE-POINT, OR MORE	6 - OUTSIDE TRAFFICWAY
	07 - ON RAMP	9 - UNKNOWN
	08 - OFF RAMP	
	09 - CROSSOVER	
	10 - DRIVEWAY/ALLEY ACCESS	
	11 - RAILWAY GRADE CROSSING	
	12 - SHARED-USE PATHS OR TRAILS	
	99 - UNKNOWN	

ROAD CONTOUR	ROAD CONDITIONS	WEATHER
1 - STRAIGHT LEVEL	01 - DRY	1 - CLEAR
2 - STRAIGHT GRADE	02 - WET	2 - CLOUDY
3 - CURVE LEVEL	03 - SNOW	3 - FOG, SMOG, SMOKE
	04 - ICE	4 - RAIN
		5 - SLEET, HAIL
		6 - SNOW
		7 - SEVERE CROSSWINDS
		8 - BLOWING SAND, SOIL, DIRT, SNOW
		9 - OTHER/UNKNOWN

MANNER OF CRASH COLLISION/IMPACT	WEATHER
1 - NOT COLLISION BETWEEN TWO MOTOR VEHICLES IN TRANSPORT	1 - CLEAR
2 - REAR-END	2 - CLOUDY
3 - HEAD-ON	3 - FOG, SMOG, SMOKE
4 - REAR-TO-REAR	4 - RAIN
5 - BACKING	5 - SLEET, HAIL
6 - ANGLE	6 - SNOW
7 - SIDESWIPE, SAME DIRECTION	7 - SEVERE CROSSWINDS
8 - SIDESWIPE, OPPOSITE DIRECTION	8 - BLOWING SAND, SOIL, DIRT, SNOW
9 - UNKNOWN	9 - OTHER/UNKNOWN

ROAD SURFACE	LIGHT CONDITIONS	SCHOOL BUS RELATED
1 - CONCRETE	1 - DAYLIGHT	<input type="checkbox"/> YES, SCHOOL BUS DIRECTLY INVOLVED
2 - BLACKTOP, BITUMINOUS, ASPHALT	2 - DAWN	<input type="checkbox"/> YES, SCHOOL BUS INDIRECTLY INVOLVED
3 - BRICK/BLOCK	3 - DUSK	
4 - SLAG, GRAVEL, STONE	4 - DARK - LIGHTED ROADWAY	
5 - DIRT	5 - DARK - ROADWAY NOT LIGHTED	
6 - OTHER	6 - DARK - UNKNOWN ROADWAY LIGHTING	
	7 - GLARE*	
	8 - OTHER	
	9 - UNKNOWN	

WORK ZONE RELATED	WORKERS PRESENT	TYPE OF WORK ZONE	LOCATION OF CRASH IN WORK ZONE
<input type="checkbox"/>	<input type="checkbox"/>	1 - LANE CLOSURE	1 - BEFORE THE FIRST WORK ZONE WARNING SIGN
<input type="checkbox"/>	<input type="checkbox"/>	2 - LANE SHIFT/CROSSOVER	2 - ADVANCE WARNING AREA
<input type="checkbox"/>	<input type="checkbox"/>	3 - WORK ON SHOULDER OR MEDIAN	3 - TRANSITION AREA
<input type="checkbox"/>	<input type="checkbox"/>	4 - INTERMITTENT OR MOVING WORK	4 - ACTIVITY AREA
<input type="checkbox"/>	<input type="checkbox"/>	5 - OTHER	5 - TERMINATION AREA

NARRATIVE

UNITS #1 AND #2 WERE WEST BOUND ON KINGS MILLS RD. UNIT #1 SLOWED IN TRAFFIC AND WAS STRUCK FROM BEHIND BY #2.

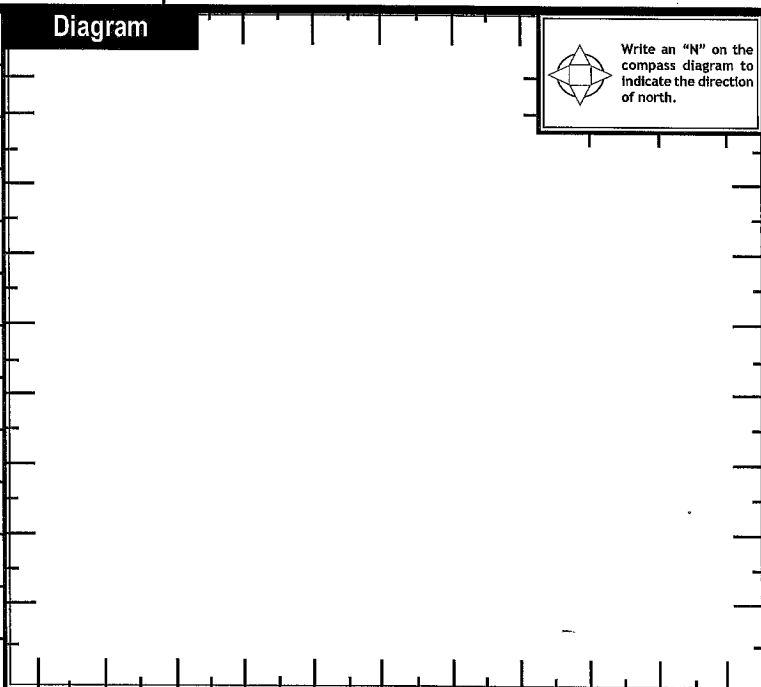

REPORT TAKEN BY	SUPPLEMENT (CORRECTION OR ADDITION TO AN EXISTING REPORT SENT TO ODPS)	DATE CRASH REPORTED	TIME CRASH REPORTED	DISPATCH TIME	ARRIVAL TIME	TIME CLEARED	OTHER INVESTIGATION TIME	TOTAL MINUTES
POLICE AGENCY		09202016	1241	1243	1248	1350	20	82
OFFICER'S NAME *	OFFICER'S BADGE NUMBER	CHECKED BY	PAGE OF					
BRYANT	55	50						

400 KM



UNIT

LOCAL REPORT NUMBER

UNIT NUMBER 01	OWNER NAME: LAST, FIRST, MIDDLE (<input type="checkbox"/> SAME AS DRIVER) HENRY, KEVIN L.	OWNER PHONE NUMBER - INC. AREA CODE (<input checked="" type="checkbox"/> SAME AS DRIVER)	DAMAGE SCALE 2	DAMAGED AREA
OWNER ADDRESS: CITY, STATE, ZIP (<input checked="" type="checkbox"/> SAME AS DRIVER)			1 - NONE	
LP STATE OH	LICENSE PLATE NUMBER GUK 4930	VEHICLE IDENTIFICATION NUMBER 2T1K1B2E03C007908	2 - MINOR	
VEHICLE YEAR 2003	VEHICLE MAKE TOYOTA	VEHICLE MODEL MATRIX	3 - FUNCTIONAL	
PROOF OF INSURANCE SHOWN (<input checked="" type="checkbox"/>)	INSURANCE COMPANY GEICO	POLICY NUMBER 4334900695	4 - DISABLING	
CARRIER NAME, ADDRESS, CITY, STATE, ZIP			9 - UNKNOWN	CARRIER PHONE - INCLUDE AREA CODE

US DOT	VEHICLE WEIGHT GVWR/GCWR 11 1 - LESS THAN OR EQUAL TO 10K LBS. 2 - 10,001 TO 26,000 LBS. 3 - MORE THAN 26,000 LBS.	CARGO BODY TYPE 01 01 - NO CARGO BODY TYPE/NOT APPLICABLE 02 - BUS (9-15 SEATS, INC DRIVER) 03 - BUS (16+ SEATS, INC DRIVER) 04 - VEHICLE TOWING ANOTHER VEHICLE 05 - LOGGING 06 - INTERMODAL CONTAINER CHASSIS 07 - CARGO VAN/ENCLOSED BOX 08 - GRAIN, CHIPS, GRAVEL	09 - POLE 10 - CARGO TANK 11 - FLAT BED 12 - DUMP 13 - CONCRETE MIXER 14 - AUTO TRANSPORTER 15 - GARBAGE/REFUSE 99 - OTHER/UNKNOWN	TRAFFICWAY DESCRIPTION 1 1 - TWO-WAY, NOT DIVIDED 2 - TWO-WAY, NOT DIVIDED, CONTINUOUS LEFT TURN LANE 3 - TWO-WAY, DIVIDED, UNPROTECTED (PAINTED OR GRASS >4 FT.) MEDIAN 4 - TWO-WAY, DIVIDED, POSITIVE MEDIAN BARRIER 5 - ONE-WAY TRAFFICWAY
HM PLACARD ID NO.	<input type="checkbox"/> HAZARDOUS MATERIAL RELEASED	<input type="checkbox"/> HIT / SKIP UNIT		

NON-MOTORIST LOCATION PRIOR TO IMPACT 01 01 - INTERSECTION - MARKED CROSSWALK 02 - INTERSECTION - NO CROSSWALK 03 - INTERSECTION - OTHER 04 - MIDDLEBLOCK - MARKED CROSSWALK 05 - TRAVEL LANE - OTHER LOCATION 06 - BICYCLE LANE 07 - SHOULDER/ROADSIDE 08 - SIDEWALK 09 - MEDIAN/CROSSING ISLAND 10 - DRIVEWAY ACCESS 11 - SHARED-USE PATH OR TRAIL 12 - NON-TRAFFICWAY AREA 99 - OTHER/UNKNOWN	TYPE OF USE 01 1 - PERSONAL 2 - COMMERCIAL 3 - GOVERNMENT <input type="checkbox"/> IN EMERGENCY RESPONSE	UNIT TYPE 02 99 - UNKNOWN OR HIT / SKIP	PASSENGER VEHICLES (LESS THAN 9 PASSENGERS) 01 - SUB-COMPACT 02 - COMPACT 03 - MID SIZE 04 - FULL SIZE 05 - MINIVAN 06 - SPORT UTILITY VEHICLE 07 - PICKUP 08 - VAN 09 - MOTORCYCLE 10 - MOTORIZED BICYCLE 11 - SNOWMOBILE/ATV 12 - OTHER PASSENGER VEHICLE	MED/HEAVY TRUCKS OR COMBO UNITS > 10K LBS 13 - SINGLE UNIT TRUCK OR VAN 2AXLE, 6 TIRES 14 - SINGLE UNIT TRUCK; 3+ AXLES 15 - SINGLE UNIT TRUCK / TRAILER 16 - TRUCK/TRACTOR (BOBTAIL) 17 - TRACTOR/SEMI-TRAILER 18 - TRACTOR/DOUBLE 19 - TRACTOR/TRIPLES 20 - OTHER MED/HEAVY VEHICLE	BUS/VAN/LIMO (9 OR MORE INCLUDING DRIVER) 21 - BUS/VAN (9-15 SEATS, INC DRIVER) 22 - BUS (16+ SEATS, INC DRIVER) NON-MOTORIST 23 - ANIMAL WITH RIDER 24 - ANIMAL WITH BUGGY, WAGON, SURREY 25 - BICYCLE/PEDALCYCLIST 26 - PEDESTRIAN/SKATER 27 - OTHER NON-MOTORIST
<input type="checkbox"/> HAS HM PLACARD					

SPECIAL FUNCTION 01 01 - NONE 02 - TAXI 03 - RENTAL TRUCK (OVER 10K LBS) 04 - BUS - SCHOOL (PUBLIC OR PRIVATE) 05 - BUS - TRANSIT 06 - BUS - CHARTER 07 - BUS - SHUTTLE 08 - BUS - OTHER	09 - AMBULANCE 10 - FIRE 11 - HIGHWAY/MAINTENANCE 12 - MILITARY 13 - POLICE 14 - PUBLIC UTILITY 15 - OTHER GOVERNMENT 16 - CONSTRUCTION EQUIP.	17 - FARM VEHICLE 18 - FARM EQUIPMENT 19 - MOTORHOME 20 - GOLF CART 21 - TRAIN 22 - OTHER (EXPLAIN IN NARRATIVE)	MOST DAMAGED AREA 06 01 - NONE 02 - CENTER FRONT 03 - RIGHT FRONT 04 - RIGHT SIDE 05 - RIGHT REAR 06 - REAR CENTER 07 - LEFT REAR	08 - LEFT SIDE 09 - LEFT FRONT 10 - TOP AND WINDOWS 11 - UNDERCARRIAGE 12 - LOAD/TRAILER 13 - TOTAL(ALL AREAS) 14 - OTHER	99 - UNKNOWN	ACTION 4 1 - NON-CONTACT 2 - NON-COLLISION 3 - STRIKING 4 - STRUCK 5 - STRIKING/STRUCK 9 - UNKNOWN
--	---	---	--	---	--------------	--

PRE-CRASH ACTIONS 11 99 - UNKNOWN	MOTORIST 01 - STRAIGHT AHEAD 02 - BACKING 03 - CHANGING LANES 04 - OVERTAKING/PASSING 05 - MAKING RIGHT TURN 06 - MAKING LEFT TURN	07 - MAKING U-TURN 08 - ENTERING TRAFFIC LANE 09 - LEAVING TRAFFIC LANE 10 - PARKED 11 - SLOWING OR STOPPED IN TRAFFIC 12 - DRIVERLESS	13 - NEGOTIATING A CURVE 14 - OTHER MOTORIST ACTION	NON-MOTORIST 15 - ENTERING OR CROSSING SPECIFIED LOCATION 16 - WALKING, RUNNING, JOGGING, PLAYING, CYCLING 17 - WORKING 18 - PUSHING VEHICLE 19 - APPROACHING OR LEAVING VEHICLE 20 - STANDING	21 - OTHER NON-MOTORIST ACTION
--	--	---	--	--	--------------------------------

CONTRIBUTING CIRCUMSTANCES PRIMARY 01 SECONDARY 01 99 - UNKNOWN	MOTORIST 01 - NONE 02 - FAILURE TO YIELD 03 - RAN RED LIGHT 04 - RAN STOP SIGN 05 - EXCEEDED SPEED LIMIT 06 - UNSAFE SPEED 07 - IMPROPER TURN 08 - LEFT OF CENTER 09 - FOLLOWED TOO CLOSELY/ACDA 10 - IMPROPER LANE CHANGE /PASSING/OFF ROAD	11 - IMPROPER BACKING 12 - IMPROPER START FROM PARKED POSITION 13 - STOPPED OR PARKED ILLEGALLY 14 - OPERATING VEHICLE IN NEGLIGENT MANNER 15 - SWERVING TO AVOID (DUE TO EXTERNAL CONDITIONS) 16 - WRONG SIDE/WRONG WAY 17 - FAILURE TO CONTROL 18 - VISION OBSTRUCTION 19 - OPERATING DEFECTIVE EQUIPMENT 20 - LOAD SHIFTING/FALLING/SPILLING 21 - OTHER IMPROPER ACTION	NON-MOTORIST 22 - NONE 23 - IMPROPER CROSSING 24 - DARTING 25 - LYING AND/OR ILLEGALLY IN ROADWAY 26 - FAILURE TO YIELD RIGHT OF WAY 27 - NOT VISIBLE (DARK CLOTHING) 28 - INATTENTIVE 29 - FAILURE TO OBEY TRAFFIC SIGNS /SIGNALS/OFFICER 30 - WRONG SIDE OF THE ROAD 31 - OTHER NON-MOTORIST ACTION	VEHICLE DEFECTS 01 01 - TURN SIGNALS 02 - HEAD LAMPS 03 - TAIL LAMPS 04 - BRAKES 05 - STEERING 06 - TIRE BLOWOUT 07 - WORN OR SLICK TIRES 08 - TRAILER EQUIPMENT DEFECTIVE 09 - MOTOR TROUBLE 10 - DISABLED FROM PRIOR ACCIDENT 11 - OTHER DEFECTS
--	--	--	---	---

SEQUENCE OF EVENTS 1 20 2 01 3 01 4 01 5 01 6 01 FIRST HARMFUL EVENT 01 MOST HARMFUL EVENT 01 99 - UNKNOWN	NON-COLLISION EVENTS 01 - OVERTURN/ROLLOVER 02 - FIRE/EXPLOSION 03 - IMMERSION 04 - JACKKNIFE 05 - CARGO/EQUIPMENT LOSS OR SHIFT 06 - EQUIPMENT FAILURE (BLOWN TIRE, BRAKE FAILURE, ETC) 07 - SEPARATION OF UNITS 08 - RAN OFF ROAD RIGHT 09 - RAN OFF ROAD LEFT 10 - CROSS MEDIAN OR SUPPORT 11 - CROSS CENTER LINE OPPOSITE DIRECTION OF TRAVEL 12 - DOWNHILL RUNAWAY 13 - OTHER NON-COLLISION	COLLISION WITH PERSON, VEHICLE OR OBJECT NOT FIXED 14 - PEDESTRIAN 15 - PEDALCYCLE 16 - RAILWAY VEHICLE (TRAIN, ENGINE) 17 - ANIMAL - FARM 18 - ANIMAL - DEER 19 - ANIMAL - OTHER 20 - MOTOR VEHICLE IN TRANSPORT 21 - PARKED MOTOR VEHICLE 22 - WORK ZONE MAINTENANCE EQUIPMENT 23 - STRUCK BY FALLING, SHIFTING CARGO OR ANYTHING SET IN MOTION BY A MOTOR VEHICLE 24 - OTHER MOVABLE OBJECT 25 - IMPACT ATTENUATOR/CRASH CUSHION 26 - BRIDGE OVERHEAD STRUCTURE 27 - BRIDGE PIER OR ABUTMENT 28 - BRIDGE PARAPET 29 - BRIDGE RAIL 30 - GUARDRAIL FACE 31 - GUARDRAIL END 32 - PORTABLE BARRIER 33 - MEDIAN CABLE BARRIER 34 - MEDIAN GUARDRAIL BARRIER 35 - MEDIAN CONCRETE BARRIER 36 - MEDIAN OTHER BARRIER 37 - TRAFFIC SIGN POST 38 - OVERHEAD SIGN POST 39 - LIGHT/LUMINARIES SUPPORT 40 - UTILITY POLE 41 - OTHER POST, POLE OR SUPPORT 42 - CULVERT 43 - CURB 44 - DITCH 45 - EMBANKMENT 46 - FENCE 47 - MAILBOX 48 - TREE 49 - FIRE HYDRANT 50 - WORK ZONE MAINTENANCE EQUIPMENT 51 - WALL, BUILDING, TUNNEL 52 - OTHER FIXED OBJECT
---	---	--

UNIT SPEED 0 <input checked="" type="checkbox"/> STATED <input type="checkbox"/> ESTIMATED	POSTED SPEED 35	TRAFFIC CONTROL 12 01 - NO CONTROLS 02 - STOP SIGN 03 - YIELD SIGN 04 - TRAFFIC SIGNAL 05 - TRAFFIC FLASHERS 06 - SCHOOL ZONE 07 - RAILROAD CROSSBUCKS 08 - RAILROAD FLASHERS 09 - RAILROAD GATES 10 - CONSTRUCTION BARRICADE 11 - PERSON (FLAGGER, OFFICER) 12 - PAVEMENT MARKINGS 13 - CROSSWALK LINES 14 - WALK/DON'T WALK 15 - OTHER 16 - NOT REPORTED	UNIT DIRECTION FROM 3 TO 4 1 - NORTH 2 - SOUTH 3 - EAST 4 - WEST 5 - NORTHEAST 6 - NORTHWEST 7 - SOUTHEAST 8 - SOUTHWEST 9 - UNKNOWN
--	---------------------------	--	--

LOCAL REPORT NUMBER

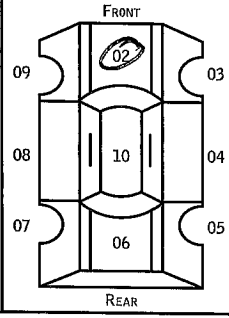
UNIT NUMBER 02	OWNER NAME: LAST, FIRST, MIDDLE (SAME AS DRIVER)	OWNER PHONE NUMBER - INC. AREA CODE (SAME AS DRIVER)	DAMAGE SCALE 2	DAMAGED AREA 
OWNER ADDRESS: CITY, STATE, ZIP (SAME AS DRIVER)				
LP STATE OH	LICENSE PLATE NUMBER GLM 1181	VEHICLE IDENTIFICATION NUMBER 19XFB2K50FE029839	# OCCUPANTS 2	
VEHICLE YEAR 2015	VEHICLE MAKE HONDA	VEHICLE MODEL CIVIC	VEHICLE COLOR SL	
PROOF OF INSURANCE SHOWN <input checked="" type="checkbox"/>	INSURANCE COMPANY CENTRAL MUT.	POLICY NUMBER 3961033	TOWED BY	
CARRIER NAME, ADDRESS, CITY, STATE, ZIP				CARRIER PHONE- INCLUDE AREA CODE

US DOT	VEHICLE WEIGHT GVWR/GCWR 1 1 - LESS THAN OR EQUAL TO 10K LBS. 2 - 10,001 TO 26,000 LBS. 3 - MORE THAN 26,000 LBS.	CARGO BODY TYPE 01 01 - NO CARGO BODY TYPE/NOT APPLICABLE 02 - BUS/VAN (9-15 SEATS, INC DRIVER) 03 - BUS (16+ SEATS, INC DRIVER) 04 - VEHICLE TOWING ANOTHER VEHICLE 05 - LOGGING 06 - INTERMODAL CONTAINER CHASSIS 07 - CARGO VAN/ENCLOSED BOX 08 - GRAIN, CHIPS, GRAVEL 09 - POLE 10 - CARGO TANK 11 - FLAT BED 12 - DUMP 13 - CONCRETE MIXER 14 - AUTO TRANSPORTER 15 - GARBAGE/REFUSE 99 - OTHER/UNKNOWN	TRAFFICWAY DESCRIPTION 1 1 - TWO-WAY, NOT DIVIDED 2 - TWO-WAY, NOT DIVIDED, CONTINUOUS LEFT TURN LANE 3 - TWO-WAY, DIVIDED, UNPROTECTED (PAINTED OR GRASS > 4 FT.) MEDIAN 4 - TWO-WAY, DIVIDED, POSITIVE MEDIAN BARRIER 5 - ONE-WAY TRAFFICWAY	
HM PLACARD ID No.	<input type="checkbox"/> HAZARDOUS MATERIAL RELEASED	<input type="checkbox"/> HIT / SKIP UNIT		

NON-MOTORIST LOCATION PRIOR TO IMPACT 01 01 - INTERSECTION - MARKED CROSSWALK 02 - INTERSECTION - NO CROSSWALK 03 - INTERSECTION - OTHER 04 - MIDLOCK - MARKED CROSSWALK 05 - TRAVEL LANE - OTHER LOCATION 06 - BICYCLE LANE 07 - SHOULDER/ROADSIDE 08 - SIDEWALK 09 - MEDIAN/CROSSING ISLAND 10 - DRIVEWAY ACCESS 11 - SHARED-USE PATH OR TRAIL 12 - NON-TRAFFICWAY AREA 99 - OTHER/UNKNOWN	TYPE OF USE 1 1 - PERSONAL 2 - COMMERCIAL 3 - GOVERNMENT <input type="checkbox"/> IN EMERGENCY RESPONSE	UNIT TYPE 02 99 - UNKNOWN OR HIT / SKIP	PASSENGER VEHICLES (LESS THAN 9 PASSENGERS) 01 - SUB-COMPACT 02 - COMPACT 03 - MID SIZE 04 - FULL SIZE 05 - MINIVAN 06 - SPORT UTILITY VEHICLE 07 - PICKUP 08 - VAN 09 - MOTORCYCLE 10 - MOTORIZED BICYCLE 11 - SNOWMOBILE/ATV 12 - OTHER PASSENGER VEHICLE	MED/HEAVY TRUCKS OR COMBO UNITS > 10K LBS 13 - SINGLE UNIT TRUCK OR VAN 2AXLE, 6 TIRES 14 - SINGLE UNIT TRUCK; 3+ AXLES 15 - SINGLE UNIT TRUCK / TRAILER 16 - TRUCK/TRACTOR (BOBTAIL) 17 - TRACTOR/SEMI-TRAILER 18 - TRACTOR/DOUBLE 19 - TRACTOR/TRIPLES 20 - OTHER MED/HEAVY VEHICLE	BUS/VAN/LIMO (9 OR MORE INCLUDING DRIVER) 21 - BUS/VAN (9-15 SEATS, INC DRIVER) 22 - BUS (16+ SEATS, INC DRIVER) NON-MOTORIST 23 - ANIMAL WITH RIDER 24 - ANIMAL WITH BUGGY, WAGON, SURREY 25 - BICYCLE/PEDALCYCLIST 26 - PEDESTRIAN/SKATER 27 - OTHER NON-MOTORIST
			<input type="checkbox"/> HAS HM PLACARD		

SPECIAL FUNCTION 01 01 - NONE 02 - TAXI 03 - RENTAL TRUCK (OVER 10K LBS) 04 - BUS - SCHOOL (PUBLIC OR PRIVATE) 05 - BUS - TRANSIT 06 - BUS - CHARTER 07 - BUS - SHUTTLE 08 - BUS - OTHER	09 - AMBULANCE 10 - FIRE 11 - HIGHWAY/MAINTENANCE 12 - MILITARY 13 - POLICE 14 - PUBLIC UTILITY 15 - OTHER GOVERNMENT 16 - CONSTRUCTION EQUIP.	17 - FARM VEHICLE 18 - FARM EQUIPMENT 19 - MOTORHOME 20 - GOLF CART 21 - TRAIN 22 - OTHER (EXPLAIN IN NARRATIVE)	MOST DAMAGED AREA 02 01 - NONE 02 - CENTER FRONT 03 - RIGHT FRONT 04 - RIGHT SIDE 05 - RIGHT REAR 06 - REAR CENTER 07 - LEFT REAR	08 - LEFT SIDE 09 - LEFT FRONT 10 - TOP AND WINDOWS 11 - UNDERCARRIAGE 12 - LOAD/TRAILER 13 - TOTAL(ALL AREAS) 14 - OTHER	ACTION 3 1 - NON-CONTACT 2 - NON-COLLISION 3 - STRIKING 4 - STRUCK 5 - STRIKING/STRUCK 9 - UNKNOWN
--	---	---	--	---	--

PRE-CRASH ACTIONS 01 99 - UNKNOWN	MOTORIST 01 - STRAIGHT AHEAD 02 - BACKING 03 - CHANGING LANES 04 - OVERTAKING/PASSING 05 - MAKING RIGHT TURN 06 - MAKING LEFT TURN 07 - MAKING U-TURN 08 - ENTERING TRAFFIC LANE 09 - LEAVING TRAFFIC LANE 10 - PARKED 11 - SLOWING OR STOPPED IN TRAFFIC 12 - DRIVERLESS	13 - NEGOTIATING A CURVE 14 - OTHER MOTORIST ACTION	NON-MOTORIST 15 - ENTERING OR CROSSING SPECIFIED LOCATION 16 - WALKING, RUNNING, JOGGING, PLAYING, CYCLING 17 - WORKING 18 - PUSHING VEHICLE 19 - APPROACHING OR LEAVING VEHICLE 20 - STANDING	21 - OTHER NON-MOTORIST ACTION
--	---	--	--	--------------------------------

CONTRIBUTING CIRCUMSTANCES PRIMARY 09 SECONDARY 09 99 - UNKNOWN	MOTORIST 01 - NONE 02 - FAILURE TO YIELD 03 - RAN RED LIGHT 04 - RAN STOP SIGN 05 - EXCEEDED SPEED LIMIT 06 - UNSAFE SPEED 07 - IMPROPER TURN 08 - LEFT OF CENTER 09 - FOLLOWED TOO CLOSELY/ACDA 10 - IMPROPER LANE CHANGE /PASSING/OFF ROAD 11 - IMPROPER BACKING 12 - IMPROPER START FROM PARKED POSITION 13 - STOPPED OR PARKED ILLEGALLY 14 - OPERATING VEHICLE IN NEGLIGENT MANNER 15 - SWERVING TO AVOID (DUE TO EXTERNAL CONDITIONS) 16 - WRONG SIDE/WRONG WAY 17 - FAILURE TO CONTROL 18 - VISION OBSTRUCTION 19 - OPERATING DEFECTIVE EQUIPMENT 20 - LOAD SHIFTING/FALLING/SPILLING 21 - OTHER IMPROPER ACTION	NON-MOTORIST 22 - NONE 23 - IMPROPER CROSSING 24 - DARTING 25 - LYING AND/OR ILLEGALLY IN ROADWAY 26 - FAILURE TO YIELD RIGHT OF WAY 27 - NOT VISIBLE (DARK CLOTHING) 28 - INATTENTIVE 29 - FAILURE TO OBEY TRAFFIC SIGNS /SIGNALS/OFFICER 30 - WRONG SIDE OF THE ROAD 31 - OTHER NON-MOTORIST ACTION	VEHICLE DEFECTS 01 01 - TURN SIGNALS 02 - HEAD LAMPS 03 - TAIL LAMPS 04 - BRAKES 05 - STEERING 06 - TIRE BLOWOUT 07 - WORN OR SLICK TIRES 08 - TRAILER EQUIPMENT DEFECTIVE 09 - MOTOR TROUBLE 10 - DISABLED FROM PRIOR ACCIDENT 11 - OTHER DEFECTS
--	--	---	---

SEQUENCE OF EVENTS 1 20 2 01 3 01 4 01 5 01 6 01 FIRST HARMFUL EVENT 1 MOST HARMFUL EVENT 1 99 - UNKNOWN	NON-COLLISION EVENTS 01 - OVERTURN/ROLLOVER 02 - FIRE/EXPLOSION 03 - IMMERSION 04 - JACKKNIFE 05 - CARGO/EQUIPMENT LOSS OR SHIFT 06 - EQUIPMENT FAILURE (BLOWN TIRE, BRAKE FAILURE, ETC) 07 - SEPARATION OF UNITS 08 - RAN OFF ROAD RIGHT 09 - RAN OFF ROAD LEFT 10 - CROSS MEDIAN OR SUPPORT 11 - CROSS CENTER LINE OPPOSITE DIRECTION OF TRAVEL 12 - DOWNHILL RUNAWAY 13 - OTHER NON-COLLISION	COLLISION WITH FIXED OBJECT 25 - IMPACT ATTENUATOR/CRASH CUSHION 26 - BRIDGE OVERHEAD STRUCTURE 27 - BRIDGE PIER OR ABUTMENT 28 - BRIDGE PARAPET 29 - BRIDGE RAIL 30 - GUARDRAIL FACE 31 - GUARDRAIL END 32 - PORTABLE BARRIER 33 - MEDIAN CABLE BARRIER 34 - MEDIAN GUARDRAIL BARRIER 35 - MEDIAN CONCRETE BARRIER 36 - MEDIAN OTHER BARRIER 37 - TRAFFIC SIGN POST 38 - OVERHEAD SIGN POST 39 - LIGHT/LUMINARIES SUPPORT 40 - UTILITY POLE 41 - OTHER POST, POLE OR SUPPORT 42 - CULVERT 43 - CURB 44 - DITCH 45 - EMBANKMENT 46 - FENCE 47 - MAILBOX 48 - TREE 49 - FIRE HYDRANT 50 - WORK ZONE MAINTENANCE EQUIPMENT 51 - WALL, BUILDING, TUNNEL 52 - OTHER FIXED OBJECT
---	---	--

UNIT SPEED 5 <input checked="" type="checkbox"/> STATED <input type="checkbox"/> ESTIMATED	POSTED SPEED 35	TRAFFIC CONTROL 12 01 - NO CONTROLS 02 - STOP SIGN 03 - YIELD SIGN 04 - TRAFFIC SIGNAL 05 - TRAFFIC FLASHERS 06 - SCHOOL ZONE 07 - RAILROAD CROSSBUCKS 08 - RAILROAD FLASHERS 09 - RAILROAD GATES 10 - CONSTRUCTION BARRICADE 11 - PERSON (FLAGGER, OFFICER) 12 - PAVEMENT MARKINGS 13 - CROSSWALK LINES 14 - WALK/DON'T WALK 15 - OTHER 16 - NOT REPORTED	UNIT DIRECTION FROM 3 TO 4 1 - NORTH 2 - SOUTH 3 - EAST 4 - WEST 5 - NORTHEAST 6 - NORTHWEST 7 - SOUTHEAST 8 - SOUTHWEST 9 - UNKNOWN
--	---------------------------	--	--



LOCAL REPORT NUMBER	REPORTING AGENCY MASON POLICE	DATE OF CRASH M 09 10 2016
IN COUNTY OF WARREN	CRASH LOCATION KINGS MILLS RD / COX-SMITH	

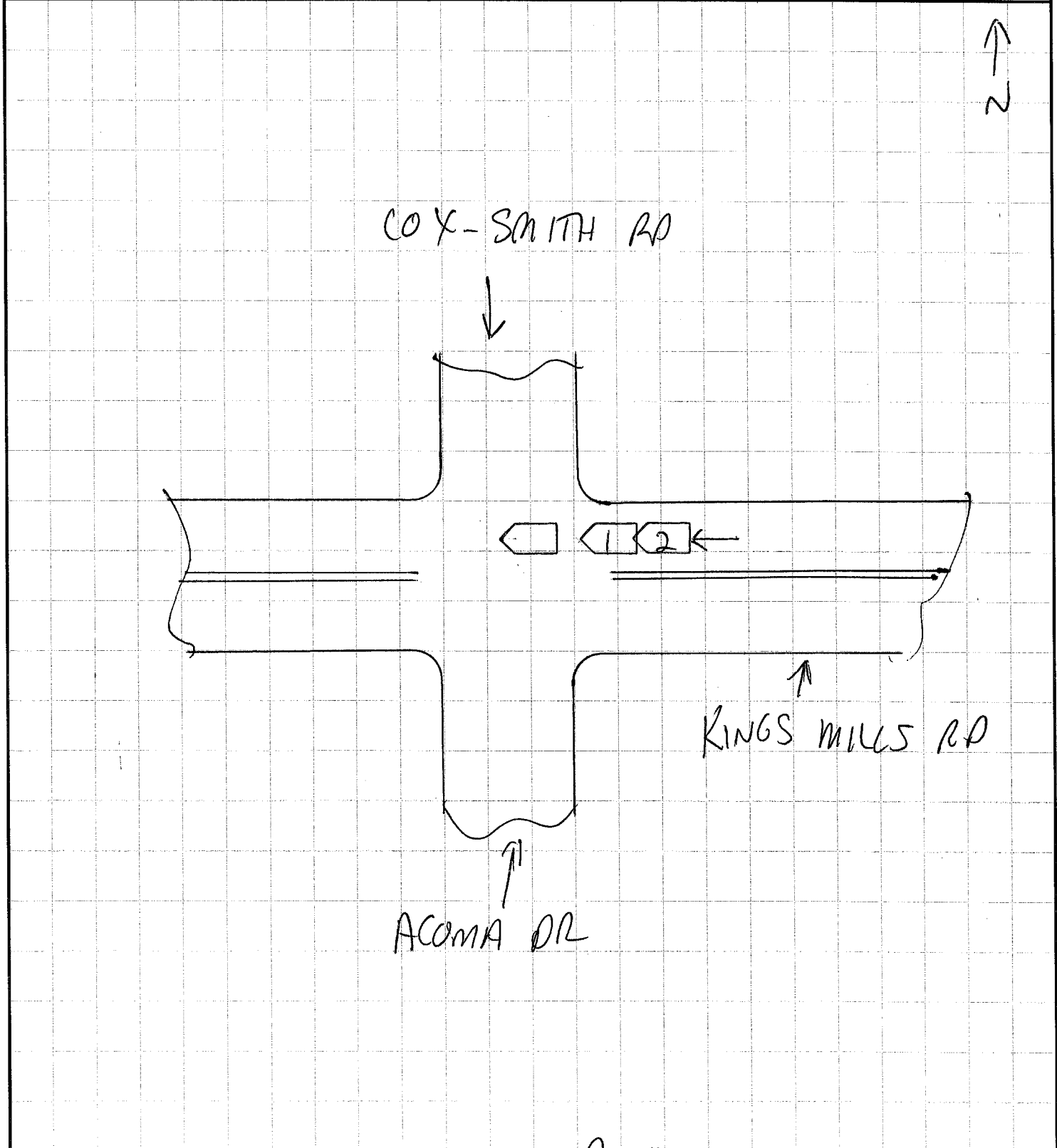

NOT TO SCALE	OFFICER'S SIGNATURE X PD KSP	BADGE NUMBER 65
--------------	---------------------------------	--------------------

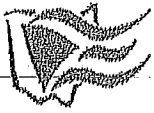

LOCAL REPORT NUMBER	REPORTING AGENCY MASON POLICE	DATE OF CRASH M 9 10 20 12 2016
---------------------	---	------------------------------------

FOR LOCAL USE ONLY -- DO NOT SUBMIT TO THE STATE EXCEPT FOR FATAL CRASHES

I, Grisse Elias HEREBY MAKE THIS VOLUNTARY STATEMENT TO
PRINTED

P.O. K. S. BRYANT AT Kings Mills / Cox-Smith Rd
OFFICER'S NAME LOCATION

Noticed the car in front of me stop suddenly which made me slam my breaks. Ended up hitting the vehicle in front of me.

Q. WERE YOU, OR ANYONE IN YOUR VEHICLE INJURED? NO

Q. WERE YOU WEARING YOUR SEAT BELT? yes

Q. WHAT DIRECTION WERE YOU GOING? towards Mason downtown

Q. WHAT WAS YOUR SPEED? 30 AT IMPACT? LESS THAN 5

Q. WERE YOU USING A CELL PHONE AT THE TIME OF THE CRASH? NO

ADDRESS OF WITNESS
6284 Huckleberry Ln

SIGNATURE OF WITNESS
X [Signature]

OFFICER'S SIGNATURE
X [Signature]

PHONE
(513) 540-5572



LOCAL REPORT NUMBER	REPORTING AGENCY MASON POLICE	DATE OF CRASH 09/20/16
---------------------	---	----------------------------------

FOR LOCAL USE ONLY - DO NOT SUBMIT TO THE STATE EXCEPT FOR FATAL CRASHES

I, KYLE HENRY HEREBY MAKE THIS VOLUNTARY STATEMENT TO
PRINTED

P.O. K. S. BRYANT AT Mason
OFFICER'S NAME LOCATION

I was driving down Kings Mills Rd, white truck/SUV was in front of me, white truck slammed on his brakes in the middle of the intersection to turn left. I slammed on my brakes, and then the car behind me hit me from behind.

Q. WERE YOU, OR ANYONE IN YOUR VEHICLE INJURED? **NO**

Q. WERE YOU WEARING YOUR SEAT BELT? **YES**

Q. WHAT DIRECTION WERE YOU GOING? **WEST**

Q. WHAT WAS YOUR SPEED? **ALMOST STOPPED**

Q. WERE YOU USING A CELL PHONE AT THE TIME OF THE CRASH? **NO**

ADDRESS OF WITNESS

SIGNATURE OF WITNESS **X**

OFFICER'S SIGNATURE **X P.O. K.S. BRYANT**

PHONE **513-698-9264**