



TRAFFIC CRASH REPORT

LOCAL REPORT NUMBER *	CRASH SEVERITY	HIT/SKIP
2015 32624	3 1 - FATAL 2 - INJURY 3 - PDO	<input type="checkbox"/> 1 - SOLVED <input type="checkbox"/> 2 - UNSOLVED

LOCAL INFORMATION

<input checked="" type="checkbox"/> PHOTOS TAKEN <input type="checkbox"/> OH-2 <input type="checkbox"/> OH-1P <input checked="" type="checkbox"/> OH-3 <input type="checkbox"/> OTHER	<input type="checkbox"/> PDO UNDER STATE REPORTABLE DOLLAR AMOUNT	<input type="checkbox"/> PRIVATE PROPERTY	REPORTING AGENCY NCIC *	REPORTING AGENCY NAME *	NUMBER OF UNITS	UNIT IN ERROR
			08304	MASON POLICE	02	02 98 - ANIMAL 99 - UNKNOWN

COUNTY *	CITY *	CITY, VILLAGE, TOWNSHIP *	CRASH DATE *	TIME OF CRASH	DAY OF WEEK
83	MASON	MASON	10/15/2015	1202	THU

DEGREES / MINUTES / SECONDS	LONGITUDE	DECIMAL DEGREES	LONGITUDE
39° 20' 17.24"	-84° 29' 39.56"	39.338122	-84.341831

ROADWAY DIVISION	DIVIDED LANE DIRECTION OF TRAVEL	NUMBER OF THRU LANES	ROAD TYPES OR MILEPOST ²
<input checked="" type="checkbox"/> DIVIDED <input type="checkbox"/> UNDIVIDED	<input type="checkbox"/> N - NORTHBOUND E - EASTBOUND <input type="checkbox"/> S - SOUTHBOUND W - WESTBOUND	04	AL - ALLEY CR - CIRCLE HE - HEIGHTS MP - MILEPOST PL - PLACE ST - STREET WA - WAY AV - AVENUE CT - COURT HW - HIGHWAY PK - PARKWAY RD - ROAD TE - TERRACE BL - BOULEVARD DR - DRIVE LA - LANE PI - PIKE SQ - SQUARE TL - TRAIL

LOCATION ROUTE TYPE 1	LOCATION ROUTE NUMBER	LOC PREFIX N,S,E,W	LOCATION ROAD NAME	LOCATION ROAD TYPE 2	ROUTE TYPES ¹
			READING	R0	IR - INTERSTATE ROUTE (INC. TURNPIKE) CR - NUMBERED COUNTY ROUTE US - US ROUTE TR - NUMBERED TOWNSHIP ROUTE SR - STATE ROUTE

DISTANCE FROM REFERENCE	DIR FROM REF	REFERENCE ROUTE TYPE 1	REFERENCE ROUTE NUMBER	REF PREFIX N,S,E,W	REFERENCE NAME (ROAD, MILEPOST, HOUSE #)	REFERENCE ROAD TYPE 2
500	M				WESTERN ROW	R0

REFERENCE POINT USED	CRASH LOCATION	INTERSECTION RELATED	LOCATION OF FIRST HARMFUL EVENT
1 - INTERSECTION 2 - MILE POST 3 - HOUSE NUMBER	01 - NOT AN INTERSECTION 02 - FOUR-WAY INTERSECTION 03 - T-INTERSECTION 04 - Y-INTERSECTION 05 - TRAFFIC CIRCLE/ROUNDBOUNT 06 - FIVE-POINT, OR MORE 07 - ON RAMP 08 - OFF RAMP 09 - CROSSOVER 10 - DRIVEWAY/ALLEY ACCESS 11 - RAILWAY GRADE CROSSING 12 - SHARED-USE PATHS OR TRAILS 99 - UNKNOWN	<input type="checkbox"/>	1 - ON ROADWAY 5 - ON GORE 2 - ON SHOULDER 6 - OUTSIDE TRAFFICWAY 3 - IN MEDIAN 9 - UNKNOWN 4 - ON ROADSIDE

ROAD CONTOUR	ROAD CONDITIONS	WEATHER
1 - STRAIGHT LEVEL 2 - STRAIGHT GRADE 3 - CURVE LEVEL 4 - CURVE GRADE 9 - UNKNOWN	PRIMARY 01 - DRY 02 - WET 03 - SNOW 04 - ICE SECONDARY 05 - SAND, MUD, DIRT, OIL, GRAVEL 06 - WATER (STANDING, MOVING) 07 - SLUSH 08 - DEBRIS*	1 - CLEAR 2 - CLOUDY 3 - FOG, SMOG, SMOKE 4 - RAIN 5 - SLEET, HAIL 6 - SNOW 7 - SEVERE CROSSWINDS 8 - BLOWING SAND, SOIL, DIRT, SNOW 9 - OTHER/UNKNOWN

MANNER OF CRASH COLLISION/IMPACT	WEATHER
1 - NOT COLLISION BETWEEN TWO MOTOR VEHICLES IN TRANSPORT 2 - REAR-END 3 - HEAD-ON 4 - REAR-TO-REAR 5 - BACKING 6 - ANGLE 7 - SIDESWIPE, SAME DIRECTION 8 - SIDESWIPE, OPPOSITE DIRECTION 9 - UNKNOWN	1 - CLEAR 2 - CLOUDY 3 - FOG, SMOG, SMOKE 4 - RAIN 5 - SLEET, HAIL 6 - SNOW 7 - SEVERE CROSSWINDS 8 - BLOWING SAND, SOIL, DIRT, SNOW 9 - OTHER/UNKNOWN

ROAD SURFACE	LIGHT CONDITIONS	SCHOOL BUS RELATED
1 - CONCRETE 2 - BLACKTOP, BITUMINOUS, ASPHALT 3 - BRICK/BLOCK 4 - SLAG, GRAVEL, STONE 5 - DIRT 6 - OTHER	PRIMARY 1 - DAYLIGHT 2 - DAWN 3 - DUSK 4 - DARK - LIGHTED ROADWAY SECONDARY 5 - DARK - ROADWAY NOT LIGHTED 6 - DARK - UNKNOWN ROADWAY LIGHTING 7 - GLARE* 8 - OTHER	<input type="checkbox"/> SCHOOL ZONE RELATED <input type="checkbox"/> YES, SCHOOL BUS DIRECTLY INVOLVED <input type="checkbox"/> YES, SCHOOL BUS INDIRECTLY INVOLVED

WORK ZONE RELATED	WORKERS PRESENT	TYPE OF WORK ZONE	LOCATION OF CRASH IN WORK ZONE
<input type="checkbox"/>	<input type="checkbox"/> LAW ENFORCEMENT PRESENT (OFFICER/VEHICLE) <input type="checkbox"/> LAW ENFORCEMENT PRESENT (VEHICLE ONLY)	1 - LANE CLOSURE 2 - LANE SHIFT/CROSSOVER 3 - WORK ON SHOULDER OR MEDIAN 4 - INTERMITTENT OR MOVING WORK 5 - OTHER	1 - BEFORE THE FIRST WORK ZONE WARNING SIGN 2 - ADVANCE WARNING AREA 3 - TRANSITION AREA 4 - ACTIVITY AREA 5 - TERMINATION AREA

NARRATIVE

UNIT #1 WAS SOUTH BOUND ON READING RD. UNIT #2 WAS CROSSING READING RD FROM A PRIVATE DRIVE. UNIT #2 FAILED TO YIELD AND WAS STRUCK BY #1

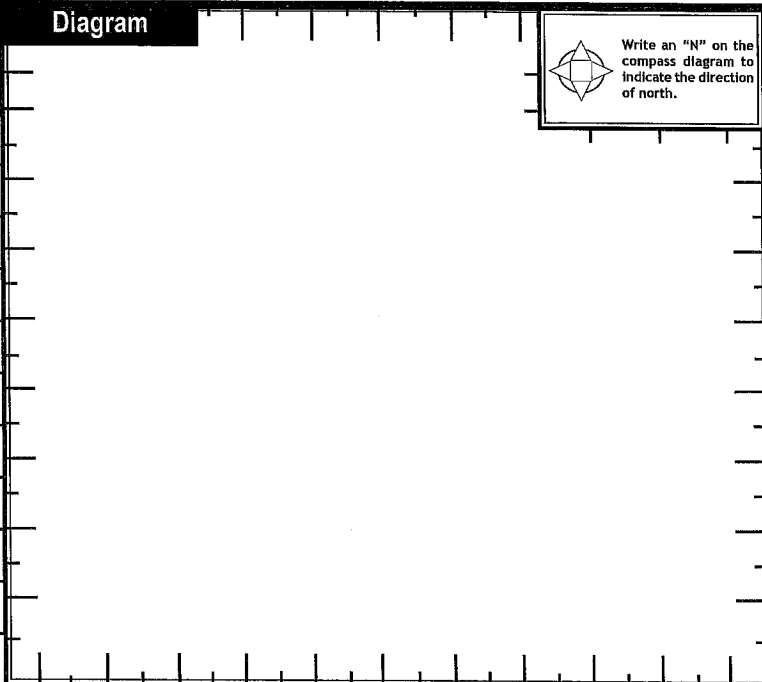

REPORT TAKEN BY	SUPPLEMENT (CORRECTION OR ADDITION TO AN EXISTING REPORT SENT TO DDPS)	DATE CRASH REPORTED	TIME CRASH REPORTED	DISPATCH TIME	ARRIVAL TIME	TIME CLERKED	OTHER INVESTIGATION TIME	TOTAL MINUTES
Police Agency <input checked="" type="checkbox"/> MOTORIST <input type="checkbox"/>		10/15/2015	1206	1207	1208	1251	30	73
OFFICER'S NAME *	OFFICER'S BADGE NUMBER	CHECKED BY	PAGE OF					
BRYANT	55	50						



MOTORIST / NON-MOTORIST / OCCUPANT

LOCAL REPORT NUMBER

MOTORIST/Non-Motorist

UNIT NUMBER 01	NAME: LAST, FIRST, MIDDLE FARRELL, CATHERINE B	DATE OF BIRTH 04.24.1945	AGE 70	GENDER <input checked="" type="checkbox"/> F - FEMALE <input type="checkbox"/> M - MALE
ADDRESS, CITY, STATE, ZIP 1248 ANTHONY LN MASON OHIO 45040			CONTACT PHONE- INCLUDE AREA CODE 513 398 4036	
INJURIES <input type="checkbox"/>	INJURED TAKEN BY <input type="checkbox"/>	EMS AGENCY	MEDICAL FACILITY INJURED TAKEN TO	SAFETY EQUIPMENT USED 04
<input type="checkbox"/>	<input type="checkbox"/>			<input type="checkbox"/> DOT COMPLIANT MOTORCYCLE HELMET
OL STATE OH	OPERATOR LICENSE NUMBER RR525679	OL CLASS 4	<input type="checkbox"/> No VALID OL <input type="checkbox"/> M/C END.	CONDITION <input type="checkbox"/>
<input type="checkbox"/>	<input type="checkbox"/>	<input type="checkbox"/>	<input type="checkbox"/>	<input type="checkbox"/>
ALCOHOL/DRUG SUSPECTED <input type="checkbox"/>	ALCOHOL TEST STATUS <input type="checkbox"/>	ALCOHOL TEST TYPE <input type="checkbox"/>	ALCOHOL TEST VALUE <input type="checkbox"/>	DRUG TEST STATUS <input type="checkbox"/>
<input type="checkbox"/>	<input type="checkbox"/>	<input type="checkbox"/>	<input type="checkbox"/>	<input type="checkbox"/>
OFFENSE CHARGED (<input type="checkbox"/> LOCAL CODE)	OFFENSE DESCRIPTION	CITATION NUMBER		HANDS-FREE <input type="checkbox"/> DEVICE USED
				<input type="checkbox"/>
DRIVER DISTRACTED BY <input type="checkbox"/>				

MOTORIST/Non-Motorist

UNIT NUMBER 02	NAME: LAST, FIRST, MIDDLE KEEORR, ELLA M.	DATE OF BIRTH 06.21.1944	AGE 71	GENDER <input checked="" type="checkbox"/> F - FEMALE <input type="checkbox"/> M - MALE
ADDRESS, CITY, STATE, ZIP 307 E. CIRCLE DR MASON OHIO 45040			CONTACT PHONE- INCLUDE AREA CODE 513 456 3506	
INJURIES <input type="checkbox"/>	INJURED TAKEN BY <input type="checkbox"/>	EMS AGENCY	MEDICAL FACILITY INJURED TAKEN TO	SAFETY EQUIPMENT USED 04
<input type="checkbox"/>	<input type="checkbox"/>			<input type="checkbox"/> DOT COMPLIANT MOTORCYCLE HELMET
OL STATE OH	OPERATOR LICENSE NUMBER RN669652	OL CLASS 4	<input type="checkbox"/> No VALID OL <input type="checkbox"/> M/C END.	CONDITION <input type="checkbox"/>
<input type="checkbox"/>	<input type="checkbox"/>	<input type="checkbox"/>	<input type="checkbox"/>	<input type="checkbox"/>
ALCOHOL/DRUG SUSPECTED <input type="checkbox"/>	ALCOHOL TEST STATUS <input type="checkbox"/>	ALCOHOL TEST TYPE <input type="checkbox"/>	ALCOHOL TEST VALUE <input type="checkbox"/>	DRUG TEST STATUS <input type="checkbox"/>
<input type="checkbox"/>	<input type="checkbox"/>	<input type="checkbox"/>	<input type="checkbox"/>	<input type="checkbox"/>
OFFENSE CHARGED (<input checked="" type="checkbox"/> LOCAL CODE)	OFFENSE DESCRIPTION	CITATION NUMBER		HANDS-FREE <input type="checkbox"/> DEVICE USED
331.22	FAILED TO YIELD	78967		<input type="checkbox"/>
DRIVER DISTRACTED BY <input type="checkbox"/>				

INJURIES	INJURED TAKEN BY	SAFETY EQUIPMENT USED	99 - UNKNOWN SAFETY EQUIPMENT	NON-MOTORIST
1 - NO INJURY / NONE REPORTED 2 - POSSIBLE 3 - NON-INCAPACITATING 4 - INCAPACITATING 5 - FATAL	1 - NOT TRANSPORTED / TREATED AT SCENE 2 - EMS 3 - POLICE 4 - OTHER 9 - UNKNOWN	MOTORIST 01 - NONE USED - VEHICLE OCCUPANT 02 - SHOULDER BELT ONLY USED 03 - LAP BELT ONLY USED 04 - SHOULDER AND LAP BELT USED	05 - CHILD RESTRAINT SYSTEM-FORWARD FACING 06 - CHILD RESTRAINT SYSTEM-REAR FACING 07 - BOOSTER SEAT 08 - HELMET USED	09 - NONE USED 10 - HELMET USED 11 - PROTECTIVE PADS USED (ELBOWS, KNEES, ETC) 12 - REFLECTIVE CLOTHING 13 - LIGHTING 14 - OTHER

SEATING POSITION	AIR BAG USAGE
01 - FRONT - LEFT SIDE (MOTORCYCLE DRIVER) 02 - FRONT - MIDDLE 03 - FRONT - RIGHT SIDE 04 - SECOND - LEFT SIDE (MOTORCYCLE PASSENGER) 05 - SECOND - MIDDLE 06 - SECOND - RIGHT SIDE 07 - THIRD - LEFT SIDE (MOTORCYCLE SIDE CAR) 08 - THIRD - MIDDLE 09 - THIRD - RIGHT SIDE 10 - SLEEPER SECTION OF CAB (TRUCK) 11 - PASSENGER IN OTHER ENCLOSED CARGO AREA (NON-TRAILING UNIT SUCH AS A BUS, PICK-UP WITH CAP) 12 - PASSENGER IN UNENCLOSED CARGO AREA 13 - TRAILING UNIT 14 - RIDING ON VEHICLE EXTERIOR (NON-TRAILING UNIT) 15 - NON-MOTORIST 16 - OTHER 99 - UNKNOWN	1 - NOT DEPLOYED 2 - DEPLOYED FRONT 3 - DEPLOYED SIDE 4 - DEPLOYED BOTH FRONT/SIDE 5 - NOT APPLICABLE 9 - DEPLOYMENT UNKNOWN

EJECTION	TRAPPED	OPERATOR LICENSE CLASS	CONDITION	ALCOHOL/DRUG SUSPECTED
1 - NOT EJECTED 2 - TOTALLY EJECTED 3 - PARTIALLY EJECTED 4 - NOT APPLICABLE	1 - NOT TRAPPED 2 - EXTRICATED BY MECHANICAL MEANS 3 - EXTRICATED BY NON-MECHANICAL MEANS	1 - CLASS A 2 - CLASS B 3 - CLASS C 4 - REGULAR CLASS (OHIO IS "D") 5 - MC/MOPED ONLY	1 - APPARENTLY NORMAL 2 - PHYSICAL IMPAIRMENT 3 - EMOTIONAL (DEPRESSED, ANGRY, DISTURBED) 4 - ILLNESS 5 - FELL ASLEEP, FAINTED, FATIGUED 6 - UNDER THE INFLUENCE OF MEDICATIONS, DRUGS, ALCOHOL 7 - OTHER	1 - NONE 2 - YES - ALCOHOL SUSPECTED 3 - YES - HBD NOT IMPAIRED 4 - YES - DRUGS SUSPECTED 5 - YES - ALCOHOL AND DRUGS SUSPECTED

ALCOHOL TEST STATUS	ALCOHOL TEST TYPE	DRUG TEST STATUS	DRUG TEST TYPE	DRIVER DISTRACTED BY
1 - NONE GIVEN 2 - TEST REFUSED 3 - TEST GIVEN, CONTAMINATED SAMPLE/UNUSABLE 4 - TEST GIVEN, RESULTS KNOWN 5 - TEST GIVEN, RESULTS UNKNOWN	1 - NONE 2 - BLOOD 3 - URINE 4 - BREATH 5 - OTHER	1 - NONE GIVEN 2 - TEST REFUSED 3 - TEST GIVEN, CONTAMINATED SAMPLE/UNUSABLE 4 - TEST GIVEN, RESULTS KNOWN 5 - TEST GIVEN, RESULTS UNKNOWN	1 - NONE 2 - BLOOD 3 - URINE 4 - OTHER	1 - NO DISTRACTION REPORTED 2 - PHONE 3 - TEXTING/E-MAILING 4 - ELECTRONIC COMMUNICATION DEVICE 5 - OTHER ELECTRONIC DEVICE (NAVIGATION DEVICE, RADIO, DVD) 6 - OTHER INSIDE THE VEHICLE 7 - EXTERNAL DISTRACTION

OCCUPANT

UNIT NUMBER <input type="checkbox"/>	NAME: LAST, FIRST, MIDDLE	DATE OF BIRTH	AGE	GENDER <input type="checkbox"/> F - FEMALE <input type="checkbox"/> M - MALE
ADDRESS, CITY, STATE, ZIP			CONTACT PHONE- INCLUDE AREA CODE	
INJURIES <input type="checkbox"/>	INJURED TAKEN BY <input type="checkbox"/>	EMS AGENCY	MEDICAL FACILITY INJURED TAKEN TO	SAFETY EQUIPMENT USED <input type="checkbox"/>
<input type="checkbox"/>	<input type="checkbox"/>			<input type="checkbox"/> DOT COMPLIANT MOTORCYCLE HELMET
OL STATE	OPERATOR LICENSE NUMBER	OL CLASS	<input type="checkbox"/> No VALID OL <input type="checkbox"/> M/C END.	CONDITION
<input type="checkbox"/>	<input type="checkbox"/>	<input type="checkbox"/>	<input type="checkbox"/>	<input type="checkbox"/>
ALCOHOL/DRUG SUSPECTED	ALCOHOL TEST STATUS	ALCOHOL TEST TYPE	ALCOHOL TEST VALUE	DRUG TEST STATUS
<input type="checkbox"/>	<input type="checkbox"/>	<input type="checkbox"/>	<input type="checkbox"/>	<input type="checkbox"/>
OFFENSE CHARGED (<input type="checkbox"/> LOCAL CODE)	OFFENSE DESCRIPTION	CITATION NUMBER		HANDS-FREE <input type="checkbox"/> DEVICE USED
				<input type="checkbox"/>
DRIVER DISTRACTED BY <input type="checkbox"/>				

OCCUPANT

UNIT NUMBER <input type="checkbox"/>	NAME: LAST, FIRST, MIDDLE	DATE OF BIRTH	AGE	GENDER <input type="checkbox"/> F - FEMALE <input type="checkbox"/> M - MALE
ADDRESS, CITY, STATE, ZIP			CONTACT PHONE- INCLUDE AREA CODE	
INJURIES <input type="checkbox"/>	INJURED TAKEN BY <input type="checkbox"/>	EMS AGENCY	MEDICAL FACILITY INJURED TAKEN TO	SAFETY EQUIPMENT USED <input type="checkbox"/>
<input type="checkbox"/>	<input type="checkbox"/>			<input type="checkbox"/> DOT COMPLIANT MOTORCYCLE HELMET
OL STATE	OPERATOR LICENSE NUMBER	OL CLASS	<input type="checkbox"/> No VALID OL <input type="checkbox"/> M/C END.	CONDITION
<input type="checkbox"/>	<input type="checkbox"/>	<input type="checkbox"/>	<input type="checkbox"/>	<input type="checkbox"/>
ALCOHOL/DRUG SUSPECTED	ALCOHOL TEST STATUS	ALCOHOL TEST TYPE	ALCOHOL TEST VALUE	DRUG TEST STATUS
<input type="checkbox"/>	<input type="checkbox"/>	<input type="checkbox"/>	<input type="checkbox"/>	<input type="checkbox"/>
OFFENSE CHARGED (<input type="checkbox"/> LOCAL CODE)	OFFENSE DESCRIPTION	CITATION NUMBER		HANDS-FREE <input type="checkbox"/> DEVICE USED
				<input type="checkbox"/>
DRIVER DISTRACTED BY <input type="checkbox"/>				



UNIT

LOCAL REPORT NUMBER

UNIT NUMBER 01	OWNER NAME: LAST, FIRST, MIDDLE (X) SAME AS DRIVER	OWNER PHONE NUMBER - INC. AREA CODE (X) SAME AS DRIVER	DAMAGE SCALE 3	DAMAGED AREA
OWNER ADDRESS: CITY, STATE, ZIP (X) SAME AS DRIVER			1 - NONE	
LP STATE OH	LICENSE PLATE NUMBER BR 20 UJ	VEHICLE IDENTIFICATION NUMBER 2CNDQ413F186053660	2 - MINOR	
VEHICLE YEAR 2008	VEHICLE MAKE CHEVROLET	VEHICLE MODEL EQUINOX	3 - FUNCTIONAL	
PROOF OF INSURANCE SHOWN (X)	INSURANCE COMPANY STATE FARM	POLICY NUMBER 893689901335	4 - DISABLING	
CARRIER NAME, ADDRESS, CITY, STATE, ZIP			9 - UNKNOWN	
			CARRIER PHONE- INCLUDE AREA CODE	

US DOT	VEHICLE WEIGHT GVWR/GCWR 1 1 - LESS THAN OR EQUAL TO 10K LBS. 2 - 10,001 TO 26,000 LBS. 3 - MORE THAN 26,000 LBS.	CARGO BODY TYPE 01 01 - NO CARGO BODY TYPE/NOT APPLICABLE 02 - BUS/VAN (9-15 SEATS, INC DRIVER) 03 - BUS (16+ SEATS, INC DRIVER) 04 - VEHICLE TOWING ANOTHER VEHICLE 05 - LOGGING 06 - INTERMODAL CONTAINER CHASSIS 07 - CARGO VAN/ENCLOSED BOX 08 - GRAIN, CHIPS, GRAVEL	TRAFFICWAY DESCRIPTION 1 1 - TWO-WAY, NOT DIVIDED 2 - TWO-WAY, NOT DIVIDED, CONTINUOUS LEFT TURN LANE 3 - TWO-WAY, DIVIDED, UNPROTECTED (PAINTED OR GRASS >4 FT.) MEDIAN 4 - TWO-WAY, DIVIDED, POSITIVE MEDIAN BARRIER 5 - ONE-WAY TRAFFICWAY
HM PLACARD ID No.	<input type="checkbox"/> HAZARDOUS MATERIAL RELEASED	09 - POLE 10 - CARGO TANK 11 - FLAT BED 12 - DUMP 13 - CONCRETE MIXER 14 - AUTO TRANSPORTER 15 - GARBAGE/REFUSE 99 - OTHER/UNKNOWN	<input type="checkbox"/> HIT / SKIP UNIT
HM CLASS NUMBER			

NON-MOTORIST LOCATION PRIOR TO IMPACT 01 01 - INTERSECTION - MARKED CROSSWALK 02 - INTERSECTION - NO CROSSWALK 03 - INTERSECTION - OTHER 04 - MIDLBLOCK - MARKED CROSSWALK 05 - TRAVEL LANE - OTHER LOCATION 06 - BICYCLE LANE 07 - SHOULDER/ROADSIDE 08 - SIDEWALK 09 - MEDIAN/CROSSING ISLAND 10 - DRIVEWAY ACCESS 11 - SHARED-USE PATH OR TRAIL 12 - NON-TRAFFICWAY AREA 99 - OTHER/UNKNOWN	TYPE OF USE 1 1 - PERSONAL 2 - COMMERCIAL 3 - GOVERNMENT <input type="checkbox"/> IN EMERGENCY RESPONSE	UNIT TYPE 016 99 - UNKNOWN OR HIT / SKIP	PASSENGER VEHICLES (LESS THAN 9 PASSENGERS) 01 - SUB-COMPACT 02 - COMPACT 03 - MID SIZE 04 - FULL SIZE 05 - MINIVAN 06 - SPORT UTILITY VEHICLE 07 - PICKUP 08 - VAN 09 - MOTORCYCLE 10 - MOTORIZED BICYCLE 11 - SNOWMOBILE/ATV 12 - OTHER PASSENGER VEHICLE	MED/HEAVY TRUCKS OR COMBO UNITS > 10K LBS 13 - SINGLE UNIT TRUCK OR VAN 2AXLE, 6 TIRES 14 - SINGLE UNIT TRUCK; 3+ AXLES 15 - SINGLE UNIT TRUCK / TRAILER 16 - TRUCK/TRACTOR (BOBTAIL) 17 - TRACTOR/SEMI-TRAILER 18 - TRACTOR/DOUBLE 19 - TRACTOR/TRIPLES 20 - OTHER MED/HEAVY VEHICLE	BUS/VAN/LIMO (9 OR MORE INCLUDING DRIVER) 21 - BUS/VAN (9-15 SEATS, INC DRIVER) 22 - BUS (16+ SEATS, INC DRIVER) Non-Motorist 23 - ANIMAL WITH RIDER 24 - ANIMAL WITH BUGGY, WAGON, SURREY 25 - BICYCLE/PEDALCYCLIST 26 - PEDESTRIAN/SKATER 27 - OTHER NON-MOTORIST
<input type="checkbox"/> HAS HM PLACARD					

SPECIAL FUNCTION 01 01 - NONE 02 - TAXI 03 - RENTAL TRUCK (OVER 10K LBS) 04 - BUS - SCHOOL (PUBLIC OR PRIVATE) 05 - BUS - TRANSIT 06 - BUS - CHARTER 07 - BUS - SHUTTLE 08 - BUS - OTHER	09 - AMBULANCE 10 - FIRE 11 - HIGHWAY/MAINTENANCE 12 - MILITARY 13 - POLICE 14 - PUBLIC UTILITY 15 - OTHER GOVERNMENT 16 - CONSTRUCTION EQUIP.	17 - FARM VEHICLE 18 - FARM EQUIPMENT 19 - MOTORHOME 20 - GOLF CART 21 - TRAIN 22 - OTHER (EXPLAIN IN NARRATIVE)	MOST DAMAGED AREA 02 01 - NONE 02 - CENTER FRONT 03 - RIGHT FRONT 04 - RIGHT SIDE 05 - RIGHT REAR 06 - REAR CENTER 07 - LEFT REAR	08 - LEFT SIDE 09 - LEFT FRONT 10 - TOP AND WINDOWS 11 - UNDERCARRIAGE 12 - LOAD/TRAILER 13 - TOTAL(ALL AREAS) 14 - OTHER	ACTION 3 1 - NON-CONTACT 2 - NON-COLLISION 3 - STRIKING 4 - STRUCK 5 - STRIKING/STRUCK 9 - UNKNOWN
--	---	---	--	---	--

PRE-CRASH ACTIONS 01 99 - UNKNOWN	MOTORIST 01 - STRAIGHT AHEAD 02 - BACKING 03 - CHANGING LANES 04 - OVERTAKING/PASSING 05 - MAKING RIGHT TURN 06 - MAKING LEFT TURN	07 - MAKING U-TURN 08 - ENTERING TRAFFIC LANE 09 - LEAVING TRAFFIC LANE 10 - PARKED 11 - SLOWING OR STOPPED IN TRAFFIC 12 - DRIVERLESS	13 - NEGOTIATING A CURVE 14 - OTHER MOTORIST ACTION	NON-MOTORIST 15 - ENTERING OR CROSSING SPECIFIED LOCATION 16 - WALKING, RUNNING, JOGGING, PLAYING, CYCLING 17 - WORKING 18 - PUSHING VEHICLE 19 - APPROACHING OR LEAVING VEHICLE 20 - STANDING 21 - OTHER NON-MOTORIST ACTION
--	--	---	--	--

CONTRIBUTING CIRCUMSTANCES 01 99 - UNKNOWN	MOTORIST 01 - NONE 02 - FAILURE TO YIELD 03 - RAN RED LIGHT 04 - RAN STOP SIGN 05 - EXCEEDED SPEED LIMIT 06 - UNSAFE SPEED 07 - IMPROPER TURN 08 - LEFT OF CENTER 09 - FOLLOWED TOO CLOSELY/ACDA 10 - IMPROPER LANE CHANGE /PASSING/OFF ROAD	11 - IMPROPER BACKING 12 - IMPROPER START FROM PARKED POSITION 13 - STOPPED OR PARKED ILLEGALLY 14 - OPERATING VEHICLE IN NEGLIGENT MANNER 15 - SWERVING TO AVOID (DUE TO EXTERNAL CONDITIONS) 16 - WRONG SIDE/WRONG WAY 17 - FAILURE TO CONTROL 18 - VISION OBSTRUCTION 19 - OPERATING DEFECTIVE EQUIPMENT 20 - LOAD SHIFTING/FALLING/SPILLING 21 - OTHER IMPROPER ACTION	NON-MOTORIST 22 - NONE 23 - IMPROPER CROSSING 24 - DARTING 25 - LYING AND/OR ILLEGALLY IN ROADWAY 26 - FAILURE TO YIELD RIGHT OF WAY 27 - NOT VISIBLE (DARK CLOTHING) 28 - INATTENTIVE 29 - FAILURE TO OBEY TRAFFIC SIGNS /SIGNALS/OFFICER 30 - WRONG SIDE OF THE ROAD 31 - OTHER NON-MOTORIST ACTION	VEHICLE DEFECTS 01 01 - TURN SIGNALS 02 - HEAD LAMPS 03 - TAIL LAMPS 04 - BRAKES 05 - STEERING 06 - TIRE BLOWOUT 07 - WORN OR SLICK TIRES 08 - TRAILER EQUIPMENT DEFECTIVE 09 - MOTOR TROUBLE 10 - DISABLED FROM PRIOR ACCIDENT 11 - OTHER DEFECTS
---	--	--	---	---

SEQUENCE OF EVENTS 1 20 2 00 3 00 4 00 5 00 6 00 FIRST HARMFUL EVENT 1 MOST HARMFUL EVENT 1 99 - UNKNOWN	NON-COLLISION EVENTS 01 - OVERTURN/ROLLOVER 02 - FIRE/EXPLOSION 03 - IMMERSION 04 - JACKKNIFE 05 - CARGO/EQUIPMENT LOSS OR SHIFT 06 - EQUIPMENT FAILURE (BLOWN TIRE, BRAKE FAILURE, ETC) 07 - SEPARATION OF UNITS 08 - RAN OFF ROAD RIGHT 09 - RAN OFF ROAD LEFT 10 - CROSS MEDIAN 11 - CROSS CENTER LINE OPPOSITE DIRECTION OF TRAVEL 12 - DOWNHILL RUNAWAY 13 - OTHER NON-COLLISION	COLLISION WITH PERSON, VEHICLE OR OBJECT NOT FIXED 14 - PEDESTRIAN 15 - PEDALCYCLE 16 - RAILWAY VEHICLE (TRAIN, ENGINE) 17 - ANIMAL - FARM 18 - ANIMAL - DEER 19 - ANIMAL - OTHER 20 - MOTOR VEHICLE IN TRANSPORT 21 - PARKED MOTOR VEHICLE 22 - WORK ZONE MAINTENANCE EQUIPMENT 23 - STRUCK BY FALLING, SHIFTING CARGO OR ANYTHING SET IN MOTION BY A MOTOR VEHICLE 24 - OTHER MOVABLE OBJECT 25 - IMPACT ATTENUATOR/CRASH CUSHION 26 - BRIDGE OVERHEAD STRUCTURE 27 - BRIDGE PIER OR ABUTMENT 28 - BRIDGE PARAPET 29 - BRIDGE RAIL 30 - GUARDRAIL FACE 31 - GUARDRAIL END 32 - PORTABLE BARRIER 33 - MEDIAN CABLE BARRIER 34 - MEDIAN GUARDRAIL BARRIER 35 - MEDIAN CONCRETE BARRIER 36 - MEDIAN OTHER BARRIER 37 - TRAFFIC SIGN POST 38 - OVERHEAD SIGN POST 39 - LIGHT/LUMINARIES SUPPORT 40 - UTILITY POLE 41 - OTHER POST, POLE OR SUPPORT 42 - CULVERT 43 - CURB 44 - DITCH 45 - EMBANKMENT 46 - FENCE 47 - MAILBOX 48 - TREE 49 - FIRE HYDRANT 50 - WORK ZONE MAINTENANCE EQUIPMENT 51 - WALL, BUILDING, TUNNEL 52 - OTHER FIXED OBJECT
---	--	--

UNIT SPEED 35	POSTED SPEED 40	TRAFFIC CONTROL 12 01 - NO CONTROLS 02 - STOP SIGN 03 - YIELD SIGN 04 - TRAFFIC SIGNAL 05 - TRAFFIC FLASHERS 06 - SCHOOL ZONE 07 - RAILROAD CROSSBUCKS 08 - RAILROAD FLASHERS 09 - RAILROAD GATES 10 - CONSTRUCTION BARRICADE 11 - PERSON (FLAGGER, OFFICER) 12 - PAVEMENT MARKINGS 13 - CROSSWALK LINES 14 - WALK/DON'T WALK 15 - OTHER 16 - NOT REPORTED	UNIT DIRECTION FROM 1 TO 2 1 - NORTH 2 - SOUTH 3 - EAST 4 - WEST 5 - NORTHEAST 6 - NORTHWEST 7 - SOUTHEAST 8 - SOUTHWEST 9 - UNKNOWN
-------------------------	---------------------------	--	--

LOCAL REPORT NUMBER

UNIT NUMBER: **02** OWNER NAME: LAST, FIRST, MIDDLE (SAME AS DRIVER) OWNER PHONE NUMBER - INC. AREA CODE (SAME AS DRIVER)

DAMAGE SCALE: **3** DAMAGED AREA: FRONT

OWNER ADDRESS: CITY, STATE, ZIP (SAME AS DRIVER)

LP STATE: **OH** LICENSE PLATE NUMBER: **EE84XA** VEHICLE IDENTIFICATION NUMBER: **1G1AL1SF867633773** # OCCUPANTS: **01**

VEHICLE YEAR: **2006** VEHICLE MAKE: **CHEVROLET** VEHICLE MODEL: **COBALT** VEHICLE COLOR: **BLUE**

PROOF OF INSURANCE SHOWN: INSURANCE COMPANY: **ALLSTATE** POLICY NUMBER: **992045122** TOWED BY:

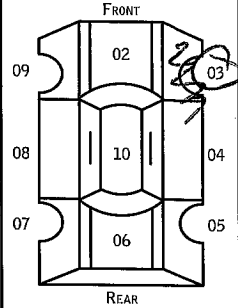

CARRIER NAME, ADDRESS, CITY, STATE, ZIP CARRIER PHONE - INCLUDE AREA CODE

US DOT: **01** VEHICLE WEIGHT GVWR/GCWR: **1** CARGO BODY TYPE: **01** TRAFFICWAY DESCRIPTION: **1**

HM PLACARD ID No. HM CLASS NUMBER

HAZARDOUS MATERIAL RELEASED: CARGO BODY TYPE LIST: 01 - NO CARGO BODY TYPE/NOT APPLICABLE, 02 - BUS/VAN (9-15 SEATS, INC DRIVER), 03 - BUS (16+ SEATS, INC DRIVER), 04 - VEHICLE TOWING ANOTHER VEHICLE, 05 - LOGGING, 06 - INTERMODAL CONTAINER CHASSIS, 07 - CARGO VAN/ENCLOSED BOX, 08 - GRAIN, CHIPS, GRAVEL, 09 - POLE, 10 - CARGO TANK, 11 - FLAT BED, 12 - DUMP, 13 - CONCRETE MIXER, 14 - AUTO TRANSPORTER, 15 - GARBAGE/REFUSE, 99 - OTHER/UNKNOWN

TRAFFICWAY DESCRIPTION LIST: 1 - Two-Way, Not Divided, 2 - Two-Way, Not Divided, Continuous Left Turn Lane, 3 - Two-Way, Divided, Unprotected (Painted or Grass >4 Ft.) Median, 4 - Two-Way, Divided, Positive Median Barrier, 5 - One-Way Trafficway

HIT / SKIP UNIT:

NON-MOTORIST LOCATION PRIOR TO IMPACT: **01** TYPE OF USE: **1** UNIT TYPE: **02**

PASSENGER VEHICLES (LESS THAN 9 PASSENGERS): 01 - SUB-COMPACT, 02 - COMPACT, 03 - MID SIZE, 04 - FULL SIZE, 05 - MINIVAN, 06 - SPORT UTILITY VEHICLE, 07 - PICKUP, 08 - VAN, 09 - MOTORCYCLE, 10 - MOTORIZED BICYCLE, 11 - SNOWMOBILE/ATV, 12 - OTHER PASSENGER VEHICLE

MED/HEAVY TRUCKS OR COMBO UNITS > 10K LBS: 13 - SINGLE UNIT TRUCK OR VAN 2AXLE, 6 TIRES, 14 - SINGLE UNIT TRUCK; 3+ AXLES, 15 - SINGLE UNIT TRUCK / TRAILER, 16 - TRUCK/TRACTOR (BOBTAIL), 17 - TRACTOR/SEMI-TRAILER, 18 - TRACTOR/DOUBLE, 19 - TRACTOR/TRIPLES, 20 - OTHER MED/HEAVY VEHICLE

BUS/VAN/LIMO (9 OR MORE INCLUDING DRIVER): 21 - BUS/VAN (9-15 SEATS, INC DRIVER), 22 - BUS (16+ SEATS, INC DRIVER)

NON-MOTORIST: 23 - ANIMAL WITH RIDER, 24 - ANIMAL WITH BUGGY, WAGON, SURREY, 25 - BICYCLE/PEDALCYCLIST, 26 - PEDESTRIAN/SKATER, 27 - OTHER NON-MOTORIST

IN EMERGENCY RESPONSE: HAS HM PLACARD:

SPECIAL FUNCTION: **01** MOST DAMAGED AREA: **03** IMPACT AREA: **03** ACTION: **4**

01 - NONE, 02 - TAXI, 03 - RENTAL TRUCK (OVER 10K LBS), 04 - BUS - SCHOOL (PUBLIC OR PRIVATE), 05 - BUS - TRANSIT, 06 - BUS - CHARTER, 07 - BUS - SHUTTLE, 08 - BUS - OTHER, 09 - AMBULANCE, 10 - FIRE, 11 - HIGHWAY/MAINTENANCE, 12 - MILITARY, 13 - POLICE, 14 - PUBLIC UTILITY, 15 - OTHER GOVERNMENT, 16 - CONSTRUCTION EQUIP., 17 - FARM VEHICLE, 18 - FARM EQUIPMENT, 19 - MOTORHOME, 20 - GOLF CART, 21 - TRAIN, 22 - OTHER (EXPLAIN IN NARRATIVE)

01 - NONE, 02 - CENTER FRONT, 03 - RIGHT FRONT, 04 - RIGHT SIDE, 05 - RIGHT REAR, 06 - REAR CENTER, 07 - LEFT REAR, 08 - LEFT SIDE, 09 - LEFT FRONT, 10 - TOP AND WINDOWS, 11 - UNDERCARRIAGE, 12 - LOAD/TRAILER, 13 - TOTAL(ALL AREAS), 14 - OTHER, 99 - UNKNOWN

ACTION LIST: 1 - NON-CONTACT, 2 - NON-COLLISION, 3 - STRIKING, 4 - STRUCK, 5 - STRIKING/STRUCK, 9 - UNKNOWN

PRE-CRASH ACTIONS: **01**

MOTORIST: 01 - STRAIGHT AHEAD, 02 - BACKING, 03 - CHANGING LANES, 04 - OVERTAKING/PASSING, 05 - MAKING RIGHT TURN, 06 - MAKING LEFT TURN, 07 - MAKING U-TURN, 08 - ENTERING TRAFFIC LANE, 09 - LEAVING TRAFFIC LANE, 10 - PARKED, 11 - SLOWING OR STOPPED IN TRAFFIC, 12 - DRIVERLESS, 13 - NEGOTIATING A CURVE, 14 - OTHER MOTORIST ACTION

NON-MOTORIST: 15 - ENTERING OR CROSSING SPECIFIED LOCATION, 16 - WALKING, RUNNING, JOGGING, PLAYING, CYCLING, 17 - WORKING, 18 - PUSHING VEHICLE, 19 - APPROACHING OR LEAVING VEHICLE, 20 - STANDING, 21 - OTHER NON-MOTORIST ACTION

CONTRIBUTING CIRCUMSTANCES: **02**

MOTORIST: 01 - NONE, 02 - FAILURE TO YIELD, 03 - RAN RED LIGHT, 04 - RAN STOP SIGN, 05 - EXCEEDED SPEED LIMIT, 06 - UNSAFE SPEED, 07 - IMPROPER TURN, 08 - LEFT OF CENTER, 09 - FOLLOWED TOO CLOSELY/ACDA, 10 - IMPROPER LANE CHANGE /PASSING/OFF ROAD, 11 - IMPROPER BACKING, 12 - IMPROPER START FROM PARKED POSITION, 13 - STOPPED OR PARKED ILLEGALLY, 14 - OPERATING VEHICLE IN NEGLIGENT MANNER, 15 - SWERVING TO AVOID (DUE TO EXTERNAL CONDITIONS), 16 - WRONG SIDE/WRONG WAY, 17 - FAILURE TO CONTROL, 18 - VISION OBSTRUCTION, 19 - OPERATING DEFECTIVE EQUIPMENT, 20 - LOAD SHIFTING/FALLING/SPILLING, 21 - OTHER IMPROPER ACTION

NON-MOTORIST: 22 - NONE, 23 - IMPROPER CROSSING, 24 - DARTING, 25 - LYING AND/OR ILLEGALLY IN ROADWAY, 26 - FAILURE TO YIELD RIGHT OF WAY, 27 - NOT VISIBLE (DARK CLOTHING), 28 - INATTENTIVE, 29 - FAILURE TO OBEY TRAFFIC SIGNS /SIGNALS/OFFICER, 30 - WRONG SIDE OF THE ROAD, 31 - OTHER NON-MOTORIST ACTION

VEHICLE DEFECTS: 01 - TURN SIGNALS, 02 - HEAD LAMPS, 03 - TAIL LAMPS, 04 - BRAKES, 05 - STEERING, 06 - TIRE BLOWOUT, 07 - WORN OR SLICK TIRES, 08 - TRAILER EQUIPMENT DEFECTIVE, 09 - MOTOR TROUBLE, 10 - DISABLED FROM PRIOR ACCIDENT, 11 - OTHER DEFECTS

SEQUENCE OF EVENTS: 1 **20** 2 **00** 3 **00** 4 **00** 5 **00** 6 **00**

FIRST HARMFUL EVENT: **1** MOST HARMFUL EVENT: **1**

NON-COLLISION EVENTS: 01 - OVERTURN/ROLLOVER, 02 - FIRE/EXPLOSION, 03 - IMMERSION, 04 - JACKKNIFE, 05 - CARGO/EQUIPMENT LOSS OR SHIFT, 06 - EQUIPMENT FAILURE (BLOWN TIRE, BRAKE FAILURE, ETC), 07 - SEPARATION OF UNITS, 08 - RAN OFF ROAD RIGHT, 09 - RAN OFF ROAD LEFT, 10 - CROSS MEDIAN, 11 - CROSS CENTER LINE OPPOSITE DIRECTION OF TRAVEL, 12 - DOWNHILL RUNAWAY, 13 - OTHER NON-COLLISION

COLLISION WITH PERSON, VEHICLE OR OBJECT NOT FIXED: 14 - PEDESTRIAN, 15 - PEDALCYCLE, 16 - RAILWAY VEHICLE (TRAIN, ENGINE), 17 - ANIMAL - FARM, 18 - ANIMAL - DEER, 19 - ANIMAL - OTHER, 20 - MOTOR VEHICLE IN TRANSPORT, 21 - PARKED MOTOR VEHICLE, 22 - WORK ZONE MAINTENANCE EQUIPMENT, 23 - STRUCK BY FALLING, SHIFTING CARGO OR ANYTHING SET IN MOTION BY A MOTOR VEHICLE, 24 - OTHER MOVABLE OBJECT

COLLISION WITH FIXED OBJECT: 25 - IMPACT ATTENUATOR/CRASH CUSHION, 26 - BRIDGE OVERHEAD STRUCTURE, 27 - BRIDGE PIER OR ABUTMENT, 28 - BRIDGE PARAPET, 29 - BRIDGE RAIL, 30 - GUARDRAIL FACE, 31 - GUARDRAIL END, 32 - PORTABLE BARRIER, 33 - MEDIAN CABLE BARRIER, 34 - MEDIAN GUARDRAIL BARRIER, 35 - MEDIAN CONCRETE BARRIER, 36 - MEDIAN OTHER BARRIER, 37 - TRAFFIC SIGN POST, 38 - OVERHEAD SIGN POST, 39 - LIGHT/LUMINARIES SUPPORT, 40 - UTILITY POLE, 41 - OTHER POST, POLE OR SUPPORT, 42 - CULVERT, 43 - CURB, 44 - DITCH, 45 - EMBANKMENT, 46 - FENCE, 47 - MAILBOX, 48 - TREE, 49 - FIRE HYDRANT, 50 - WORK ZONE MAINTENANCE EQUIPMENT, 51 - WALL, BUILDING, TUNNEL, 52 - OTHER FIXED OBJECT

UNIT SPEED: **15** POSTED SPEED: **40** TRAFFIC CONTROL: **12** UNIT DIRECTION: FROM **3** TO **4**

STATED: ESTIMATED: TRAFFIC CONTROL LIST: 01 - NO CONTROLS, 02 - STOP SIGN, 03 - YIELD SIGN, 04 - TRAFFIC SIGNAL, 05 - TRAFFIC FLASHERS, 06 - SCHOOL ZONE, 07 - RAILROAD CROSSBUCKS, 08 - RAILROAD FLASHERS, 09 - RAILROAD GATES, 10 - CONSTRUCTION BARRICADE, 11 - PERSON (FLAGGER, OFFICER), 12 - PAVEMENT MARKINGS, 13 - CROSSWALK LINES, 14 - WALK/DON'T WALK, 15 - OTHER, 16 - NOT REPORTED

UNIT DIRECTION LIST: 1 - NORTH, 2 - SOUTH, 3 - EAST, 4 - WEST, 5 - NORTHEAST, 6 - NORTHWEST, 7 - SOUTHEAST, 8 - SOUTHWEST, 9 - UNKNOWN

LOCAL REPORT NUMBER	REPORTING AGENCY MASON POLICE	DATE OF CRASH 10 15 15
IN COUNTY OF WARREN	CRASH LOCATION READING RD	

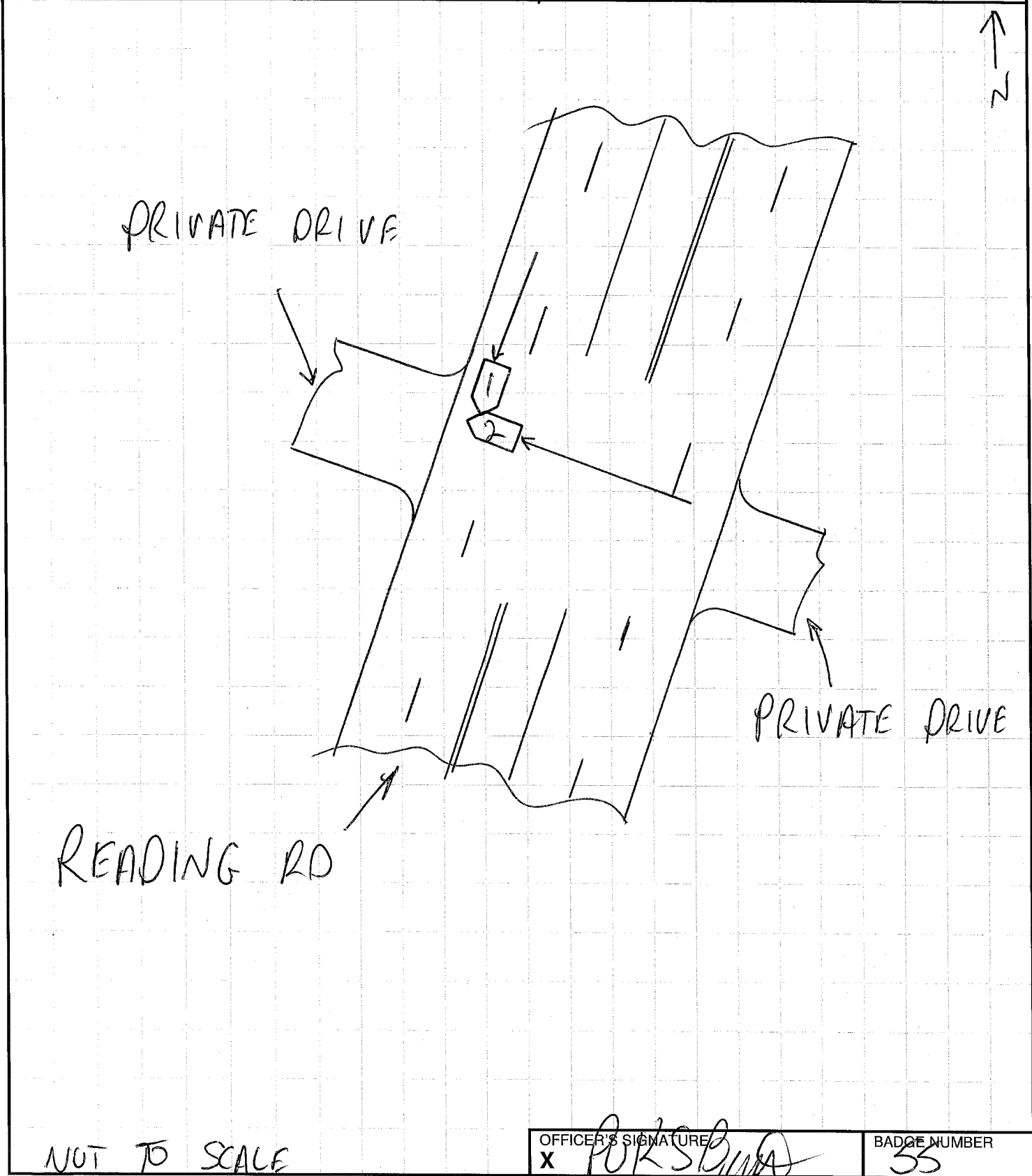



LOCAL REPORT NUMBER	REPORTING AGENCY MASON POLICE	DATE OF CRASH M D Y
---------------------	---	----------------------------

FOR LOCAL USE ONLY - DO NOT SUBMIT TO THE STATE EXCEPT FOR FATAL CRASHES

I, Catherine B Farrell _____ HEREBY MAKE THIS VOLUNTARY STATEMENT TO
PRINTED

P.O. K. S. BRYANT AT 42nd WESTERN Row
OFFICER'S NAME LOCATION

I was driving towards Western Row when she pulled out of Walgreens parking lot and hit me broad side to the front of my car.

Q. WERE YOU, OR ANYONE IN YOUR VEHICLE INJURED? No

Q. WERE YOU WEARING YOUR SEAT BELT? Yes

Q. WHAT DIRECTION WERE YOU GOING? South on Route 42

Q. WHAT WAS YOUR SPEED? 35

Q. WERE YOU USING A CELL PHONE AT THE TIME OF THE CRASH? No

ADDRESS OF WITNESS _____ PHONE 513 398 4036

SIGNATURE OF WITNESS X Catherine B Farrell OFFICER'S SIGNATURE X P O K S Bryant