



# TRAFFIC CRASH REPORT

LOCAL REPORT NUMBER \*

20115010001191528

CRASH SEVERITY

2  
1 - FATAL  
2 - INJURY  
3 - PDO

HIT/SKIP

1 - SOLVED  
2 - UNSOLVED

LOCAL INFORMATION

PHOTOS TAKEN  
 OH-2  OH-1P  
 OH-3  OTHER

PDO UNDER STATE REPORTABLE DOLLAR AMOUNT

PRIVATE PROPERTY

REPORTING AGENCY NCIC \*  
1083104REPORTING AGENCY NAME \*  
MASON P.D.NUMBER OF UNITS  
104UNIT IN ERROR  
01  
98 - ANIMAL  
99 - UNKNOWN

COUNTY \*

13

CITY \*

 VILLAGE \*  
 TOWNSHIP \*

CITY, VILLAGE, TOWNSHIP \*

CITY OF MASON

CRASH DATE \*

10/16/2015

TIME OF CRASH

2047

DAY OF WEEK

TUE

DEGREES / MINUTES / SECONDS

LATITUDE 0 / " LONGITUDE 0 / "

DECIMAL DEGREES

LATITUDE 39.3591189 LONGITUDE 784.210251

ROADWAY DIVISION

 DIVIDED  
 UNDIVIDED

DIVIDED LANE DIRECTION OF TRAVEL

N - NORTHBOUND E - EASTBOUND  
S - SOUTHBOUND W - WESTBOUND

NUMBER OF THRU LANES

1

ROAD TYPES OR MILEPOST <sup>2</sup>AL - ALLEY CR - CIRCLE HE - HEIGHTS MP - MILEPOST PL - PLACE ST - STREET WA - WAY  
AV - AVENUE CT - COURT HW - HIGHWAY PK - PARKWAY RD - ROAD TE - TERRACE  
BL - BOULEVARD DR - DRIVE LA - LANE PI - PIKE SQ - SQUARE TL - TRAIL

LOCATION ROUTE TYPE 1

LOCATION ROUTE NUMBER

LOC PREFIX N,S,E,W

LOCATION ROAD NAME

SOUTH EAST

LOCATION ROUTE TYPE 2

ROUTE TYPES <sup>1</sup>IR - INTERSTATE ROUTE (INC. TURNPIKE) CR - NUMBERED COUNTY ROUTE  
US - US ROUTE TR - NUMBERED TOWNSHIP ROUTE  
SR - STATE ROUTE

DISTANCE FROM REFERENCE

0  
MILES  
FEET  
YARDS

DIR FROM REF

N,S,E,W

REFERENCE ROUTE TYPE 1

REFERENCE ROUTE NUMBER

REFERENCE PREFIX N,S,E,W

REFERENCE NAME (ROAD, MILEPOST, HOUSE #)

122 SOUTH EAST

REFERENCE ROUTE TYPE 2

REFERENCE POINT USED

1 - INTERSECTION  
2 - MILE POST  
3 - HOUSE NUMBER

CRASH LOCATION

10

01 - NOT AN INTERSECTION 06 - FIVE-POINT, OR MORE 11 - RAILWAY GRADE CROSSING  
02 - FOUR-WAY INTERSECTION 07 - ON RAMP 12 - SHARED-USE PATHS OR TRAILS  
03 - T-INTERSECTION 08 - OFF RAMP 99 - UNKNOWN  
04 - Y-INTERSECTION 09 - CROSSOVER  
05 - TRAFFIC CIRCLE/ROUNDBOAT 10 - DRIVEWAY/ALLEY ACCESS

INTERSECTION RELATED

LOCATION OF FIRST HARMFUL EVENT

6  
1 - ON ROADWAY 5 - ON GORE  
2 - ON SHOULDER 6 - OUTSIDE TRAFFICWAY  
3 - IN MEDIAN 9 - UNKNOWN  
4 - ON ROADSIDE

ROAD CONTOUR

1 - STRAIGHT LEVEL 4 - CURVE GRADE  
2 - STRAIGHT GRADE 9 - UNKNOWN  
3 - CURVE LEVEL

ROAD CONDITIONS

PRIMARY 01  
SECONDARY01 - DRY 05 - SAND, MUD, DIRT, OIL, GRAVEL 09 - RUT, HOLES, BUMPS, UNEVEN PAVEMENT\*  
02 - WET 06 - WATER (STANDING, MOVING) 10 - OTHER  
03 - SNOW 07 - SLUSH 99 - UNKNOWN  
04 - ICE 08 - DEBRIS\*

\* SECONDARY CONDITION ONLY

MANNER OF CRASH COLLISION/IMPACT

1 - NOT COLLISION BETWEEN TWO MOTOR VEHICLES IN TRANSPORT  
2 - REAR-END 3 - HEAD-ON 4 - REAR-TO-REAR  
5 - BACKING 6 - ANGLE 7 - SIDESWIPE, SAME DIRECTION  
8 - SIDESWIPE, OPPOSITE DIRECTION 9 - UNKNOWN

WEATHER

4  
1 - CLEAR 4 - RAIN 7 - SEVERE CROSSWINDS  
2 - CLOUDY 5 - SLEET, HAIL 8 - BLOWING SAND, SOIL, DIRT, SNOW  
3 - FOG, SMOG, SMOKE 6 - SNOW 9 - OTHER/UNKNOWN

ROAD SURFACE

2  
1 - CONCRETE 4 - SLAG, GRAVEL, STONE  
2 - BLACKTOP, BITUMINOUS, ASPHALT 5 - DIRT  
3 - BRICK/BLOCK 6 - OTHER

LIGHT CONDITIONS

3  
PRIMARY SECONDARY  
1 - DAYLIGHT 5 - DARK - ROADWAY NOT LIGHTED 9 - UNKNOWN  
2 - DAWN 6 - DARK - UNKNOWN ROADWAY LIGHTING  
3 - DUSK 7 - GLARE\*  
4 - DARK - LIGHTED ROADWAY 8 - OTHER

\* SECONDARY CONDITION ONLY

SCHOOL BUS RELATED

 SCHOOL ZONE RELATED  
 YES, SCHOOL BUS DIRECTLY INVOLVED  
 YES, SCHOOL BUS INDIRECTLY INVOLVED WORK ZONE RELATED WORKERS PRESENT  
 LAW ENFORCEMENT PRESENT (OFFICER/VEHICLE)  
 LAW ENFORCEMENT PRESENT (VEHICLE ONLY)

TYPE OF WORK ZONE

1 - LANE CLOSURE 4 - INTERMITTENT OR MOVING WORK  
2 - LANE SHIFT/CROSSOVER 5 - OTHER  
3 - WORK ON SHOULDER OR MEDIAN

LOCATION OF CRASH IN WORK ZONE

1 - BEFORE THE FIRST WORK ZONE WARNING SIGN 4 - ACTIVITY AREA  
2 - ADVANCE WARNING AREA 5 - TERMINATION AREA  
3 - TRANSITION AREA

NARRATIVE

UNIT #1 WAS PARKED IN A CARPORT FACING EAST. UNIT #2 WAS PARKED IN FRONT OF UNIT #1. UNIT #3 WAS PARKED ALONGSIDE AND NORTH OF UNIT #1. UNIT #4 WAS PARKED INSIDE A GARAGE EAST OF UNIT #2 AND FACING EAST. JACOB BENNETT WAS BETWEEN UNITS #1 AND #3 STANDING ON THE RUNNING BOARD OF UNIT #1. BENNETT REACHED INTO THE CAB OF UNIT #1, AN OPEN TOP VEHICLE, AND HIT THE START BUTTON. UNIT #1 WAS IN GEAR, MOVED FORWARD AND STRUCK UNIT #2 IN THE REAR, ALSO STRIKING UNIT #3 ON THE SIDE. UNIT #2 THEN WENT FORWARD STRIKING A GARAGE DOOR AND FORCING THE DOOR TO STRIKE UNIT #4.

Diagram

Write an "N" on the compass diagram to indicate the direction of north.

SEE OH-2

REPORT TAKEN BY  
 POLICE AGENCY  MOTORIST SUPPLEMENT (CORRECTION OR ADDITION TO AN EXISTING REPORT SENT TO ODPS)

DATE CRASH REPORTED

10/16/2015

TIME CRASH REPORTED

2047

DISPATCH TIME

2047

ARRIVAL TIME

2054

TIME CLEARED

2205

OTHER INVESTIGATION TIME

0020

TOTAL MINUTES

0098

OFFICER'S NAME \*

N. FANTINI

OFFICER'S BADGE NUMBER

46

CHECKED BY

50

PAGE 1 OF 7



# MOTORIST / Non-MOTORIST / OCCUPANT

LOCAL REPORT NUMBER

20115000000119528

UNIT NUMBER 011	NAME: LAST, FIRST, MIDDLE	DATE OF BIRTH	AGE	GENDER F - FEMALE M - MALE						
ADDRESS, CITY, STATE, ZIP			CONTACT PHONE- INCLUDE AREA CODE							
INJURIES	INJURED TAKEN BY	EMS AGENCY	MEDICAL FACILITY INJURED TAKEN TO	SAFETY EQUIPMENT USED	DOT COMPLIANT MOTORCYCLE HELMET	SEATING POSITION	AIR BAG USAGE	EJECTION	TRAPPED	
OL STATE	OPERATOR LICENSE NUMBER	OL CLASS	No <input type="checkbox"/> VALID OL <input type="checkbox"/> M/C END.	CONDITION	ALCOHOL/DRUG SUSPECTED	ALCOHOL TEST STATUS	ALCOHOL TEST TYPE	ALCOHOL TEST VALUE	DRUG TEST STATUS	DRUG TEST TYPE
OFFENSE CHARGED ( <input type="checkbox"/> LOCAL CODE)		OFFENSE DESCRIPTION			CITATION NUMBER		HANDS-FREE DEVICE USED		DRIVER DISTRACTED BY	

UNIT NUMBER 012	NAME: LAST, FIRST, MIDDLE	DATE OF BIRTH	AGE	GENDER F - FEMALE M - MALE						
ADDRESS, CITY, STATE, ZIP			CONTACT PHONE- INCLUDE AREA CODE							
INJURIES	INJURED TAKEN BY	EMS AGENCY	MEDICAL FACILITY INJURED TAKEN TO	SAFETY EQUIPMENT USED	DOT COMPLIANT MOTORCYCLE HELMET	SEATING POSITION	AIR BAG USAGE	EJECTION	TRAPPED	
OL STATE	OPERATOR LICENSE NUMBER	OL CLASS	No <input type="checkbox"/> VALID OL <input type="checkbox"/> M/C END.	CONDITION	ALCOHOL/DRUG SUSPECTED	ALCOHOL TEST STATUS	ALCOHOL TEST TYPE	ALCOHOL TEST VALUE	DRUG TEST STATUS	DRUG TEST TYPE
OFFENSE CHARGED ( <input type="checkbox"/> LOCAL CODE)		OFFENSE DESCRIPTION			CITATION NUMBER		HANDS-FREE DEVICE USED		DRIVER DISTRACTED BY	

INJURIES	INJURED TAKEN BY	SAFETY EQUIPMENT USED	99 - UNKNOWN SAFETY EQUIPMENT	Non-MOTORIST
1 - NO INJURY / NONE REPORTED 2 - POSSIBLE 3 - NON-INCAPACITATING 4 - INCAPACITATING 5 - FATAL	1 - NOT TRANSPORTED / TREATED AT SCENE 2 - EMS 3 - POLICE 4 - OTHER 9 - UNKNOWN	MOTORIST 01 - NONE USED - VEHICLE OCCUPANT 02 - SHOULDER BELT ONLY USED 03 - LAP BELT ONLY USED 04 - SHOULDER AND LAP BELT USED	05 - CHILD RESTRAINT SYSTEM-FORWARD FACING 06 - CHILD RESTRAINT SYSTEM- REAR FACING 07 - BOOSTER SEAT 08 - HELMET USED	09 - NONE USED 10 - HELMET USED 11 - PROTECTIVE PADS USED (ELBOWS, KNEES, ETC)

SEATING POSITION	AIR BAG USAGE
01 - FRONT - LEFT SIDE (MOTORCYCLE DRIVER) 02 - FRONT - MIDDLE 03 - FRONT - RIGHT SIDE 04 - SECOND - LEFT SIDE (MOTORCYCLE PASSENGER) 05 - SECOND - MIDDLE 06 - SECOND - RIGHT SIDE	1 - NOT DEPLOYED 2 - DEPLOYED FRONT 3 - DEPLOYED SIDE 4 - DEPLOYED BOTH FRONT/SIDE 5 - NOT APPLICABLE 9 - DEPLOYMENT UNKNOWN
07 - THIRD - LEFT SIDE (MOTORCYCLE SIDE CAR) 08 - THIRD - MIDDLE 09 - THIRD - RIGHT SIDE 10 - SLEEPER SECTION OF CAB (TRUCK) 11 - PASSENGER IN OTHER ENCLOSED CARGO AREA (NON-TRAILING UNIT SUCH AS A BUS, PICK-UP WITH CAP)	12 - PASSENGER IN UNENCLOSED CARGO AREA 13 - TRAILING UNIT 14 - RIDING ON VEHICLE EXTERIOR (NON-TRAILING UNIT) 15 - NON-MOTORIST 16 - OTHER 99 - UNKNOWN

EJECTION	TRAPPED	OPERATOR LICENSE CLASS	CONDITION	ALCOHOL/DRUG SUSPECTED
1 - NOT EJECTED 2 - TOTALLY EJECTED 3 - PARTIALLY EJECTED 4 - NOT APPLICABLE	1 - NOT TRAPPED 2 - EXTRICATED BY MECHANICAL MEANS 3 - EXTRICATED BY NON-MECHANICAL MEANS	1 - CLASS A 2 - CLASS B 3 - CLASS C 4 - REGULAR CLASS (OHIO IS "D") 5 - MC/MOPED ONLY	1 - APPARENTLY NORMAL 2 - PHYSICAL IMPAIRMENT 3 - EMOTIONAL (DEPRESSED, ANGRY, DISTURBED) 4 - ILLNESS	1 - NONE 2 - YES - ALCOHOL SUSPECTED 3 - YES - HBD NOT IMPAIRED 4 - YES - DRUGS SUSPECTED 5 - YES - ALCOHOL AND DRUGS SUSPECTED

ALCOHOL TEST STATUS	ALCOHOL TEST TYPE	DRUG TEST STATUS	DRUG TEST TYPE	DRIVER DISTRACTED BY
1 - NONE GIVEN 2 - TEST REFUSED 3 - TEST GIVEN, CONTAMINATED SAMPLE/UNUSABLE 4 - TEST GIVEN, RESULTS KNOWN 5 - TEST GIVEN, RESULTS UNKNOWN	1 - NONE 2 - BLOOD 3 - URINE 4 - BREATH 5 - OTHER	1 - NONE GIVEN 2 - TEST REFUSED 3 - TEST GIVEN, CONTAMINATED SAMPLE/UNUSABLE 4 - TEST GIVEN, RESULTS KNOWN 5 - TEST GIVEN, RESULTS UNKNOWN	1 - NONE 2 - BLOOD 3 - URINE 4 - OTHER	1 - NO DISTRACTION REPORTED 2 - PHONE 3 - TEXTING/E-MAILING 4 - ELECTRONIC COMMUNICATION DEVICE 5 - OTHER ELECTRONIC DEVICE (NAVIGATION DEVICE, RADIO, DVD) 6 - OTHER INSIDE THE VEHICLE 7 - EXTERNAL DISTRACTION

UNIT NUMBER 1011	NAME: LAST, FIRST, MIDDLE BENNETT, JACOB	DATE OF BIRTH 10/30/51191911	AGE 25	GENDER F - FEMALE M - MALE					
ADDRESS, CITY, STATE, ZIP 6620 RIVER RD. FAIRFIELD, OH 45014			CONTACT PHONE- INCLUDE AREA CODE (513) 503-2180						
INJURIES 4	INJURED TAKEN BY 2	EMS AGENCY MASON	MEDICAL FACILITY INJURED TAKEN TO BETHLEHEM AREA - SPAINCO	SAFETY EQUIPMENT USED 09	DOT COMPLIANT MOTORCYCLE HELMET	SEATING POSITION 14	AIR BAG USAGE 5	EJECTION 4	TRAPPED 3
UNIT NUMBER	NAME: LAST, FIRST, MIDDLE	DATE OF BIRTH	AGE	GENDER F - FEMALE M - MALE					
ADDRESS, CITY, STATE, ZIP			CONTACT PHONE- INCLUDE AREA CODE						
INJURIES	INJURED TAKEN BY	EMS AGENCY	MEDICAL FACILITY INJURED TAKEN TO	SAFETY EQUIPMENT USED	DOT COMPLIANT MOTORCYCLE HELMET	SEATING POSITION	AIR BAG USAGE	EJECTION	TRAPPED

201509000019528

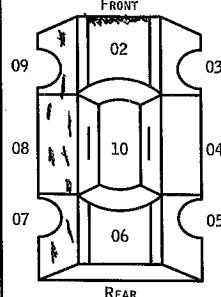
UNIT NUMBER <b>1011</b>	OWNER NAME: LAST, FIRST, MIDDLE ( <input type="checkbox"/> SAME AS DRIVER ) <b>BERNER, PHILIP, H</b>	OWNER PHONE NUMBER - INC. AREA CODE ( <input type="checkbox"/> SAME AS DRIVER ) <b>(513) 646-0577</b>	DAMAGE SCALE <b>2</b>	DAMAGED AREA 
OWNER ADDRESS: CITY, STATE, ZIP ( <input type="checkbox"/> SAME AS DRIVER ) <b>122 SOUTH EAST ST, MASON, OH 45040</b>			1 - NONE	
LP STATE <b>OH</b>	LICENSE PLATE NUMBER <b>FDCM</b>	VEHICLE IDENTIFICATION NUMBER <b>1L3702109</b>	2 - MINOR	
VEHICLE YEAR <b>1998</b>	VEHICLE MAKE <b>AMERICAN LAFRANCE</b>	VEHICLE MODEL <b>FIRETRUCK</b>	3 - FUNCTIONAL	
PROOF OF INSURANCE SHOWN <input type="checkbox"/>	INSURANCE COMPANY <b>CINCINNATI INSURANCE</b>	POLICY NUMBER <b>A020165160</b>	4 - DISABLING	
CARRIER NAME, ADDRESS, CITY, STATE, ZIP			9 - UNKNOWN	

US DOT	VEHICLE WEIGHT GVWR/GCWR <b>2</b> 1 - LESS THAN OR EQUAL TO 10K LBS. 2 - 10,001 TO 26,000 LBS. 3 - MORE THAN 26,000 LBS.	CARGO BODY TYPE <b>01</b> 01 - NO CARGO BODY TYPE/NOT APPLICABLE 02 - BUS/VAN (9-15 SEATS, INC DRIVER) 03 - BUS (16+ SEATS, INC DRIVER) 04 - VEHICLE TOWING ANOTHER VEHICLE 05 - LOGGING 06 - INTERMODAL CONTAINER CHASSIS 07 - CARGO VAN/ENCLOSED BOX 08 - GRAIN, CHIPS, GRAVEL	TRAFFICWAY DESCRIPTION <input type="checkbox"/> 1 - TWO-WAY, NOT DIVIDED <input type="checkbox"/> 2 - TWO-WAY, NOT DIVIDED, CONTINUOUS LEFT TURN LANE <input type="checkbox"/> 3 - TWO-WAY, DIVIDED, UNPROTECTED (PAINTED OR GRASS > 4 FT.) MEDIAN <input type="checkbox"/> 4 - TWO-WAY, DIVIDED, POSITIVE MEDIAN BARRIER <input type="checkbox"/> 5 - ONE-WAY TRAFFICWAY <input type="checkbox"/> HIT / SKIP UNIT
HM PLACARD ID No.	<input type="checkbox"/> HAZARDOUS MATERIAL RELEASED	09 - POLE 10 - CARGO TANK 11 - FLAT BED 12 - DUMP 13 - CONCRETE MIXER 14 - AUTO TRANSPORTER 15 - GARBAGE/REFUSE 99 - OTHER/UNKNOWN	

NON-MOTORIST LOCATION PRIOR TO IMPACT <b>99</b> 01 - INTERSECTION - MARKED CROSSWALK 02 - INTERSECTION - NO CROSSWALK 03 - INTERSECTION - OTHER 04 - MIDBLOCK - MARKED CROSSWALK 05 - TRAVEL LANE - OTHER LOCATION 06 - BICYCLE LANE 07 - SHOULDER/ROADSIDE 08 - SIDEWALK 09 - MEDIAN/CROSSING ISLAND 10 - DRIVEWAY ACCESS 11 - SHARED-USE PATH OR TRAIL 12 - NON-TRAFFICWAY AREA 99 - OTHER/UNKNOWN	TYPE OF USE <b>1</b> 1 - PERSONAL 2 - COMMERCIAL 3 - GOVERNMENT <input type="checkbox"/> IN EMERGENCY RESPONSE	UNIT TYPE <b>99</b> 99 - UNKNOWN OR HIT / SKIP PASSENGER VEHICLES (LESS THAN 9 PASSENGERS) 01 - SUB-COMPACT 02 - COMPACT 03 - MID SIZE 04 - FULL SIZE 05 - MINIVAN 06 - SPORT UTILITY VEHICLE 07 - PICKUP 08 - VAN 09 - MOTORCYCLE 10 - MOTORIZED BICYCLE 11 - SNOWMOBILE/ATV 12 - OTHER PASSENGER VEHICLE	MED/HEAVY TRUCKS OR COMBO UNITS > 10K LBS 13 - SINGLE UNIT TRUCK OR VAN 2AXLE, 6 TIRES 14 - SINGLE UNIT TRUCK; 3+ AXLES 15 - SINGLE UNIT TRUCK / TRAILER 16 - TRUCK/TRACTOR (BOBTAIL) 17 - TRACTOR/SEMI-TRAILER 18 - TRACTOR/DOUBLE 19 - TRACTOR/TRIPLES 20 - OTHER MED/HEAVY VEHICLE	BUS/VAN/LIMO (9 OR MORE INCLUDING DRIVER) 21 - BUS/VAN (9-15 SEATS, INC DRIVER) 22 - BUS (16+ SEATS, INC DRIVER) NON-MOTORIST 23 - ANIMAL WITH RIDER 24 - ANIMAL WITH BUGGY, WAGON, SURREY 25 - BICYCLE/PEDALCYLIST 26 - PEDESTRIAN/SKATER 27 - OTHER NON-MOTORIST
<input type="checkbox"/> HAS HM PLACARD				

SPECIAL FUNCTION <b>01</b> 01 - NONE 02 - TAXI 03 - RENTAL TRUCK (OVER 10K LBS) 04 - BUS - SCHOOL (PUBLIC OR PRIVATE) 05 - BUS - TRANSIT 06 - BUS - CHARTER 07 - BUS - SHUTTLE 08 - BUS - OTHER	09 - AMBULANCE 10 - FIRE 11 - HIGHWAY/MAINTENANCE 12 - MILITARY 13 - POLICE 14 - PUBLIC UTILITY 15 - OTHER GOVERNMENT 16 - CONSTRUCTION EQUIP.	17 - FARM VEHICLE 18 - FARM EQUIPMENT 19 - MOTORHOME 20 - GOLF CART 21 - TRAIN 22 - OTHER (EXPLAIN IN NARRATIVE)	MOST DAMAGED AREA <b>02</b> 01 - NONE 02 - CENTER FRONT 03 - RIGHT FRONT 04 - RIGHT SIDE 05 - RIGHT REAR 06 - REAR CENTER 07 - LEFT REAR	08 - LEFT SIDE 09 - LEFT FRONT 10 - TOP AND WINDOWS 11 - UNDERCARRIAGE 12 - LOAD/TRAILER 13 - TOTAL(ALL AREAS) 14 - OTHER	ACTION <b>2</b> 1 - NON-CONTACT 2 - NON-COLLISION 3 - STRIKING 4 - STRUCK 5 - STRIKING/STRUCK 9 - UNKNOWN
--	---	---	--	---	--

PRE-CRASH ACTIONS <b>10</b> 99 - UNKNOWN MOTORIST 01 - STRAIGHT AHEAD 02 - BACKING 03 - CHANGING LANES 04 - OVERTAKING/PASSING 05 - MAKING RIGHT TURN 06 - MAKING LEFT TURN	07 - MAKING U-TURN 08 - ENTERING TRAFFIC LANE 09 - LEAVING TRAFFIC LANE 10 - PARKED 11 - SLOWING OR STOPPED IN TRAFFIC 12 - DRIVERLESS	13 - NEGOTIATING A CURVE 14 - OTHER MOTORIST ACTION	NON-MOTORIST 15 - ENTERING OR CROSSING SPECIFIED LOCATION 16 - WALKING, RUNNING, JOGGING, PLAYING, CYCLING 17 - WORKING 18 - PUSHING VEHICLE 19 - APPROACHING OR LEAVING VEHICLE 20 - STANDING 21 - OTHER NON-MOTORIST ACTION
--	---	--	--

CONTRIBUTING CIRCUMSTANCES PRIMARY <b>01</b> SECONDARY <b>99</b> 99 - UNKNOWN	MOTORIST 01 - NONE 02 - FAILURE TO YIELD 03 - RAN RED LIGHT 04 - RAN STOP SIGN 05 - EXCEEDED SPEED LIMIT 06 - UNSAFE SPEED 07 - IMPROPER TURN 08 - LEFT OF CENTER 09 - FOLLOWED TOO CLOSELY/ACDA 10 - IMPROPER LANE CHANGE /PASSING/OFF ROAD	11 - IMPROPER BACKING 12 - IMPROPER START FROM PARKED POSITION 13 - STOPPED OR PARKED ILLEGALLY 14 - OPERATING VEHICLE IN NEGLIGENT MANNER 15 - SWERVING TO AVOID (DUE TO EXTERNAL CONDITIONS) 16 - WRONG SIDE/WRONG WAY 17 - FAILURE TO CONTROL 18 - VISION OBSTRUCTION 19 - OPERATING DEFECTIVE EQUIPMENT 20 - LOAD SHIFTING/FALLING/SPILLING 21 - OTHER IMPROPER ACTION	NON-MOTORIST 22 - NONE 23 - IMPROPER CROSSING 24 - DARTING 25 - LYING AND/OR ILLEGALLY IN ROADWAY 26 - FAILURE TO YIELD RIGHT OF WAY 27 - NOT VISIBLE (DARK CLOTHING) 28 - INATTENTIVE 29 - FAILURE TO OBEY TRAFFIC SIGNS /SIGNALS/OFFICER 30 - WRONG SIDE OF THE ROAD 31 - OTHER NON-MOTORIST ACTION	VEHICLE DEFECTS <b>01</b> 01 - TURN SIGNALS 02 - HEAD LAMPS 03 - TAIL LAMPS 04 - BRAKES 05 - STEERING 06 - TIRE BLOWOUT 07 - WORN OR SLICK TIRES 08 - TRAILER EQUIPMENT DEFECTIVE 09 - MOTOR TROUBLE 10 - DISABLED FROM PRIOR ACCIDENT 11 - OTHER DEFECTS
--	--	--	---	---

SEQUENCE OF EVENTS 1 <b>01</b> 2 <b>01</b> 3 <b>01</b> 4 <b>01</b> 5 <b>01</b> 6 <b>01</b> FIRST HARMFUL EVENT <b>1</b> MOST HARMFUL EVENT <b>1</b> 99 - UNKNOWN	NON-COLLISION EVENTS 01 - OVERTURN/ROLLOVER 02 - FIRE/EXPLOSION 03 - IMMERSION 04 - JACKKNIFE 05 - CARGO/EQUIPMENT LOSS OR SHIFT 06 - EQUIPMENT FAILURE (BLOWN TIRE, BRAKE FAILURE, ETC) 07 - SEPARATION OF UNITS 08 - RAN OFF ROAD RIGHT 09 - RAN OFF ROAD LEFT 10 - CROSS MEDIAN 11 - CROSS CENTER LINE 12 - DOWNHILL RUNAWAY 13 - OTHER NON-COLLISION	COLLISION WITH PERSON, VEHICLE OR OBJECT NOT FIXED 14 - PEDESTRIAN 15 - PEDALCYCLE 16 - RAILWAY VEHICLE (TRAIN, ENGINE) 17 - ANIMAL - FARM 18 - ANIMAL - DEER 19 - ANIMAL - OTHER 20 - MOTOR VEHICLE IN TRANSPORT 21 - PARKED MOTOR VEHICLE 22 - WORK ZONE MAINTENANCE EQUIPMENT 23 - STRUCK BY FALLING, SHIFTING CARGO OR ANYTHING SET IN MOTION BY A MOTOR VEHICLE 24 - OTHER MOVABLE OBJECT	COLLISION WITH FIXED OBJECT 25 - IMPACT ATTENUATOR/CRASH CUSHION 26 - BRIDGE OVERHEAD STRUCTURE 27 - BRIDGE PIER OR ABUTMENT 28 - BRIDGE PARAPET 29 - BRIDGE RAIL 30 - GUARDRAIL FACE 31 - GUARDRAIL END 32 - PORTABLE BARRIER 33 - MEDIAN CABLE BARRIER 34 - MEDIAN GUARDRAIL BARRIER 35 - MEDIAN CONCRETE BARRIER 36 - MEDIAN OTHER BARRIER 37 - TRAFFIC SIGN POST 38 - OVERHEAD SIGN POST 39 - LIGHT/LUMINARIES SUPPORT 40 - UTILITY POLE 41 - OTHER POST, POLE OR SUPPORT 42 - CULVERT 43 - CURB 44 - DITCH 45 - EMBANKMENT 46 - FENCE 47 - MAILBOX 48 - TREE 49 - FIRE HYDRANT 50 - WORK ZONE MAINTENANCE EQUIPMENT 51 - WALL, BUILDING, TUNNEL 52 - OTHER FIXED OBJECT
---	---	---	--

UNIT SPEED <b>10</b> <input type="checkbox"/> STATED <input checked="" type="checkbox"/> ESTIMATED	POSTED SPEED <b>10</b>	TRAFFIC CONTROL <b>01</b> 01 - NO CONTROLS 02 - STOP SIGN 03 - YIELD SIGN 04 - TRAFFIC SIGNAL 05 - TRAFFIC FLASHERS 06 - SCHOOL ZONE 07 - RAILROAD CROSSBUCKS 08 - RAILROAD FLASHERS 09 - RAILROAD GATES 10 - CONSTRUCTION BARRICADE 11 - PERSON (FLAGGER, OFFICER) 12 - PAVEMENT MARKINGS 13 - CROSSWALK LINES 14 - WALK/DON'T WALK 15 - OTHER 16 - NOT REPORTED	UNIT DIRECTION FROM <b>4</b> TO <b>3</b> 1 - NORTH 2 - SOUTH 3 - EAST 4 - WEST 5 - NORTHEAST 6 - NORTHWEST 7 - SOUTHEAST 8 - SOUTHWEST 9 - UNKNOWN
---	---------------------------	--	--

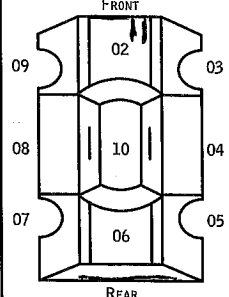
UNIT NUMBER <b>102</b>	OWNER NAME: LAST, FIRST, MIDDLE ( <input type="checkbox"/> SAME AS DRIVER ) <b>BERNER, PHILIP, H</b>	OWNER PHONE NUMBER - INC. AREA CODE ( <input type="checkbox"/> SAME AS DRIVER ) <b>(512) 846-0577</b>	DAMAGE SCALE <b>2</b>	DAMAGED AREA 
OWNER ADDRESS: CITY, STATE, ZIP ( <input type="checkbox"/> SAME AS DRIVER ) <b>122 SOUTH EAST ST, NATION, OH 45040</b>			1 - NONE	
LP STATE <b>OH</b>	LICENSE PLATE NUMBER <b>SEAFUZ</b>	VEHICLE IDENTIFICATION NUMBER <b>1111J01M931A4D18358</b>	2 - MINOR	
VEHICLE YEAR <b>11980</b>	VEHICLE MAKE <b>JEEP</b>	VEHICLE MODEL <b>C-5</b>	3 - FUNCTIONAL	
PROOF OF INSURANCE SHOWN <input type="checkbox"/>	INSURANCE COMPANY <b>CINCINNATI INSURANCE</b>	POLICY NUMBER <b>A02016S160</b>	4 - DISABLING	
CARRIER NAME, ADDRESS, CITY, STATE, ZIP			9 - UNKNOWN	
CARRIER PHONE- INCLUDE AREA CODE				

US DOT	VEHICLE WEIGHT GVWR/GCWR <b>1</b> 1 - LESS THAN OR EQUAL TO 10K LBS. 2 - 10,001 TO 26,000 LBS. 3 - MORE THAN 26,000 LBS.	CARGO BODY TYPE <b>01</b> 01 - NO CARGO BODY TYPE/NOT APPLICABLE 02 - BUS/VAN (9-15 SEATS, INC DRIVER) 03 - BUS (16+ SEATS, INC DRIVER) 04 - VEHICLE TOWING ANOTHER VEHICLE 05 - LOGGING 06 - INTERMODAL CONTAINER CHASSIS 07 - CARGO VAN/ENCLOSED BOX 08 - GRAIN, CHIPS, GRAVEL	TRAFFICWAY DESCRIPTION <input type="checkbox"/> 1 - TWO-WAY, NOT DIVIDED <input type="checkbox"/> 2 - TWO-WAY, NOT DIVIDED, CONTINUOUS LEFT TURN LANE <input type="checkbox"/> 3 - TWO-WAY, DIVIDED, UNPROTECTED (PAINTED OR GRASS >4 FT.) MEDIAN <input type="checkbox"/> 4 - TWO-WAY, DIVIDED, POSITIVE MEDIAN BARRIER <input type="checkbox"/> 5 - ONE-WAY TRAFFICWAY
HM PLACARD ID No.	<input type="checkbox"/> HAZARDOUS MATERIAL RELEASED	09 - POLE 10 - CARGO TANK 11 - FLAT BED 12 - DUMP 13 - CONCRETE MIXER 14 - AUTO TRANSPORTER 15 - GARBAGE/REFUSE 99 - OTHER/UNKNOWN	<input type="checkbox"/> HIT / SKIP UNIT
HM CLASS NUMBER			

NON-MOTORIST LOCATION PRIOR TO IMPACT <b>99</b> 01 - INTERSECTION - MARKED CROSSWALK 02 - INTERSECTION - NO CROSSWALK 03 - INTERSECTION - OTHER 04 - MIDBLOCK - MARKED CROSSWALK 05 - TRAVEL LANE - OTHER LOCATION 06 - BICYCLE LANE 07 - SHOULDER/ROADSIDE 08 - SIDEWALK 09 - MEDIAN/CROSSING ISLAND 10 - DRIVEWAY ACCESS 11 - SHARED-USE PATH OR TRAIL 12 - NON-TRAFFICWAY AREA 99 - OTHER/UNKNOWN	TYPE OF USE <b>1</b> 1 - PERSONAL 2 - COMMERCIAL 3 - GOVERNMENT <input type="checkbox"/> IN EMERGENCY RESPONSE	UNIT TYPE <b>06</b> 99 - UNKNOWN OR HIT / SKIP PASSENGER VEHICLES (LESS THAN 9 PASSENGERS) 01 - SUB-COMPACT 02 - COMPACT 03 - MID SIZE 04 - FULL SIZE 05 - MINIVAN 06 - SPORT UTILITY VEHICLE 07 - PICKUP 08 - VAN 09 - MOTORCYCLE 10 - MOTORIZED BICYCLE 11 - SNOWMOBILE/ATV 12 - OTHER PASSENGER VEHICLE	MED/HEAVY TRUCKS OR COMBO UNITS > 10K LBS 13 - SINGLE UNIT TRUCK OR VAN AXLE, 6 TIRES 14 - SINGLE UNIT TRUCK; 3+ AXLES 15 - SINGLE UNIT TRUCK / TRAILER 16 - TRUCK/TRACTOR (BOBTAIL) 17 - TRACTOR/SEMI-TRAILER 18 - TRACTOR/DOUBLE 19 - TRACTOR/TRIPLES 20 - OTHER MED/HEAVY VEHICLE	BUS/VAN/LIMO (9 OR MORE INCLUDING DRIVER) 21 - BUS/VAN (9-15 SEATS, INC DRIVER) 22 - BUS (16+ SEATS, INC DRIVER) NON-MOTORIST 23 - ANIMAL WITH RIDER 24 - ANIMAL WITH BUGGY, WAGON, SURREY 25 - BICYCLE/PEDALCYCLIST 26 - PEDESTRIAN/SKATER 27 - OTHER NON-MOTORIST
<input type="checkbox"/> HAS HM PLACARD				

SPECIAL FUNCTION <b>01</b> 01 - NONE 02 - TAXI 03 - RENTAL TRUCK (OVER 10K LBS) 04 - BUS - SCHOOL (PUBLIC OR PRIVATE) 05 - BUS - TRANSIT 06 - BUS - CHARTER 07 - BUS - SHUTTLE 08 - BUS - OTHER	09 - AMBULANCE 10 - FIRE 11 - HIGHWAY/MAINTENANCE 12 - MILITARY 13 - POLICE 14 - PUBLIC UTILITY 15 - OTHER GOVERNMENT 16 - CONSTRUCTION EQUIP.	17 - FARM VEHICLE 18 - FARM EQUIPMENT 19 - MOTORHOME 20 - GOLF CART 21 - TRAIN 22 - OTHER (EXPLAIN IN NARRATIVE)	MOST DAMAGED AREA <b>02</b> 01 - NONE 02 - CENTER FRONT 03 - RIGHT FRONT 04 - RIGHT SIDE 05 - RIGHT REAR 06 - REAR CENTER 07 - LEFT REAR	08 - LEFT SIDE 09 - LEFT FRONT 10 - TOP AND WINDOWS 11 - UNDERCARRIAGE 12 - LOAD/TRAILER 13 - TOTAL(ALL AREAS) 14 - OTHER	ACTION <b>5</b> 1 - NON-CONTACT 2 - NON-COLLISION 3 - STRIKING 4 - STRUCK 5 - STRIKING/STRUCK 9 - UNKNOWN
--	---	---	--	---	--

PRE-CRASH ACTIONS <b>10</b> 99 - UNKNOWN MOTORIST 01 - STRAIGHT AHEAD 02 - BACKING 03 - CHANGING LANES 04 - OVERTAKING/PASSING 05 - MAKING RIGHT TURN 06 - MAKING LEFT TURN 07 - MAKING U-TURN 08 - ENTERING TRAFFIC LANE 09 - LEAVING TRAFFIC LANE 10 - PARKED 11 - SLOWING OR STOPPED IN TRAFFIC 12 - DRIVERLESS 13 - NEGOTIATING A CURVE 14 - OTHER MOTORIST ACTION NON-MOTORIST 15 - ENTERING OR CROSSING SPECIFIED LOCATION 16 - WALKING, RUNNING, JOGGING, PLAYING, CYCLING 17 - WORKING 18 - PUSHING VEHICLE 19 - APPROACHING OR LEAVING VEHICLE 20 - STANDING 21 - OTHER NON-MOTORIST ACTION
---

CONTRIBUTING CIRCUMSTANCES PRIMARY <b>01</b> 01 - NONE 02 - FAILURE TO YIELD 03 - RAN RED LIGHT 04 - RAN STOP SIGN 05 - EXCEEDED SPEED LIMIT 06 - UNSAFE SPEED 07 - IMPROPER TURN 08 - LEFT OF CENTER 09 - FOLLOWED TOO CLOSELY/ACDA 10 - IMPROPER LANE CHANGE /PASSING/OFF ROAD SECONDARY <b>01</b> 99 - UNKNOWN 11 - IMPROPER BACKING 12 - IMPROPER START FROM PARKED POSITION 13 - STOPPED OR PARKED ILLEGALLY 14 - OPERATING VEHICLE IN NEGLIGENT MANNER 15 - SWERVING TO AVOID (DUE TO EXTERNAL CONDITIONS) 16 - WRONG SIDE/WRONG WAY 17 - FAILURE TO CONTROL 18 - VISION OBSTRUCTION 19 - OPERATING DEFECTIVE EQUIPMENT 20 - LOAD SHIFTING/FALLING/SPILLING 21 - OTHER IMPROPER ACTION	VEHICLE DEFECTS <b>01</b> 01 - TURN SIGNALS 02 - HEAD LAMPS 03 - TAIL LAMPS 04 - BRAKES 05 - STEERING 06 - TIRE BLOWOUT 07 - WORN OR SLICK TIRES 08 - TRAILER EQUIPMENT DEFECTIVE 09 - MOTOR TROUBLE 10 - DISABLED FROM PRIOR ACCIDENT 11 - OTHER DEFECTS
--	---

SEQUENCE OF EVENTS 1 <b>5</b> 2 <b>2</b> 3 <b>1</b> 4 <b>1</b> 5 <b>1</b> 6 <b>1</b> FIRST HARMFUL EVENT <b>1</b> MOST HARMFUL EVENT <b>1</b> 99 - UNKNOWN COLLISION WITH PERSON, VEHICLE OR OBJECT NOT FIXED 14 - PEDESTRIAN 15 - PEDALCYCLE 16 - RAILWAY VEHICLE (TRAIN, ENGINE) 17 - ANIMAL - FARM 18 - ANIMAL - DEER 19 - ANIMAL - OTHER 20 - MOTOR VEHICLE IN TRANSPORT 21 - PARKED MOTOR VEHICLE 22 - WORK ZONE MAINTENANCE EQUIPMENT 23 - STRUCK BY FALLING, SHIFTING CARGO OR ANYTHING SET IN MOTION BY A MOTOR VEHICLE 24 - OTHER MOVABLE OBJECT NON-COLLISION EVENTS 01 - OVERTURN/ROLLOVER 02 - FIRE/EXPLOSION 03 - IMMERSION 04 - JACKKNIFE 05 - CARGO/EQUIPMENT LOSS OR SHIFT 06 - EQUIPMENT FAILURE (BLOWN TIRE, BRAKE FAILURE, ETC) 07 - SEPARATION OF UNITS 08 - RAN OFF ROAD RIGHT 09 - RAN OFF ROAD LEFT 10 - CROSS MEDIAN 11 - CROSS CENTER LINE OPPOSITE DIRECTION OF TRAVEL 12 - DOWNHILL RUNAWAY 13 - OTHER NON-COLLISION COLLISION WITH FIXED OBJECT 25 - IMPACT ATTENUATOR/CRASH CUSHION 26 - BRIDGE OVERHEAD STRUCTURE 27 - BRIDGE PIER OR ABUTMENT 28 - BRIDGE PARAPET 29 - BRIDGE RAIL 30 - GUARDRAIL FACE 31 - GUARDRAIL END 32 - PORTABLE BARRIER 33 - MEDIAN CABLE BARRIER 34 - MEDIAN GUARDRAIL BARRIER 35 - MEDIAN CONCRETE BARRIER 36 - MEDIAN OTHER BARRIER 37 - TRAFFIC SIGN POST 38 - OVERHEAD SIGN POST 39 - LIGHT/LUMINARIES SUPPORT 40 - UTILITY POLE 41 - OTHER POST, POLE OR SUPPORT 42 - CURB 43 - CULVERT 44 - DITCH 45 - EMBANKMENT 46 - FENCE 47 - MAILBOX 48 - TREE 49 - FIRE HYDRANT 50 - WORK ZONE MAINTENANCE EQUIPMENT 51 - WALL, BUILDING, TUNNEL 52 - OTHER FIXED OBJECT
---

UNIT SPEED <b>000</b> <input type="checkbox"/> STATED <input checked="" type="checkbox"/> ESTIMATED	POSTED SPEED <b>00</b>	TRAFFIC CONTROL <b>01</b> 01 - NO CONTROLS 02 - STOP SIGN 03 - YIELD SIGN 04 - TRAFFIC SIGNAL 05 - TRAFFIC FLASHERS 06 - SCHOOL ZONE 07 - RAILROAD CROSSBUCKS 08 - RAILROAD FLASHERS 09 - RAILROAD GATES 10 - CONSTRUCTION BARRICADE 11 - PERSON (FLAGGER, OFFICER) 12 - PAVEMENT MARKINGS 13 - CROSSWALK LINES 14 - WALK/DON'T WALK 15 - OTHER 16 - NOT REPORTED	UNIT DIRECTION FROM <b>4</b> TO <b>3</b> 1 - NORTH 2 - SOUTH 3 - EAST 4 - WEST 5 - NORTHEAST 6 - NORTHWEST 7 - SOUTHEAST 8 - SOUTHWEST 9 - UNKNOWN
--	---------------------------	--	--

2411510190011915218

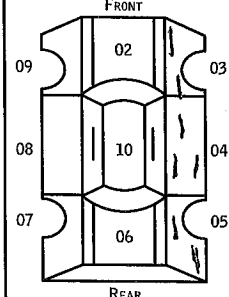
UNIT NUMBER <b>1031</b>	OWNER NAME: LAST, FIRST, MIDDLE ( <input type="checkbox"/> SAME AS DRIVER ) <b>BERNER, PHILIP, H</b>	OWNER PHONE NUMBER - INC. AREA CODE ( <input type="checkbox"/> SAME AS DRIVER ) <b>(513) 646-0577</b>	DAMAGE SCALE <b>2</b>	DAMAGED AREA 
OWNER ADDRESS: CITY, STATE, ZIP ( <input type="checkbox"/> SAME AS DRIVER ) <b>122 SOUTH EAST ST, MAJOR, OH 45040</b>				
LP STATE <b>OH</b>	LICENSE PLATE NUMBER <b>818XFW</b>	VEHICLE IDENTIFICATION NUMBER <b>1G71S1130109</b>	# OCCUPANTS <b>09</b>	
VEHICLE YEAR <b>119716</b>	VEHICLE MAKE <b>SEA-GRAVE</b>	VEHICLE MODEL <b>FIRETRUCK</b>	VEHICLE COLOR <b>RED</b>	
PROOF OF INSURANCE SHOWN <input type="checkbox"/>	INSURANCE COMPANY <b>CINCINNATI, INSURANCE</b>	POLICY NUMBER <b>A020165160</b>	TOWED BY	
CARRIER NAME, ADDRESS, CITY, STATE, ZIP			CARRIER PHONE- INCLUDE AREA CODE	

US DOT	VEHICLE WEIGHT GVWR/GCWR <b>2</b> 1 - LESS THAN OR EQUAL TO 10K LBS. 2 - 10,001 TO 26,000 LBS. 3 - MORE THAN 26,000 LBS.	CARGO BODY TYPE <b>01</b> 01 - NO CARGO BODY TYPE/NOT APPLICABLE 02 - BUS/VAN (9-15 SEATS, INC DRIVER) 03 - BUS (16+ SEATS, INC DRIVER) 04 - VEHICLE TOWING ANOTHER VEHICLE 05 - LOGGING 06 - INTERMODAL CONTAINER CHASSIS 07 - CARGO VAN/ENCLOSED BOX 08 - GRAIN, CHIPS, GRAVEL 09 - POLE 10 - CARGO TANK 11 - FLAT BED 12 - DUMP 13 - CONCRETE MIXER 14 - AUTO TRANSPORTER 15 - GARBAGE/REFUSE 99 - OTHER/UNKNOWN	TRAFFICWAY DESCRIPTION <input type="checkbox"/> 1 - TWO-WAY, NOT DIVIDED <input type="checkbox"/> 2 - TWO-WAY, NOT DIVIDED, CONTINUOUS LEFT TURN LANE <input type="checkbox"/> 3 - TWO-WAY, DIVIDED, UNPROTECTED (PAINTED OR GRASS >4 FT.) MEDIAN <input type="checkbox"/> 4 - TWO-WAY, DIVIDED, POSITIVE MEDIAN BARRIER <input type="checkbox"/> 5 - ONE-WAY TRAFFICWAY <input type="checkbox"/> HIT / SKIP UNIT
HM PLACARD ID No.	<input type="checkbox"/> HAZARDOUS MATERIAL RELEASED		
HM CLASS NUMBER			

NON-MOTORIST LOCATION PRIOR TO IMPACT <b>99</b> 01 - INTERSECTION - MARKED CROSSWALK 02 - INTERSECTION - NO CROSSWALK 03 - INTERSECTION - OTHER 04 - MIDBLOCK - MARKED CROSSWALK 05 - TRAVEL LANE - OTHER LOCATION 06 - BICYCLE LANE 07 - SHOULDER/ROADSIDE 08 - SIDEWALK 09 - MEDIAN/CROSSING ISLAND 10 - DRIVEWAY ACCESS 11 - SHARED-USE PATH OR TRAIL 12 - NON-TRAFFICWAY AREA 99 - OTHER/UNKNOWN	TYPE OF USE <b>1</b> 1 - PERSONAL 2 - COMMERCIAL 3 - GOVERNMENT <input type="checkbox"/> IN EMERGENCY RESPONSE	UNIT TYPE <b>20</b> 99 - UNKNOWN OR HIT / SKIP PASSENGER VEHICLES (LESS THAN 9 PASSENGERS) 01 - SUB-COMPACT 02 - COMPACT 03 - MID SIZE 04 - FULL SIZE 05 - MINIVAN 06 - SPORT UTILITY VEHICLE 07 - PICKUP 08 - VAN 09 - MOTORCYCLE 10 - MOTORIZED BICYCLE 11 - SNOWMOBILE/ATV 12 - OTHER PASSENGER VEHICLE MED/HEAVY TRUCKS OR COMBO UNITS > 10K LBS 13 - SINGLE UNIT TRUCK OR VAN 2AXLE, 6 TIRES 14 - SINGLE UNIT TRUCK; 3+ AXLES 15 - SINGLE UNIT TRUCK / TRAILER 16 - TRUCK/TRACTOR (BOBTAIL) 17 - TRACTOR/SEMI-TRAILER 18 - TRACTOR/DOUBLE 19 - TRACTOR/TRIPLES 20 - OTHER MED/HEAVY VEHICLE BUS/VAN/LIMO (9 OR MORE INCLUDING DRIVER) 21 - BUS/VAN (9-15 SEATS, INC DRIVER) 22 - BUS (16+ SEATS, INC DRIVER) NON-MOTORIST 23 - ANIMAL WITH RIDER 24 - ANIMAL WITH BUGGY, WAGON, SURREY 25 - BICYCLE/PEDALCYCLIST 26 - PEDESTRIAN/SKATER 27 - OTHER NON-MOTORIST	<input type="checkbox"/> HAS HM PLACARD
--	---	---	---

SPECIAL FUNCTION <b>01</b> 01 - NONE 02 - TAXI 03 - RENTAL TRUCK (OVER 10K LBS) 04 - BUS - SCHOOL (PUBLIC OR PRIVATE) 05 - BUS - TRANSIT 06 - BUS - CHARTER 07 - BUS - SHUTTLE 08 - BUS - OTHER 09 - AMBULANCE 10 - FIRE 11 - HIGHWAY/MAINTENANCE 12 - MILITARY 13 - POLICE 14 - PUBLIC UTILITY 15 - OTHER GOVERNMENT 16 - CONSTRUCTION EQUIP. 17 - FARM VEHICLE 18 - FARM EQUIPMENT 19 - MOTORHOME 20 - GOLF CART 21 - TRAIN 22 - OTHER (EXPLAIN IN NARRATIVE)	MOST DAMAGED AREA <b>04</b> 01 - NONE 02 - CENTER FRONT 03 - RIGHT FRONT 04 - RIGHT SIDE 05 - RIGHT REAR 06 - REAR CENTER 07 - LEFT REAR 08 - LEFT SIDE 09 - LEFT FRONT 10 - TOP AND WINDOWS 11 - UNDERCARRIAGE 12 - LOAD/TRAILER 13 - TOTAL(ALL AREAS) 14 - OTHER	ACTION <b>4</b> 1 - NON-CONTACT 2 - NON-COLLISION 3 - STRIKING 4 - STRUCK 5 - STRIKING/STRUCK 9 - UNKNOWN
--	---	--

PRE-CRASH ACTIONS <b>10</b> 99 - UNKNOWN MOTORIST 01 - STRAIGHT AHEAD 02 - BACKING 03 - CHANGING LANES 04 - OVERTAKING/PASSING 05 - MAKING RIGHT TURN 06 - MAKING LEFT TURN 07 - MAKING U-TURN 08 - ENTERING TRAFFIC LANE 09 - LEAVING TRAFFIC LANE 10 - PARKED 11 - SLOWING OR STOPPED IN TRAFFIC 12 - DRIVERLESS 13 - NEGOTIATING A CURVE 14 - OTHER MOTORIST ACTION NON-MOTORIST 15 - ENTERING OR CROSSING SPECIFIED LOCATION 16 - WALKING, RUNNING, JOGGING, PLAYING, CYCLING 17 - WORKING 18 - PUSHING VEHICLE 19 - APPROACHING OR LEAVING VEHICLE 20 - STANDING 21 - OTHER NON-MOTORIST ACTION
---

CONTRIBUTING CIRCUMSTANCES PRIMARY <b>01</b> SECONDARY <input type="checkbox"/> 99 - UNKNOWN MOTORIST 01 - NONE 02 - FAILURE TO YIELD 03 - RAN RED LIGHT 04 - RAN STOP SIGN 05 - EXCEEDED SPEED LIMIT 06 - UNSAFE SPEED 07 - IMPROPER TURN 08 - LEFT OF CENTER 09 - FOLLOWED TOO CLOSELY/ACDA 10 - IMPROPER LANE CHANGE /PASSING/OFF ROAD 11 - IMPROPER BACKING 12 - IMPROPER START FROM PARKED POSITION 13 - STOPPED OR PARKED ILLEGALLY 14 - OPERATING VEHICLE IN NEGLIGENT MANNER 15 - SWERVING TO AVOID (DUE TO EXTERNAL CONDITIONS) 16 - WRONG SIDE/WRONG WAY 17 - FAILURE TO CONTROL 18 - VISION OBSTRUCTION 19 - OPERATING DEFECTIVE EQUIPMENT 20 - LOAD SHIFTING/FALLING/SPILLING 21 - OTHER IMPROPER ACTION NON-MOTORIST 22 - NONE 23 - IMPROPER CROSSING 24 - DARTING 25 - LYING AND/OR ILLEGALLY IN ROADWAY 26 - FAILURE TO YIELD RIGHT OF WAY 27 - NOT VISIBLE (DARK CLOTHING) 28 - INATTENTIVE 29 - FAILURE TO OBEY TRAFFIC SIGNS /SIGNALS/OFFICER 30 - WRONG SIDE OF THE ROAD 31 - OTHER NON-MOTORIST ACTION VEHICLE DEFECTS <input type="checkbox"/> 01 - TURN SIGNALS 02 - HEAD LAMPS 03 - TAIL LAMPS 04 - BRAKES 05 - STEERING 06 - TIRE BLOWOUT 07 - WORN OR SLICK TIRES 08 - TRAILER EQUIPMENT DEFECTIVE 09 - MOTOR TROUBLE 10 - DISABLED FROM PRIOR ACCIDENT 11 - OTHER DEFECTS
--

SEQUENCE OF EVENTS 1 <b>20</b> 2 <input type="checkbox"/> 3 <input type="checkbox"/> 4 <input type="checkbox"/> 5 <input type="checkbox"/> 6 <input type="checkbox"/> FIRST HARMFUL EVENT <b>1</b> MOST HARMFUL EVENT <b>1</b> 99 - UNKNOWN COLLISION WITH PERSON, VEHICLE OR OBJECT NOT FIXED 14 - PEDESTRIAN 15 - PEDALCYCLE 16 - RAILWAY VEHICLE (TRAIN, ENGINE) 17 - ANIMAL - FARM 18 - ANIMAL - DEER 19 - ANIMAL - OTHER 20 - MOTOR VEHICLE IN TRANSPORT 21 - PARKED MOTOR VEHICLE 22 - WORK ZONE MAINTENANCE EQUIPMENT 23 - STRUCK BY FALLING, SHIFTING CARGO OR ANYTHING SET IN MOTION BY A MOTOR VEHICLE 24 - OTHER MOVABLE OBJECT NON-COLLISION EVENTS 01 - OVERTURN/ROLLOVER 02 - FIRE/EXPLOSION 03 - IMMERSION 04 - JACKKNIFE 05 - CARGO/EQUIPMENT LOSS OR SHIFT 06 - EQUIPMENT FAILURE (BLOWN TIRE, BRAKE FAILURE, ETC) 07 - SEPARATION OF UNITS 08 - RAN OFF ROAD RIGHT 09 - RAN OFF ROAD LEFT 10 - CROSS MEDIAN 11 - CROSS CENTER LINE OPPOSITE DIRECTION OF TRAVEL 12 - DOWNHILL RUNAWAY 13 - OTHER NON-COLLISION COLLISION WITH FIXED OBJECT 25 - IMPACT ATTENUATOR/CRASH CUSHION 26 - BRIDGE OVERHEAD STRUCTURE 27 - BRIDGE PIER OR ABUTMENT 28 - BRIDGE PARAPET 29 - BRIDGE RAIL 30 - GUARDRAIL FACE 31 - GUARDRAIL END 32 - PORTABLE BARRIER 33 - MEDIAN CABLE BARRIER 34 - MEDIAN GUARDRAIL BARRIER 35 - MEDIAN CONCRETE BARRIER 36 - MEDIAN OTHER BARRIER 37 - TRAFFIC SIGN POST 38 - OVERHEAD SIGN POST 39 - LIGHT/LUMINARIES SUPPORT 40 - UTILITY POLE 41 - OTHER POST, POLE OR SUPPORT 42 - CURB 43 - CULVERT 44 - DITCH 45 - EMBANKMENT 46 - FENCE 47 - MAILBOX 48 - TREE 49 - FIRE HYDRANT 50 - WORK ZONE MAINTENANCE EQUIPMENT 51 - WALL, BUILDING, TUNNEL 52 - OTHER FIXED OBJECT
--

UNIT SPEED <b>10109</b> <input type="checkbox"/> STATED <input checked="" type="checkbox"/> ESTIMATED	POSTED SPEED <input type="checkbox"/>	TRAFFIC CONTROL <b>01</b> 01 - NO CONTROLS 02 - STOP SIGN 03 - YIELD SIGN 04 - TRAFFIC SIGNAL 05 - TRAFFIC FLASHERS 06 - SCHOOL ZONE 07 - RAILROAD CROSSBUCKS 08 - RAILROAD FLASHERS 09 - RAILROAD GATES 10 - CONSTRUCTION BARRICADE 11 - PERSON (FLAGGER, OFFICER) 12 - PAVEMENT MARKINGS 13 - CROSSWALK LINES 14 - WALK/DON'T WALK 15 - OTHER 16 - NOT REPORTED	UNIT DIRECTION FROM <b>4</b> TO <b>3</b> 1 - NORTH 2 - SOUTH 3 - EAST 4 - WEST 5 - NORTHEAST 6 - NORTHWEST 7 - SOUTHEAST 8 - SOUTHWEST 9 - UNKNOWN
--	--	--	--

LOCAL REPORT NUMBER  
**2011519900001195218**

UNIT NUMBER: **0141** OWNER NAME: LAST, FIRST, MIDDLE ( SAME AS DRIVER) **CITY OF MASON**

OWNER PHONE NUMBER - INC. AREA CODE ( SAME AS DRIVER) **(512) 229-8500**

DAMAGE SCALE:  1 - NONE

DAMAGED AREA:

OWNER ADDRESS: CITY, STATE, ZIP ( SAME AS DRIVER) **6000 MASON-MONTGOMERY RD, MASON, OH 45040**

LP STATE: **OH** LICENSE PLATE NUMBER: **02 513** VEHICLE IDENTIFICATION NUMBER: **[REDACTED]** # OCCUPANTS: **10**

VEHICLE YEAR: **11/2018** VEHICLE MAKE: **GMC** VEHICLE MODEL: **FIRETRUCK** VEHICLE COLOR: **RED**

PROOF OF INSURANCE SHOWN  INSURANCE COMPANY: **MVRMA** POLICY NUMBER: \_\_\_\_\_ TOWED BY: \_\_\_\_\_

CARRIER NAME, ADDRESS, CITY, STATE, ZIP: \_\_\_\_\_ CARRIER PHONE- INCLUDE AREA CODE: \_\_\_\_\_

US DOT: \_\_\_\_\_ VEHICLE WEIGHT GVWR/GCWR:  1 - LESS THAN OR EQUAL TO 10K LBS.  2 - 10,001 TO 26,000 LBS.  3 - MORE THAN 26,000 LBS.

HM PLACARD ID NO. **[REDACTED]** HM CLASS NUMBER: **[REDACTED]**  HAZARDOUS MATERIAL RELEASED

CARGO BODY TYPE:  01 - NO CARGO BODY TYPE/NOT APPLICABLE  02 - BUS/VAN (9-15 SEATS, INC DRIVER)  03 - BUS (16+ SEATS, INC DRIVER)  04 - VEHICLE TOWING ANOTHER VEHICLE  05 - LOGGING  06 - INTERMODAL CONTAINER CHASSIS  07 - CARGO VAN/ENCLOSED BOX  08 - GRAIN, CHIPS, GRAVEL

TRAFFICWAY DESCRIPTION:  1 - TWO-WAY, NOT DIVIDED  2 - TWO-WAY, NOT DIVIDED, CONTINUOUS LEFT TURN LANE  3 - TWO-WAY, DIVIDED, UNPROTECTED (PAINTED OR GRASS > 4 FT.) MEDIAN  4 - TWO-WAY, DIVIDED, POSITIVE MEDIAN BARRIER  5 - ONE-WAY TRAFFICWAY

HIT / SKIP UNIT

NON-MOTORIST LOCATION PRIOR TO IMPACT: **99** 01 - INTERSECTION - MARKED CROSSWALK 02 - INTERSECTION - NO CROSSWALK 03 - INTERSECTION - OTHER 04 - MIDBLOCK - MARKED CROSSWALK 05 - TRAVEL LANE - OTHER LOCATION 06 - BICYCLE LANE 07 - SHOULDER/ROADSIDE 08 - SIDEWALK 09 - MEDIUM/CROSSING ISLAND 10 - DRIVEWAY ACCESS 11 - SHARED-USE PATH OR TRAIL 12 - NON-TRAFFICWAY AREA 99 - OTHER/UNKNOWN

TYPE OF USE:  1 - PERSONAL  2 - COMMERCIAL  3 - GOVERNMENT  IN EMERGENCY RESPONSE

UNIT TYPE:  01 - SUB-COMPACT  02 - COMPACT  03 - MID SIZE  04 - FULL SIZE  05 - MINIVAN  06 - SPORT UTILITY VEHICLE  07 - PICKUP  08 - VAN  09 - MOTORCYCLE  10 - MOTORIZED BICYCLE  11 - SNOWMOBILE/ATV  12 - OTHER PASSENGER VEHICLE

PASSENGER VEHICLES (LESS THAN 9 PASSENGERS): 09 - POLE 10 - CARGO TANK 11 - FLAT BED 12 - DUMP 13 - CONCRETE MIXER 14 - AUTO TRANSPORTER 15 - GARBAGE/REFUSE 99 - OTHER/UNKNOWN

MED/HEAVY TRUCKS OR COMBO UNITS > 10K LBS: 13 - SINGLE UNIT TRUCK OR VAN 2AXLE, 6 TIRES 14 - SINGLE UNIT TRUCK; 3+ AXLES 15 - SINGLE UNIT TRUCK / TRAILER 16 - TRUCK/TRACTOR (BOBTAIL) 17 - TRACTOR/SEMI-TRAILER 18 - TRACTOR/DOUBLE 19 - TRACTOR/TRIPLES 20 - OTHER MED/HEAVY VEHICLE

BUS/VAN/LIMO (9 OR MORE INCLUDING DRIVER): 21 - BUS/VAN (9-15 SEATS, INC DRIVER) 22 - BUS (16+ SEATS, INC DRIVER) Non-Motorist: 23 - ANIMAL WITH RIDER 24 - ANIMAL WITH BUGGY, WAGON, SURREY 25 - BICYCLE/PEDACYCLIST 26 - PEDESTRIAN/SKATER 27 - OTHER NON-MOTORIST

HAS HM PLACARD

SPECIAL FUNCTION: **01** 01 - NONE 02 - TAXI 03 - RENTAL TRUCK (OVER 10K LBS) 04 - BUS - SCHOOL (PUBLIC OR PRIVATE) 05 - BUS - TRANSIT 06 - BUS - CHARTER 07 - BUS - SHUTTLE 08 - BUS - OTHER

09 - AMBULANCE 10 - FIRE 11 - HIGHWAY/MAINTENANCE 12 - MILITARY 13 - POLICE 14 - PUBLIC UTILITY 15 - OTHER GOVERNMENT 16 - CONSTRUCTION EQUIP.

17 - FARM VEHICLE 18 - FARM EQUIPMENT 19 - MOTORHOME 20 - GOLF CART 21 - TRAIN 22 - OTHER (EXPLAIN IN NARRATIVE)

MOST DAMAGED AREA: **07** 01 - NONE 02 - CENTER FRONT 03 - RIGHT FRONT 04 - RIGHT SIDE 05 - RIGHT REAR 06 - REAR CENTER 07 - LEFT REAR

08 - LEFT SIDE 09 - LEFT FRONT 10 - TOP AND WINDOWS 11 - UNDERCARRIAGE 12 - LOAD/TRAILER 13 - TOTAL(ALL AREAS) 14 - OTHER

ACTION: **4** 1 - NON-CONTACT 2 - NON-COLLISION 3 - STRIKING 4 - STRUCK 5 - STRIKING/STRUCK 9 - UNKNOWN

PRE-CRASH ACTIONS: **10**

MOTORIST: 01 - STRAIGHT AHEAD 02 - BACKING 03 - CHANGING LANES 04 - OVERTAKING/PASSING 05 - MAKING RIGHT TURN 06 - MAKING LEFT TURN 07 - MAKING U-TURN 08 - ENTERING TRAFFIC LANE 09 - LEAVING TRAFFIC LANE 10 - PARKED 11 - SLOWING OR STOPPED IN TRAFFIC 12 - DRIVERLESS

NON-MOTORIST: 13 - NEGOTIATING A CURVE 14 - OTHER MOTORIST ACTION 15 - ENTERING OR CROSSING SPECIFIED LOCATION 16 - WALKING, RUNNING, JOGGING, PLAYING, CYCLING 17 - WORKING 18 - PUSHING VEHICLE 19 - APPROACHING OR LEAVING VEHICLE 20 - STANDING 21 - OTHER NON-MOTORIST ACTION

CONTRIBUTING CIRCUMSTANCES

PRIMARY: **01** MOTORIST: 01 - NONE 02 - FAILURE TO YIELD 03 - RAN RED LIGHT 04 - RAN STOP SIGN 05 - EXCEEDED SPEED LIMIT 06 - UNSAFE SPEED 07 - IMPROPER TURN 08 - LEFT OF CENTER 09 - FOLLOWED TOO CLOSELY/ACDA 10 - IMPROPER LANE CHANGE /PASSING/OFF ROAD

NON-MOTORIST: 11 - IMPROPER BACKING 12 - IMPROPER START FROM PARKED POSITION 13 - STOPPED OR PARKED ILLEGALLY 14 - OPERATING VEHICLE IN NEGLIGENT MANNER 15 - SWERVING TO AVOID (DUE TO EXTERNAL CONDITIONS) 16 - WRONG SIDE/WRONG WAY 17 - FAILURE TO CONTROL 18 - VISION OBSTRUCTION 19 - OPERATING DEFECTIVE EQUIPMENT 20 - LOAD SHIFTING/FALLING/SPILLING 21 - OTHER IMPROPER ACTION

VEHICLE DEFECTS: **[REDACTED]** 01 - TURN SIGNALS 02 - HEAD LAMPS 03 - TAIL LAMPS 04 - BRAKES 05 - STEERING 06 - TIRE BLOWOUT 07 - WORN OR SLICK TIRES 08 - TRAILER EQUIPMENT DEFECTIVE 09 - MOTOR TROUBLE 10 - DISABLED FROM PRIOR ACCIDENT 11 - OTHER DEFECTS

SEQUENCE OF EVENTS: 1 **52** 2 **[REDACTED]** 3 **[REDACTED]** 4 **[REDACTED]** 5 **[REDACTED]** 6 **[REDACTED]**

FIRST HARMFUL EVENT: **1** MOST HARMFUL EVENT: **1** 99 - UNKNOWN

COLLISION WITH PERSON, VEHICLE OR OBJECT NOT FIXED: 14 - PEDESTRIAN 15 - PEDALCYCLE 16 - RAILWAY VEHICLE (TRAIN, ENGINE) 17 - ANIMAL - FARM 18 - ANIMAL - DEER 19 - ANIMAL - OTHER 20 - MOTOR VEHICLE IN TRANSPORT 21 - PARKED MOTOR VEHICLE 22 - WORK ZONE MAINTENANCE EQUIPMENT 23 - STRUCK BY FALLING, SHIFTING CARGO OR ANYTHING SET IN MOTION BY A MOTOR VEHICLE 24 - OTHER MOVABLE OBJECT

COLLISION WITH FIXED OBJECT: 25 - IMPACT ATTENUATOR/CRASH CUSHION 26 - BRIDGE OVERHEAD STRUCTURE 27 - BRIDGE PIER OR ABUTMENT 28 - BRIDGE PARAPET 29 - BRIDGE RAIL 30 - GUARDRAIL FACE 31 - GUARDRAIL END 32 - PORTABLE BARRIER 33 - MEDIAN CABLE BARRIER 34 - MEDIAN GUARDRAIL BARRIER 35 - MEDIAN CONCRETE BARRIER 36 - MEDIAN OTHER BARRIER 37 - TRAFFIC SIGN POST 38 - OVERHEAD SIGN POST 39 - LIGHT/LUMINARIES SUPPORT 40 - UTILITY POLE 41 - OTHER POST, POLE OR SUPPORT 42 - CULVERT 43 - CURB 44 - DITCH 45 - EMBANKMENT 46 - FENCE 47 - MAILBOX 48 - TREE 49 - FIRE HYDRANT 50 - WORK ZONE MAINTENANCE EQUIPMENT 51 - WALL, BUILDING, TUNNEL 52 - OTHER FIXED OBJECT

UNIT SPEED: **[REDACTED]** POSTED SPEED: **[REDACTED]** TRAFFIC CONTROL: **[REDACTED]**

01 - NO CONTROLS 02 - STOP SIGN 03 - YIELD SIGN 04 - TRAFFIC SIGNAL 05 - TRAFFIC FLASHERS 06 - SCHOOL ZONE 07 - RAILROAD CROSSBUCKS 08 - RAILROAD FLASHERS 09 - RAILROAD GATES 10 - CONSTRUCTION BARRICADE 11 - PERSON (FLAGGER, OFFICER) 12 - PAVEMENT MARKINGS 13 - CROSSWALK LINES 14 - WALK/DON'T WALK 15 - OTHER 16 - NOT REPORTED

UNIT DIRECTION: FROM **4** TO **3** 1 - NORTH 2 - SOUTH 3 - EAST 4 - WEST 5 - NORTHEAST 6 - NORTHWEST 7 - SOUTHEAST 8 - SOUTHWEST 9 - UNKNOWN



LOCAL REPORT NUMBER 15-19528	REPORTING AGENCY MASON P.D.	DATE OF CRASH M 6   D 16   Y 15
IN COUNTY OF WARREN	CRASH LOCATION 122 SOUTH EAST ST	

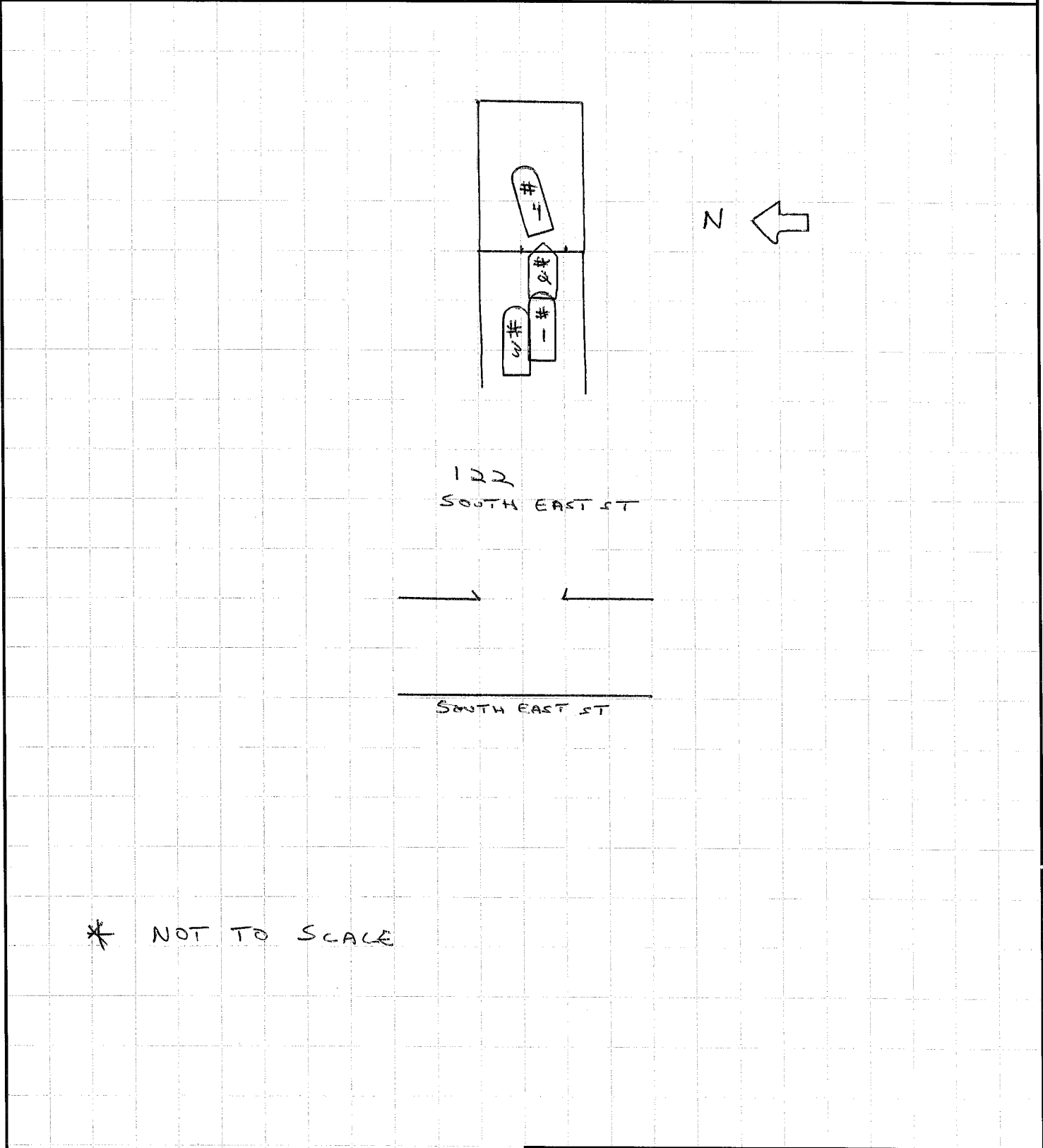

OFFICER'S SIGNATURE X N. Felt	BADGE NUMBER 46
----------------------------------	--------------------



LOCAL REPORT NUMBER 15-19528	REPORTING AGENCY MASON P.D.	DATE OF CRASH M 6   D 16   Y 15
---------------------------------	--------------------------------	------------------------------------

FOR LOCAL USE ONLY - DO NOT SUBMIT TO THE STATE EXCEPT FOR FATAL CRASHES

I, BRADFORD A. WEESNER HEREBY MAKE THIS VOLUNTARY STATEMENT TO  
PRINTED

N. FANTINI AT 122 SOUTH EAST ST.  
OFFICER'S NAME LOCATION

WE ARRIVED AT THE ABOVE LOCATION TO RETRIEVE A FIRE VEHICLE. WHEN WE ARRIVED WE DISCOVERED THAT THE VEHICLE WAS IN A DAMAGE & THAT WE NEEDED TO HAVE ANOTHER VEHICLE. FF BENNETT GOT UP ON THE DRIVERS SIDE STEP & ATTEMPTED TO LOCATE THE SWITCHES. I WAS STANDING BY THE PASSENGER DOOR OPEN. WHEN WE WERE UNABLE TO LOCATE THE BATTERY SWITCH, I CLOSED THE DOOR AND STARTED TO WALK AWAY. AT THAT IS WHEN I HEARD THE ENGINE TICK OVER & THE TRUCK STARTED MOVING FORWARD. I JUMPED THROUGH A SIDE DOOR TO SAFETY. AFTER THE TRUCK STOPPED, I DETERMINED THAT FF BENNETT WAS STUCK BETWEEN THE VEHICLES. I THEN RE-ENTERED THE VEHICLE FROM THE ~~FF~~ PASSENGER SIDE AND STARTED TO ASSESS FF BENNETT. I THEN TURNED OFF THE BATTERY SWITCH WHICH WAS NOW OK.

ADDRESS OF WITNESS 4420 N. MASON-MONTGOMERY RD.	PHONE 513-335-8141
SIGNATURE OF WITNESS <i>Bradford A. Weesner</i> 8/24/15	OFFICER'S SIGNATURE X <i>N. Fantini</i>



LOCAL REPORT NUMBER 15-19528	REPORTING AGENCY MASON P.D.	DATE OF CRASH M 6   D 16   Y 2015
---------------------------------	--------------------------------	--------------------------------------

**FOR LOCAL USE ONLY - DO NOT SUBMIT TO THE STATE EXCEPT FOR FATAL CRASHES**

I, DOUG ROLPH HEREBY MAKE THIS VOLUNTARY STATEMENT TO  
PRINTED

N. FANTINI AT 122 SOUTH EAST ST.  
OFFICER'S NAME LOCATION

WHILE ATTEMPTING TO MOVE A FIRE TRUCK. JAKE BENNETT WAS LOOKING INSIDE THE CAB FROM THE EXTERIOR TO SEE IF HE COULD START IT. I WAS ON THE PASSENGER SIDE ON THE GROUND. I HEARD THE ENGINE START & INSTANTLY THE TRUCK MOVED 4-5' FORWARD INTO THE SLEEP IN FRONT. JAKE WAS IMMEDIATELY ASKED IF HE WAS "OK". HE SAID HE DOESN'T KNOW & FREED HIMSELF FROM IN BETWEEN THE TWO TRUCKS. AN OBVIOUS INJURY WAS NOTED. BATT. 51 NOTIFIED.

ADDRESS OF WITNESS 4420 MASON MONTGOMERY RD.	PHONE 937-790-0581
SIGNATURE OF WITNESS X 	OFFICER'S SIGNATURE X N. 