



# TRAFFIC CRASH REPORT

LOCAL REPORT NUMBER \* **20113-14259**

CRASH SEVERITY **3** 1 - FATAL 2 - INJURY 3 - PDO

HIT/SKIP  1 - SOLVED  2 - UNSOLVED

PHOTOS TAKEN  OH-2  OH-1P  OH-3  OTHER

PDO UNDER STATE REPORTABLE DOLLAR AMOUNT

PRIVATE PROPERTY

REPORTING AGENCY NCIC \* **0813041** REPORTING AGENCY NAME \* **MASON POLICE**

NUMBER OF UNITS **02** UNIT IN ERROR **01** 98 - ANIMAL 99 - UNKNOWN

COUNTY \*  CITY \*  VILLAGE \*  TOWNSHIP \* **MASON**

CRASH DATE \* TIME OF CRASH DAY OF WEEK

DEGREES / MINUTES / SECONDS LONGITUDE **0 / 0 / 0** OR DECIMAL DEGREES LONGITUDE **39.1336044**

LATITUDE **0 / 0 / 0** OR DECIMAL DEGREES LATITUDE **78.4290711**

ROADWAY DIVISION  DIVIDED  UNDIVIDED

DIVIDED LANE DIRECTION OF TRAVEL  N - NORTHBOUND  E - EASTBOUND  S - SOUTHBOUND  W - WESTBOUND

NUMBER OF TRU LANE **02**

ROAD TYPES OR MILEPOST \*  
 AL - ALLEY CR - CIRCLE HE - HEIGHTS MP - MILEPOST PL - PLACE ST - STREET WA - WAY  
 AV - AVENUE CT - COURT HW - HIGHWAY PK - PARKWAY RD - ROAD TE - TERRACE  
 BL - BOULEVARD DR - DRIVE LA - LANE PI - PINE SQ - SQUARE TL - TRAIL

LOCATION ROUTE NUMBER  LOCATION ROUTE TYPE

LOC PREFIX  N, S, E, W

LOCATION ROAD NAME **WESTERN ROW**

LOCATION ROAD TYPE

ROUTE TYPES \*  
 IR - INTERSTATE ROUTE (GAL. TURNPIKE) CR - NUMBERED COUNTY ROUTE  
 US - US ROUTE TR - NUMBERED TOWNSHIP ROUTE  
 SR - STATE ROUTE

DISTANCE FROM REFERENCE  MILES  FEET  YARDS

DIR FROM REF  N, S, E, W

REFERENCE ROUTE TYPE

REFERENCE ROUTE NUMBER

REF PREFIX  N, S, E, W

REFERENCE NAME (ROAD, MILEPOST, HOUSE #) **TYLERSVILLE R**

REFERENCE ROAD TYPE

REFERENCE POINT USED  1 - INTERSECTION  2 - MILE POST  3 - HOUSE NUMBER

CRASH LOCATION  01 - NOT AN INTERSECTION  02 - FOUR-WAY INTERSECTION  03 - T-INTERSECTION  04 - Y-INTERSECTION  05 - TRAFFIC CIRCLE/RONDABOUT

06 - FIVE-POINT, OR MORE  07 - ON RAMP  08 - OFF RAMP  09 - CROSSOVER  10 - DRIVEWAY/ALLEY ACCESS

11 - RAILWAY GRADE CROSSING  12 - SHARED-USE PATHS OR TRAILS  99 - UNKNOWN

INTERSECTION RELATED

LOCATION OF FIRST HARMFUL EVENT  1 - ON ROADWAY  2 - ON SHOULDER  3 - IN MEDIAN  4 - ON ROADSIDE  5 - ON GORE  6 - OUTSIDE TRAFFICWAY  9 - UNKNOWN

ROAD CONTOUR  1 - STRAIGHT LEVEL  2 - STRAIGHT GRADE  3 - CURVE LEVEL  4 - CURVE GRADE  9 - UNKNOWN

ROAD CONDITIONS PRIMARY  SECONDARY

01 - DRY  02 - WET  03 - SNOW  04 - ICE  05 - SAND, MUD, DIRT, OIL, GRAVEL  06 - WATER (STANDING, MOVING)  07 - SLUSH  08 - DEBRIS\*  09 - RUT, HOLES, BUMPS, UNEVEN PAYEMENT\*  10 - OTHER  99 - UNKNOWN

\* Secondary Condition Only

MANNER OF CRASH COLLISION/IMPACT  1 - NOT COLLISION BETWEEN TWO MOTOR VEHICLES IN TRANSPORT  2 - REAR-END  3 - HEAD-ON  4 - REAR-TO-REAR  5 - BACKING  6 - ANGLE  7 - SIDESWIPE, SAME DIRECTION  8 - SIDESWIPE, OPPOSITE DIRECTION  9 - UNKNOWN

WEATHER  1 - CLEAR  2 - CLOUDY  3 - FOG, SMOG, SMOKE  4 - RAIN  5 - SLEET, HAIL  6 - SNOW  7 - SEVERE CROSSWINDS  8 - BLOWING SAND, SOIL, DIRT, SNOW  9 - OTHER/UNKNOWN

ROAD SURFACE  1 - CONCRETE  2 - BLACKTOP, BITUMINOUS, ASPHALT  3 - BRICK/BLOCK  4 - SLAG, GRAVEL, STONE  5 - DIRT  6 - OTHER

LIGHT CONDITIONS PRIMARY  SECONDARY

1 - DAYLIGHT  2 - DAWN  3 - DUSK  4 - DARK - LIGHTED ROADWAY  5 - DARK - ROADWAY NOT LIGHTED  6 - DARK - UNKNOWN ROADWAY LIGHTING  7 - GLARE\*  8 - OTHER  9 - UNKNOWN

SCHOOL BUS RELATED  SCHOOL ZONE RELATED  YES, SCHOOL BUS DIRECTLY INVOLVED  YES, SCHOOL BUS INDIRECTLY INVOLVED

\* Secondary Condition Only

WORK ZONE RELATED

WORKERS PRESENT  LAW ENFORCEMENT PRESENT (OFFICER/VEHICLE)  LAW ENFORCEMENT PRESENT (VEHICLE ONLY)

TYPE OF WORK ZONE  1 - LANE CLOSURE  2 - LANE SHIFT/CROSSOVER  3 - WORK ON SHOULDER OR MEDIAN  4 - INTERMITTENT OR MOVING WORK  5 - OTHER

LOCATION OF CRASH IN WORK ZONE  1 - BEFORE THE FIRST WORK ZONE WARNING SIGN  2 - ADVANCE WARNING AREA  3 - TRANSITION AREA  4 - ACTIVITY AREA  5 - TERMINATION AREA

NARRATIVE

**UNIT #1 STRUCK UNIT #2 FROM BEHIND ON WESTERN ROW ROAD AT TYLERSVILLE ROAD. MINOR DAMAGE TO BOTH VEHICLES RESULTED.**

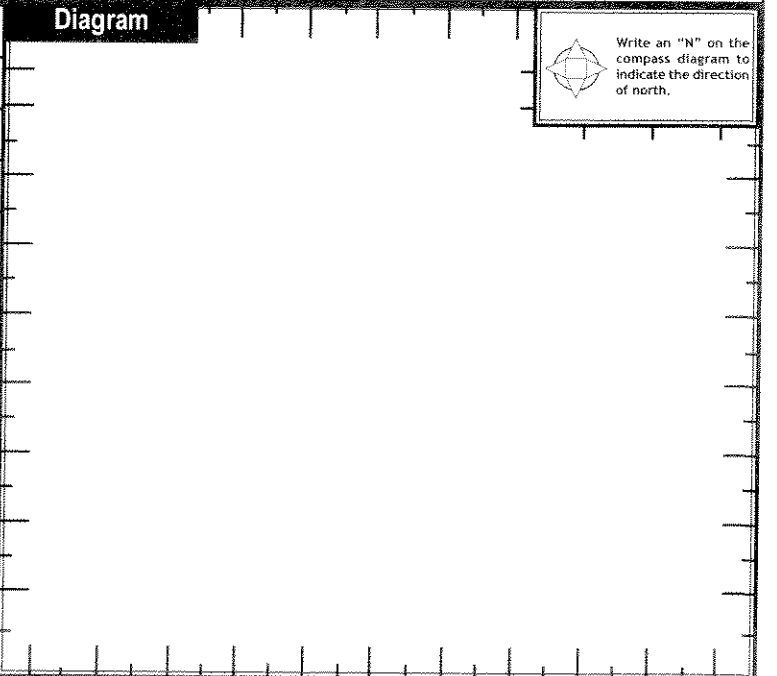

REPORT TAKEN BY  POLICE AGENCY  MOTORIST  SUPPLEMENT (CORRECTION OR ADDITION TO AN EXISTING REPORT SENT TO ODPSS)

DATE CRASH REPORTED **05/21/2013** TIME CRASH REPORTED **0845** DISPATCH TIME **0849.5** ARRIVAL TIME **1055** TIME CLEARED **1093.0** OTHER INVESTIGATION TIME **115** TOTAL MINUTES **160**

OFFICER'S NAME **PTI A. FARRAR** OFFICER'S BADGE NUMBER **1047** CHECKED BY **PH ELD**

PAGE OF



# UNIT

LOCAL REPORT NUMBER

2013-14259

UNIT NUMBER <b>011</b>	OWNER NAME: LAST, FIRST, MIDDLE <input checked="" type="checkbox"/> SAME AS DRIVER	OWNER PHONE NUMBER - INC. AREA CODE <input checked="" type="checkbox"/> SAME AS DRIVER	DAMAGE SCALE <b>4</b>	DAMAGED AREA 
OWNER ADDRESS: CITY, STATE, ZIP <input checked="" type="checkbox"/> SAME AS DRIVER			1 - NONE	
LP STATE <b>OH</b>	LICENSE PLATE NUMBER <b>ENP2560</b>	VEHICLE IDENTIFICATION NUMBER <b>1P9K16A662718A049579</b>	2 - MINOR	
VEHICLE YEAR <b>12/2011</b>	VEHICLE MAKE <b>ACURA</b>	VEHICLE MODEL <b>TL</b>	3 - FUNCTIONAL	
VEHICLE COLOR <b>BLACK</b>	POLICY NUMBER <b>980 901211 09/07</b>	TOWED BY <b>SORA'S</b>	4 - DISABLING	
PAID OF INSURANCE SHOWN <input checked="" type="checkbox"/>	INSURANCE COMPANY <b>ALL STATE</b>		9 - UNKNOWN	

CARRIER NAME, ADDRESS, CITY, STATE, ZIP	CARRIER PHONE - INCLUDE AREA CODE
US DOT	VEHICLE WEIGHT GVWR/GCWR <b>7</b> 1 - LESS THAN OR EQUAL TO 10K LBS. 2 - 10,001 TO 26,000 LBS. 3 - MORE THAN 26,000 LBS.
HM PLACARD ID NO.	CARGO BODY TYPE <b>01</b> 01 - NO CARGO BODY TYPE/NOT APPLICABLE 02 - BUS/VAN (9-15 SEATS, INC DRIVER) 03 - BUS (16+ SEATS, INC DRIVER) 04 - VEHICLE TOWING ANOTHER VEHICLE 05 - LOGGING 06 - INTERMODAL CONTAINER CHASSIS 07 - CARGO VAN/ENCLOSED BOX 08 - GRAIN, CHIPS, GRAVEL
HM CLASS NUMBER	HAZARDOUS MATERIAL RELEASED <input type="checkbox"/>
	TRAFFICWAY DESCRIPTION <b>1</b> 1 - TWO-WAY, NOT DIVIDED 2 - TWO-WAY, NOT DIVIDED, CONTINUOUS LEFT TURN LANE 3 - TWO-WAY, DIVIDED, UNPROTECTED (PAINTED BY GRASS OR FL.) MEDIAN 4 - TWO-WAY, DIVIDED, POSITIVE MEDIAN BARRIER 5 - ONE-WAY TRAFFICWAY
	<input type="checkbox"/> HIT / SKIP UNIT

NON-MOTORIST LOCATION PRIOR TO IMPACT <b>01</b> 01 - INTERSECTION - MARKED CROSSWALK 02 - INTERSECTION - NO CROSSWALK 03 - INTERSECTION - OTHER 04 - MIDDLEBLOCK - MARKED CROSSWALK 05 - TRAVEL LANE - OTHER LOCATION 06 - BI-CYCLE LANE 07 - SHOULDER/ROADSIDE 08 - SIDEWALK 09 - MEDIAN/CROSSING ISLAND 10 - DRIVEWAY ACCESS 11 - SHARED-USE PATH OR TRAIL 12 - NON-TRAFFICWAY AREA 99 - OTHER/UNKNOWN	TYPE OF USE <b>7</b> 1 - PERSONAL 2 - COMMERCIAL 3 - GOVERNMENT <input type="checkbox"/> IN EMERGENCY RESPONSE	UNIT TYPE <b>03</b> 99 - UNKNOWN OR HIT / SKIP	PASSENGER VEHICLES (LESS THAN 9 PASSENGERS) 01 - SUB-COMPACT 02 - COMPACT 03 - MID SIZE 04 - FULL SIZE 05 - MINIVAN 06 - SPORT UTILITY VEHICLE 07 - PICKUP 08 - VAN 09 - MOTORCYCLE 10 - MOTORIZED BICYCLE 11 - SNOWMOBILE/ATV 12 - OTHER PASSENGER VEHICLE	MED/HEAVY TRUCKS OR COMBO UNITS > 10K LBS 13 - SINGLE UNIT TRUCK OR VAN 2AXLE, 6 TIRES 14 - SINGLE UNIT TRUCK/ 3+ AXLES 15 - SINGLE UNIT TRUCK / TRAILER 16 - TRUCK/TRACTOR (BOBTAIL) 17 - TRACTOR/SEMI-TRAILER 18 - TRACTOR/DOUBLE 19 - TRACTOR/TRIPLES 20 - OTHER MED/HEAVY VEHICLE	BUS/VAN/LIMO (9 OR MORE INCLUDING DRIVER) 21 - BUS/VAN (9-15 SEATS, INC DRIVER) 22 - BUS (16+ SEATS, INC DRIVER) <b>Non-Motorist</b> 23 - ANIMAL WITH RIDER 24 - ANIMAL WITH BULLY, WAGON, SURREY 25 - BICYCLE/PEDALCYCLIST 26 - PEDESTRIAN/SKATER 27 - OTHER NON-MOTORIST
			<input type="checkbox"/> HAS HM PLACARD		

SPECIAL FUNCTION <b>01</b> 01 - NONE 02 - TAXI 03 - RENTAL TRUCK (OVER 10K LBS) 04 - BUS - SCHOOL (PUBLIC OR PRIVATE) 05 - BUS - TRANSIT 06 - BUS - CHARTER 07 - BUS - SHUTTLE 08 - BUS - OTHER 09 - AMBULANCE 10 - FIRE 11 - HIGHWAY/MAINTENANCE 12 - MILITARY 13 - POLICE 14 - PUBLIC UTILITY 15 - OTHER GOVERNMENT 16 - CONSTRUCTION EQUIP. 17 - FARM VEHICLE 18 - FARM EQUIPMENT 19 - MOTORHOME 20 - GOLF CART 21 - TRAIN 22 - OTHER (EXPLAIN IN NARRATIVE)	MOST DAMAGED AREA <b>03</b> 01 - NONE 02 - CENTER FRONT 03 - RIGHT FRONT 04 - RIGHT SIDE 05 - RIGHT REAR 06 - REAR CENTER 07 - LEFT REAR 08 - LEFT SIDE 09 - LEFT FRONT 10 - TOP AND WINDOWS 11 - UNDERCARRIAGE 12 - LEAD/TRAILER 13 - TOTAL(ALL AREAS) 14 - OTHER	ACTION <b>2</b> 1 - NON-CONTACT 2 - NON-COLLISION 3 - STRIKING 4 - STRUCK 5 - STRIKING/STRUCK 9 - UNKNOWN
--	---	--

PRE-CRASH ACTIONS <b>11</b> 99 - UNKNOWN	MOTORIST 01 - STRAIGHT AHEAD 02 - BACKING 03 - CHANGING LANES 04 - OVERTAKING/PASSING 05 - MAKING RIGHT TURN 06 - MAKING LEFT TURN 07 - MAKING U-TURN 08 - ENTERING TRAFFIC LANE 09 - LEAVING TRAFFIC LANE 10 - PARKED 11 - SLOWING OR STOPPED IN TRAFFIC 12 - DRIVERLESS 13 - NEGOTIATING A CURVE 14 - OTHER MOTORIST ACTION	Non-Motorist 15 - ENTERING OR CROSSING SPECIFIED LOCATION 16 - WALKING, RUNNING, JOGGING, PLAYING, CYCLING 17 - WORKING 18 - PUSHING VEHICLE 19 - APPROACHING OR LEAVING VEHICLE 20 - STANDING 21 - OTHER NON-MOTORIST ACTION
--	---	--

CONTRIBUTING CIRCUMSTANCES <b>09</b> 99 - UNKNOWN	MOTORIST 01 - NONE 02 - FAILURE TO YIELD 03 - RAN RED LIGHT 04 - RAN STOP SIGN 05 - EXCEEDED SPEED LIMIT 06 - UNEASY SPEED 07 - IMPROPER TURN 08 - LEFT OF CENTER 09 - FOLLOWED TOO CLOSELY/ACDA 10 - IMPROPER LANE CHANGE /PASSING/OFF ROAD 11 - IMPROPER BACKING 12 - IMPROPER START FROM PARKED POSITION 13 - STOPPED OR PARKED ILLEGALLY 14 - OPERATING VEHICLE IN NEGLIGENT MANNER 15 - SWERVING TO AVOID (DUE TO EXTERNAL CONDITIONS) 16 - WRONG SIDE/WRONG WAY 17 - FAILURE TO CONTROL 18 - VISION OBSTRUCTION 19 - OPERATING DEFECTIVE EQUIPMENT 20 - LOAD SHIFTING/FALLING/SPILLING 21 - OTHER IMPROPER ACTION	Non-Motorist 22 - NONE 23 - IMPROPER CROSSING 24 - DARTING 25 - LYING AND/OR ILLEGALLY IN ROADWAY 26 - FAILURE TO YIELD RIGHT OF WAY 27 - NOT VISIBLE (DARK CLOTHING) 28 - INATTENTIVE 29 - FAILURE TO OBEY TRAFFIC SIGNS /SIGNALS/OFFICER 30 - WRONG SIDE OF THE ROAD 31 - OTHER NON-MOTORIST ACTION	VEHICLE DEFECTS <b>01</b> 01 - TURN SIGNALS 02 - HEAD LAMPS 03 - TAIL LAMPS 04 - BRAKES 05 - STEERING 06 - TIRE BLOWOUT 07 - WORK OR SLICK TIRES 08 - TRAILER EQUIPMENT DEFECTIVE 09 - MOTOR TROUBLE 10 - DISABLED FROM PRIOR ACCIDENT 11 - OTHER DEFECTS
---	--	---	---

SEQUENCE OF EVENTS 1 <b>20</b> 2 3 4 5 6 FIRST HARMFUL EVENT <b>7</b> MOST HARMFUL EVENT	NON-COLLISION EVENTS 01 - OVERTURN/ROLLOVER 02 - FIRE/EXPLOSION 03 - IMMERSION 04 - JACKKNIFE 05 - CARGO/EQUIPMENT LOSS OR SHIFT 06 - EQUIPMENT FAILURE (BLOOM TIRE, BEARS FAILURE, ETC) 07 - SEPARATION OF UNITS 08 - RAN OFF ROAD RIGHT 09 - RAN OFF ROAD LEFT 10 - CROSS MEDIAN 11 - CROSS CENTER LINE OPPOSITE DIRECTION OF TRAVEL 12 - DOWNHILL RUNAWAY 13 - OTHER NON-COLLISION
--	--

COLLISION WITH PERSON, VEHICLE OR OBJECT NOT FIXED 14 - PEDESTRIAN 15 - PEDALCYCLE 16 - RAILWAY VEHICLE (TRAIN, ENGINE) 17 - ANIMAL - FARM 18 - ANIMAL - DEER 19 - ANIMAL - OTHER 20 - MOTOR VEHICLE IN TRANSPORT 21 - PARKED MOTOR VEHICLE 22 - WORK ZONE MAINTENANCE EQUIPMENT 23 - STRUCK BY FALLING, SHIFTING CARGO OR ANYTHING SET IN MOTION BY A MOTOR VEHICLE 24 - OTHER MOVABLE OBJECT 25 - IMPACT ATTENUATOR/CRASH CUSHION 26 - BRIDGE OVERHEAD STRUCTURING 27 - BRIDGE PIER OR ABUTMENT 28 - BRIDGE PARAPET 29 - BRIDGE RAIL 30 - GUARDRAIL FACE 31 - GUARDRAIL END 32 - PORTABLE BARRIER 33 - MEDIAN CABLE BARRIER 34 - MEDIAN GUARDRAIL BARRIER 35 - MEDIAN CONCRETE BARRIER 36 - MEDIAN OTHER BARRIER 37 - TRAFFIC SIGN POST 38 - OVERHEAD SIGN POST 39 - LIGHT/LUMINAIRIES SUPPORT 40 - UTILITY POLE 41 - OTHER POST, POLE OR SUPPORT 42 - CURB 43 - CURB 44 - DITCH 45 - EMBANKMENT 46 - FENCE 47 - MAILBOX 48 - TREE 49 - FIRE HYDRANT 50 - WORK ZONE MAINTENANCE EQUIPMENT 51 - WALL, BUILDING, TUNNEL 52 - OTHER FIXED OBJECT
--

UNIT SPEED <b>120</b>	POSTED SPEED <b>40</b>	TRAFFIC CONTROL <b>04</b> 01 - NO CONTROLS 02 - STOP SIGN 03 - YIELD SIGN 04 - TRAFFIC SIGNAL 05 - TRAFFIC FLASHERS 06 - SCHOOL ZONE 07 - RAILROAD CROSSBUCKS 08 - RAILROAD FLASHERS 09 - RAILROAD GATES 10 - CONSTRUCTION BARRICADE 11 - PERSON (FLAGGER, OFFICER) 12 - PAVEMENT MARKINGS 13 - CROSSWALK LINES 14 - WALK/DON'T WALK 15 - OTHER 16 - NOT REPORTED	UNIT DIRECTION FROM <b>2</b> TO <b>1</b> 1 - NORTH 2 - SOUTH 3 - EAST 4 - WEST 5 - NORTHEAST 6 - NORTHWEST 7 - SOUTHWEST 8 - SOUTHWEST 9 - UNKNOWN
--------------------------	---------------------------	--	--



# UNIT

LOCAL REPORT NUMBER

2013-14259

UNIT NUMBER <b>12</b>	OWNER NAME: LAST, FIRST, MIDDLE (SAME AS DRIVER)	OWNER PHONE NUMBER - INC. AREA CODE (SAME AS DRIVER)	DAMAGE SCALE <b>2</b>	DAMAGED AREA 
OWNER ADDRESS: CITY, STATE, ZIP (SAME AS DRIVER)	LP STATE <b>OH</b>	LICENSE PLATE NUMBER <b>FRJ3096</b>	VEHICLE IDENTIFICATION NUMBER <b>2H4KRW13H17310HSD112591</b>	# OCCUPANTS <b>1</b>
VEHICLE YEAR <b>2013</b>	VEHICLE MAKE <b>HONDA</b>	VEHICLE MODEL <b>CRV</b>	VEHICLE COLOR <b>GREY</b>	
PROOF OF INSURANCE SHOWN	INSURANCE COMPANY <b>STATE FARM</b>	POLICY NUMBER <b>4501304 E3035B</b>	TOWED BY	
CARRIER NAME, ADDRESS, CITY, STATE, ZIP			CARRIER PHONE - INCLUDE AREA CODE	

US DOT	VEHICLE WEIGHT GVWR/GCWR <b>1</b> 1 - LESS THAN OR EQUAL TO 10K LBS. 2 - 10,001 TO 26,000 LBS. 3 - MORE THAN 26,000 LBS.	CARGO BODY TYPE <b>01</b> 01 - NO CARGO BODY TYPE/NOT APPLICABLE 02 - BUS/VAN (9-15 SEATS, INC DRIVER) 03 - BUS (16+ SEATS, INC DRIVER) 04 - VEHICLE TOWING ANOTHER VEHICLE 05 - LOGGING 06 - INTERMODAL CONTAINER CHASSIS 07 - CARGO VAN/ENCLOSED BOX 08 - GRAIN, CHIPS, GRAVEL	TRAFFICWAY DESCRIPTION <b>1</b> 1 - TWO-WAY, NOT DIVIDED 2 - TWO-WAY, NOT DIVIDED, CONTINUOUS LEFT TURN LANE 3 - TWO-WAY, DIVIDED, UNPROTECTED (PAINTED OR GRASS 14 FT.) MEDIAN 4 - TWO-WAY, DIVIDED, POSITIVE MEDIAN BARRIER 5 - ONE-WAY TRAFFICWAY
HM PLACARD ID NO.	HAZARDOUS MATERIAL RELEASED	UNIT TYPE <b>06</b> 01 - SUB-COMPACT 02 - COMPACT 03 - MID SIZE 04 - FULL SIZE 05 - MINIVAN 06 - SPORT UTILITY VEHICLE 07 - PICKUP 08 - VAN 09 - MOTORCYCLE 10 - MOTORIZED BICYCLE 11 - SNOWMOBILE/ATV 12 - OTHER PASSENGER VEHICLE	Has HM Placard <input type="checkbox"/>

Non-Motorist Location Prior to Impact <b>01</b> 01 - INTERSECTION - MARKED CROSSWALK 02 - INTERSECTION - NO CROSSWALK 03 - INTERSECTION - OTHER 04 - MIDBLOCK - MARKED CROSSWALK 05 - TRAVEL LANE - OTHER LOCATION 06 - BICYCLE LANE 07 - SHOULDER/ROADSIDE 08 - SIDEWALK 09 - MEDIAN/CROSSING ISLAND 10 - DRIVEWAY ACCESS 11 - SHARED-USE PATH OR TRAIL 12 - NON-TRAFFICWAY AREA 99 - OTHER/UNKNOWN	TYPE OF USE <b>1</b> 1 - PERSONAL 2 - COMMERCIAL 3 - GOVERNMENT	Passenger Vehicles (Less than 9 passengers) <b>06</b> 01 - SUB-COMPACT 02 - COMPACT 03 - MID SIZE 04 - FULL SIZE 05 - MINIVAN 06 - SPORT UTILITY VEHICLE 07 - PICKUP 08 - VAN 09 - MOTORCYCLE 10 - MOTORIZED BICYCLE 11 - SNOWMOBILE/ATV 12 - OTHER PASSENGER VEHICLE	Med/Heavy Trucks or Combo Units > 10K LBS <b>06</b> 13 - SINGLE UNIT TRUCK OR VAN 2AXLE, 6 TIRES 14 - SINGLE UNIT TRUCK; 3+ AXLES 15 - SINGLE UNIT TRUCK / TRAILER 16 - TRUCK/TRACTOR (BEHAIL) 17 - TRACTOR/SEMI-TRAILER 18 - TRACTOR/DOUBLE 19 - TRACTOR/TROPLES 20 - OTHER MED/HEAVY VEHICLE	Bus/Van/Limo (9 or more including driver) <b>06</b> 21 - BUS/VAN (9-15 SEATS, INC DRIVER) 22 - BUS (16+ SEATS, INC DRIVER)
--	---	--	---	---

SPECIAL FUNCTION <b>01</b> 01 - NONE 02 - TAXI 03 - RENTAL TRUCK (OVER 10K LBS) 04 - BUS - SCHOOL (PUBLIC OR PRIVATE) 05 - BUS - TRANSIT 06 - BUS - CHARTER 07 - BUS - SHUTTLE 08 - BUS - OTHER	09 - AMBULANCE 10 - FIRE 11 - HIGHWAY/MAINTENANCE 12 - MILITARY 13 - POLICE 14 - PUBLIC UTILITY 15 - OTHER GOVERNMENT 16 - CONSTRUCTION EQUIP.	17 - FARM VEHICLE 18 - FARM EQUIPMENT 19 - MOTORHOME 20 - GOLF CART 21 - TRAIN 22 - OTHER (EXPLAIN IN NARRATIVE)	MOST DAMAGED AREA <b>06</b> 01 - NONE 02 - CENTER FRONT 03 - RIGHT FRONT 04 - RIGHT SIDE 05 - RIGHT REAR 06 - REAR CENTER 07 - LEFT REAR	08 - LEFT SIDE 09 - LEFT FRONT 10 - TOP AND WINDOWS 11 - UNDERCARRIAGE 12 - LOAD/TRAILER 13 - TOTAL(ALL AREAS) 14 - OTHER	99 - UNKNOWN	ACTION <b>4</b> 1 - NON-CONTACT 2 - NON-COLLISION 3 - STRUCK 4 - STRUCK 5 - STRIKING/STRUCK 9 - UNKNOWN
--	---	---	--	---	--------------	--

PRE-CRASH ACTIONS <b>11</b> 99 - UNKNOWN	MOTORIST 01 - STRAIGHT AHEAD 02 - BACKING 03 - CHANGING LANES 04 - OVERTAKING/PASSING 05 - MAKING RIGHT TURN 06 - MAKING LEFT TURN	07 - MAKING U-TURN 08 - ENTERING TRAFFIC LANE 09 - LEAVING TRAFFIC LANE 10 - PARKED 11 - SLOWING OR STOPPED IN TRAFFIC 12 - DRIVERLESS	Non-Motorist 13 - NEGOTIATING A CURVE 14 - OTHER MOTORIST ACTION	15 - ENTERING OR CROSSING SPECIFIED LOCATION 16 - WALKING, RUNNING, JOGGING, PLAYING, CYCLING 17 - WORKING 18 - PUSHING VEHICLE 19 - APPROACHING OR LEAVING VEHICLE 20 - STANDING 21 - OTHER NON-MOTORIST ACTION
--	--	---	--	--

CONTRIBUTING CIRCUMSTANCES PRIMARY <b>01</b> 01 - NONE 02 - FAILURE TO YIELD 03 - RAN RED LIGHT 04 - RAN STOP SIGN SECONDARY <b>01</b> 05 - EXCEEDED SPEED LIMIT 06 - UNSAFE SPEED 07 - IMPROPER TURN 08 - LEFT OF CENTER 09 - FOLLOWED TOO CLOSELY/ACDA 10 - IMPROPER LANE CHANGE /PASSING/OFF ROAD 99 - UNKNOWN	MOTORIST 11 - IMPROPER BACKING 12 - IMPROPER START FROM PARKED POSITION 13 - STOPPED OR PARKED ILLEGALLY 14 - OPERATING VEHICLE IN NEGLIGENCE MANNER 15 - SWERVING TO AVOID (DUE TO EXTERNAL CONDITIONS) 16 - WRONG SIDE/WRONG WAY 17 - FAILURE TO CONTROL 18 - VISION OBSTRUCTION 19 - OPERATING DEFECTIVE EQUIPMENT 20 - LOAD SHIFTING/FALLING/SPLITTING 21 - OTHER IMPROPER ACTION	Non-Motorist 22 - NONE 23 - IMPROPER CROSSING 24 - DARTING 25 - LYING AND/OR ILLEGALLY IN ROADWAY 26 - FAILURE TO YIELD RIGHT OF WAY 27 - NOT VISIBLE (DARK CLOTHING) 28 - INATTENTIVE 29 - FAILURE TO OBEY TRAFFIC SIGNS /SIGNALS/OFFICER 30 - WAGAS SIDE OF THE ROAD 31 - OTHER NON-MOTORIST ACTION	VEHICLE DEFECTS <b>01</b> 01 - TURN SIGNALS 02 - HEAD LAMPS 03 - TAIL LAMPS 04 - BRAKES 05 - SWEERING 06 - TIRE BLOWOUT 07 - WORN OR SLICK TIRES 08 - TRAILER EQUIPMENT DEFECTIVE 09 - MOTOR TROUBLE 10 - DISABLED FROM PRIOR ACCIDENT 11 - OTHER DEFECTS
--	--	---	---

SEQUENCE OF EVENTS 1 <b>20</b> 2 <b>01</b> 3 <b>01</b> 4 <b>01</b> 5 <b>01</b> 6 <b>01</b> FIRST HARMFUL EVENT <b>1</b> MOST HARMFUL EVENT <b>1</b> 99 - UNKNOWN	Non-Collision Events 01 - OVERTURN/ROLLOVER 02 - FIRE/EXPLOSION 03 - IMPESSION 04 - JACKKNIFE 05 - CARGO/EQUIPMENT LOSS OR SHIFT	06 - EQUIPMENT FAILURE (BLOWN TIRE, BRAKE FAILURE, ETC) 07 - SEPARATION OF UNITS 08 - RAN OFF ROAD RIGHT 09 - RAN OFF ROAD LEFT	10 - CROSS MEDIAN 11 - CROSS CENTER LINE OPPOSITE DIRECTION OF TRAVEL 12 - DOWNHILL RIBWAY 13 - OTHER NON-COLLISION
---	---	--	--

COLLISION WITH PERSON, VEHICLE OR OBJECT NOT FIXED 14 - PEDESTRIAN 15 - PEACYCLE 16 - RAILWAY VEHICLE (TRAIN, ENGINE) 17 - ANIMAL - FARM 18 - ANIMAL - DEER 19 - ANIMAL - OTHER 20 - MOTOR VEHICLE IN TRANSPORT	21 - PARKED MOTOR VEHICLE 22 - WORK ZONE MAINTENANCE EQUIPMENT 23 - STRUCK BY FALLING, SHIFTING CARGO OR ANYTHING SET IN MOTION BY A MOTOR VEHICLE 24 - OTHER MOVABLE OBJECT	25 - IMPACT ATTENUATOR/CRASH CUSHION 26 - BRIDGE OVERHEAD STRUCTURE 27 - BRIDGE PIER OR ABUTMENT 28 - BRIDGE PARAPET 29 - BRIDGE RAIL 30 - GUARDRAIL FACE 31 - GUARDRAIL END 32 - PORTABLE BARRIER	33 - MEDIAN CABLE BARRIER 34 - MEDIAN GUARDRAIL BARRIER 35 - MEDIAN CONCRETE BARRIER 36 - MEDIAN OTHER BARRIER 37 - TRAFFIC SIGN POST 38 - OVERHEAD SIGN POST 39 - LIGHT/LUMINAIRIES SUPPORT 40 - UTILITY POLE	41 - OTHER POST, POLE OR SUPPORT 42 - CURB 43 - CURB 44 - DITCH 45 - EMBANKMENT 46 - FENCE 47 - MAILBOX	48 - TREE 49 - FIRE HYDRANT 50 - WORK ZONE MAINTENANCE EQUIPMENT 51 - WALL, BUILDING, TUNNEL 52 - OTHER FIXED OBJECT
--	---	---	---	---	--

UNIT SPEED <b>105</b>	POSTED SPEED <b>40</b>	TRAFFIC CONTROL <b>09</b> 01 - NO CONTROL 02 - STOP SIGN 03 - YIELD SIGN 04 - TRAFFIC SIGNAL 05 - TRAFFIC FLASHERS 06 - SCHOOL ZONE 07 - RAILROAD CROSSINGS 08 - RAILROAD FLASHERS 09 - RAILROAD GATES 10 - CONSTRUCTION BARRICADE 11 - PERSON (FLAGGER, OFFICER) 12 - PAVEMENT MARKINGS	13 - CROSSWALK LINES 14 - WALK/DON'T WALK 15 - OTHER 16 - NOT REPORTED	UNIT DIRECTION FROM <b>2</b> TO <b>1</b> 1 - NORTH 2 - SOUTH 3 - EAST 4 - WEST 5 - NORTHEAST 6 - NORTHWEST 7 - SOUTHEAST 8 - SOUTHWEST 9 - UNKNOWN
--------------------------	---------------------------	---	---	--



# MOTORIST / Non-MOTORIST / OCCUPANT

LOCAL REPORT NUMBER  
**21013-14259**

Motorist/Non-Motorist

Motorist/Non-Motorist

OCCUPANT

OCCUPANT

UNIT NUMBER <b>011</b>	NAME: LAST, FIRST, MIDDLE <b>VALLABHANENI, SHEELA</b>	DATE OF BIRTH <b>0102911974</b>	AGE <b>38</b>	GENDER <b>F</b> F - FEMALE M - MALE
---------------------------	--	------------------------------------	------------------	---

ADDRESS, CITY, STATE, ZIP <b>4582 ENGLISH OAK COURT</b>	CONTACT PHONE- INCLUDE AREA CODE <b>513 289-7381</b>
--	---

INJURIES <b>1</b>	INJURED TAKEN BY <input type="checkbox"/>	EMS AGENCY <input type="checkbox"/>	MEDICAL FACILITY INJURED TAKEN TO <input type="checkbox"/>	SAFETY EQUIPMENT USED <b>04</b>	DOT COMPLIANT <input type="checkbox"/>	SEATING POSITION <b>01</b>	AIR BAG USAGE <b>1</b>	EJECTION <b>1</b>	TRAPPED <b>1</b>
----------------------	--	--	---	------------------------------------	---	-------------------------------	---------------------------	----------------------	---------------------

OL STATE <b>OH</b>	OPERATOR LICENSE NUMBER <b>UAG08324</b>	OL CLASS <b>4</b>	NO VALID OL <input type="checkbox"/>	M/C END. <input type="checkbox"/>	CONDITION <b>1</b>	ALCOHOL/DRUG SUSPECTED <b>1</b>	ALCOHOL TEST STATUS <b>1</b>	ALCOHOL TEST TYPE <b>1</b>	ALCOHOL TEST VALUE <b>1</b>	DRUG TEST STATUS <b>1</b>	DRUG TEST TYPE <b>1</b>
-----------------------	--	----------------------	---	--------------------------------------	-----------------------	------------------------------------	---------------------------------	-------------------------------	--------------------------------	------------------------------	----------------------------

OFFENSE CHARGED (LOCAL CODE) <b>333.03</b>	OFFENSE DESCRIPTION <b>ACDA</b>	CITATION NUMBER <b>74211</b>	HANDS-FREE DEVICE USED <input type="checkbox"/>	DRIVER DISTRACTED BY <b>1</b>
---	------------------------------------	---------------------------------	--	----------------------------------

UNIT NUMBER <b>012</b>	NAME: LAST, FIRST, MIDDLE <b>SADINENI, VIJAY B</b>	DATE OF BIRTH <b>0111811972</b>	AGE <b>41</b>	GENDER <b>M</b> F - FEMALE M - MALE
---------------------------	---	------------------------------------	------------------	---

ADDRESS, CITY, STATE, ZIP <b>7421 PLACID LAKE DR. APT 101</b>	CONTACT PHONE- INCLUDE AREA CODE <b>513 708-1532</b>
--	---

INJURIES <b>1</b>	INJURED TAKEN BY <input type="checkbox"/>	EMS AGENCY <input type="checkbox"/>	MEDICAL FACILITY INJURED TAKEN TO <input type="checkbox"/>	SAFETY EQUIPMENT USED <b>04</b>	DOT COMPLIANT <input type="checkbox"/>	SEATING POSITION <b>01</b>	AIR BAG USAGE <b>1</b>	EJECTION <b>1</b>	TRAPPED <b>1</b>
----------------------	--	--	---	------------------------------------	---	-------------------------------	---------------------------	----------------------	---------------------

OL STATE <b>OH</b>	OPERATOR LICENSE NUMBER <b>RU264702</b>	OL CLASS <b>4</b>	NO VALID OL <input type="checkbox"/>	M/C END. <input type="checkbox"/>	CONDITION <b>1</b>	ALCOHOL/DRUG SUSPECTED <b>1</b>	ALCOHOL TEST STATUS <b>1</b>	ALCOHOL TEST TYPE <b>1</b>	ALCOHOL TEST VALUE <b>1</b>	DRUG TEST STATUS <b>1</b>	DRUG TEST TYPE <b>1</b>
-----------------------	--	----------------------	---	--------------------------------------	-----------------------	------------------------------------	---------------------------------	-------------------------------	--------------------------------	------------------------------	----------------------------

OFFENSE CHARGED (LOCAL CODE)	OFFENSE DESCRIPTION	CITATION NUMBER	HANDS-FREE DEVICE USED <input type="checkbox"/>	DRIVER DISTRACTED BY <b>1</b>
------------------------------	---------------------	-----------------	--	----------------------------------

<b>INJURIES</b> 1 - NO INJURY / NONE REPORTED 2 - POSSIBLE 3 - NON-INCAPACITATING 4 - INCAPACITATING 5 - FATAL	<b>INJURED TAKEN BY</b> 1 - NOT TRANSPORTED / TREATED AT SCENE 2 - EMS 3 - POLICE 4 - OTHER 9 - UNKNOWN	<b>SAFETY EQUIPMENT USED</b> <b>MOTORIST</b> 01 - NONE USED - VEHICLE OCCUPANT 02 - SHOULDER BELT ONLY USED 03 - LAP BELT ONLY USED 04 - SHOULDER AND LAP BELT USED <b>NON-MOTORIST</b> 05 - CHILD RESTRAINT SYSTEM-FORWARD FACING 06 - CHILD RESTRAINT SYSTEM-REAR FACING 07 - BOOSTER SEAT 08 - HELMET USED <b>NON-MOTORIST</b> 09 - NONE USED 10 - HELMET USED 11 - REFLECTIVE PADS USED (ELBOWS, KNEES, ETC.) 12 - REFLECTIVE CLOTHING 13 - LIGHTING 14 - OTHER
---	--	--

<b>SEATING POSITION</b> 01 - FRONT - LEFT SIDE (Motorcycle Driver) 02 - FRONT - MIDDLE 03 - FRONT - RIGHT SIDE 04 - SECOND - LEFT SIDE (Motorcycle Passenger) 05 - SECOND - MIDDLE 06 - SECOND - RIGHT SIDE 07 - THIRD - LEFT SIDE (Motorcycle Side Car) 08 - THIRD - MIDDLE 09 - THIRD - RIGHT SIDE 10 - SLEEPER SECTION OF CAB/TRUCK 11 - PASSENGER IN OTHER ENCLOSED CARGO AREA (Non-Trailing Unit Such As A Bus, Pick-up with Cap) 12 - PASSENGER IN UNENCLOSED CARGO AREA 13 - TRAILING UNIT 14 - RIDING ON VEHICLE EXTERIOR (NON-TRAILING UNIT) 15 - NON-MOTORIST 16 - OTHER 99 - UNKNOWN	<b>AIR BAG USAGE</b> 1 - NOT DEPLOYED 2 - DEPLOYED FRONT 3 - DEPLOYED SIDE 4 - DEPLOYED BOTH FRONT/SIDE 5 - NOT APPLICABLE 9 - DEPLOYMENT UNKNOWN
--	---

<b>EJECTION</b> 1 - NOT EJECTED 2 - TOTALLY EJECTED 3 - PARTIALLY EJECTED 4 - NOT APPLICABLE	<b>TRAPPED</b> 1 - NOT TRAPPED 2 - EXTRICATED BY MECHANICAL MEANS 3 - EXTRICATED BY NON-MECHANICAL MEANS	<b>OPERATOR LICENSE CLASS</b> 1 - CLASS A 2 - CLASS B 3 - CLASS C 4 - REGULAR CLASS (OHIO IS "D") 5 - MC/MOPED ONLY	<b>CONDITION</b> 1 - APPARENTLY NORMAL 2 - PHYSICAL IMPAIRMENT 3 - EMOTIONAL (DEPRESSED, ANGRY, DISTURBED) 4 - ILLNESS 5 - FELL ASLEEP, FAINTED, FATIGUED 6 - UNDER THE INFLUENCE OF MEDICATIONS, DRUGS, ALCOHOL 7 - OTHER	<b>ALCOHOL/DRUG SUSPECTED</b> 1 - NONE 2 - YES - ALCOHOL SUSPECTED 3 - YES - HBD NOT IMPAIRED 4 - YES - DRUGS SUSPECTED 5 - YES - ALCOHOL AND DRUGS SUSPECTED
--	---	--	---	--

<b>ALCOHOL TEST STATUS</b> 1 - NONE GIVEN 2 - TEST REFUSED 3 - TEST GIVEN, CONTAMINATED SAMPLE/UNUSABLE 4 - TEST GIVEN, RESULTS KNOWN 5 - TEST GIVEN, RESULTS UNKNOWN	<b>ALCOHOL TEST TYPE</b> 1 - NONE 2 - BLOOD 3 - URINE 4 - BREATH 5 - OTHER	<b>DRUG TEST STATUS</b> 1 - NONE GIVEN 2 - TEST REFUSED 3 - TEST GIVEN, CONTAMINATED SAMPLE/UNUSABLE 4 - TEST GIVEN, RESULTS KNOWN 5 - TEST GIVEN, RESULTS UNKNOWN	<b>DRUG TEST TYPE</b> 1 - NONE 2 - BLOOD 3 - URINE 4 - OTHER	<b>DRIVER DISTRACTED BY</b> 1 - NO DISTRACTION REPORTED 2 - PHONE 3 - TEXTING/E-MAILING 4 - ELECTRONIC COMMUNICATION DEVICE 5 - OTHER ELECTRONIC DEVICE (Navigation Device, Radio, DVD) 6 - OTHER INSIDE THE VEHICLE 7 - EXTERNAL DISTRACTION
--	---	---	--	--

UNIT NUMBER	NAME: LAST, FIRST, MIDDLE	DATE OF BIRTH	AGE	GENDER F - FEMALE M - MALE
-------------	---------------------------	---------------	-----	----------------------------------

ADDRESS, CITY, STATE, ZIP	CONTACT PHONE- INCLUDE AREA CODE
---------------------------	----------------------------------

INJURIES	INJURED TAKEN BY	EMS AGENCY	MEDICAL FACILITY INJURED TAKEN TO	SAFETY EQUIPMENT USED	DOT COMPLIANT MOTORCYCLE HELMET	SEATING POSITION	AIR BAG USAGE	EJECTION	TRAPPED
----------	------------------	------------	-----------------------------------	-----------------------	------------------------------------	------------------	---------------	----------	---------

UNIT NUMBER	NAME: LAST, FIRST, MIDDLE	DATE OF BIRTH	AGE	GENDER F - FEMALE M - MALE
-------------	---------------------------	---------------	-----	----------------------------------

ADDRESS, CITY, STATE, ZIP	CONTACT PHONE- INCLUDE AREA CODE
---------------------------	----------------------------------

INJURIES	INJURED TAKEN BY	EMS AGENCY	MEDICAL FACILITY INJURED TAKEN TO	SAFETY EQUIPMENT USED	DOT COMPLIANT MOTORCYCLE HELMET	SEATING POSITION	AIR BAG USAGE	EJECTION	TRAPPED
----------	------------------	------------	-----------------------------------	-----------------------	------------------------------------	------------------	---------------	----------	---------

OHIO TRAFFIC ACCIDENT - DIAGRAM/NARRATIVE CONTINUATION

OH-2

LOCAL REPORT NUMBER 2013-14259	REPORTING AGENCY MASON POLICE	DATE OF ACCIDENT M 5 10 21 13
IN COUNTY OF WARREN	ACCIDENT LOCATION WESTERN ROW / TYLERSVILLE / STITT RD	

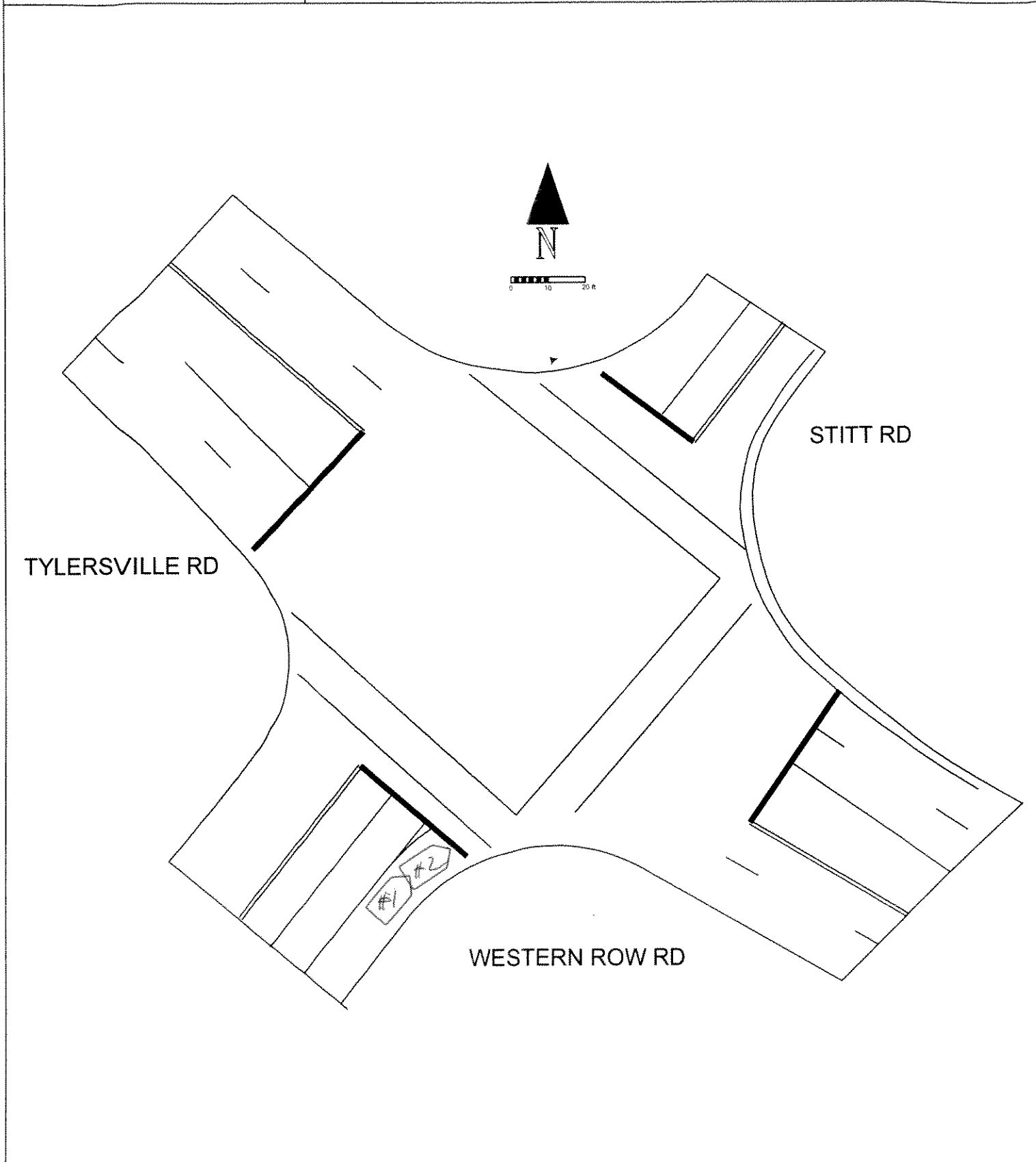

OFFICER'S SIGNATURE Ptl. Edward	BADGE NUMBER 1047
------------------------------------	----------------------



LOCAL REPORT NUMBER 2013-14259	REPORTING AGENCY Mason Police Department	DATE OF CRASH M 5/24/13
-----------------------------------	---	----------------------------

FOR LOCAL USE ONLY - DO NOT SUBMIT TO THE STATE EXCEPT FOR FATAL CRASHES

Vijay B. SADINENI HEREBY MAKE THIS VOLUNTARY STATEMENT TO  
PRINTED

Ptl. Dan Edwards AT WESTERN ROW / TOLLAND AVE  
OFFICER'S NAME LOCATION

DESCRIBE WHAT HAPPENED:

I got rear ended @ Western Row & Tullaville Rd intersection, by Sheda Vallabhaneni, as I stopped for on coming traffic @ the intersection.

- Q. What was your speed at the time of the crash? A. < 5 mph
- Q. What was your direction of travel? A. Western Row / Tullaville Ave North
- Q. Were you wearing a seatbelt? A. Yes
- Q. Were you talking on a cell phone at the time of the crash? A. No
- Q. Were you injured due to the crash? A. No

7421 PLACID LAKE DR, 101 MASON OH 45040  
ADDRESS OF WITNESS PHONE 513-708-1556

S. Vijay Sadek 05/24/2013 OFFICER'S SIGNATURE  Ptl. Dan Edwards



LOCAL REPORT NUMBER 2013-14259	REPORTING AGENCY Mason Police Department	DATE OF CRASH M   D   Y
-----------------------------------	---	----------------------------

FOR LOCAL USE ONLY - DO NOT SUBMIT TO THE STATE EXCEPT FOR FATAL CRASHES

I, Sheela Vallabhaneni HEREBY MAKE THIS VOLUNTARY STATEMENT TO  
PRINTED

Ptl. Dan Edwards

AT West/en Row Rd, Mason OH  
LOCATION - 410010

OFFICER'S NAME

LOCATION

DESCRIBE WHAT HAPPENED:

Hit the front vehicle at a  
Stop light.

Q. What was your speed at the time of the crash?

A. 20

Q. What was your direction of travel?

A. north

Q. Were you wearing a seatbelt?

A. yes

Q. Were you talking on a cell phone at the time of the crash?

A. NO

Q. Were you injured due to the crash?

A. NO

ADDRESS OF WITNESS

PHONE

513 289-7381

SIGNATURE OF WITNESS

X S. Vallabhaneni

OFFICER'S SIGNATURE

X Ptl. Edwards