



Traffic Crash Report

Local Report Number *	Crash Severity	Hit/Skip
2014-000039262	3 1 - Fatal 2 - Injury 3 - PDO	1 - Solved 2 - Unsolved

Local Information		Reporting Agency NCIC *	Reporting Agency Name *	Number of Units	Unit in error
<input checked="" type="checkbox"/> Photos Taken <input type="checkbox"/> OH-2 <input type="checkbox"/> OH-1P <input type="checkbox"/> OH-3 <input type="checkbox"/> Other	<input type="checkbox"/> PDO Under State Reportable Dollar Amount	<input type="checkbox"/> Private Property	08304 MASON POLICE DEPARTMENT	02	01 98 - Animal 99 - Unknown

County *	City *	City, Village, Township *	Crash Date *	Time of Crash	Day of Week
B3	<input checked="" type="checkbox"/> City * <input type="checkbox"/> Village * <input type="checkbox"/> Township *	MASON	02082P14	1818	MON

Degrees / Minutes / Seconds	Latitude	Longitude	Decimal Degrees	Latitude	Longitude
	39° 21' 33.58"	-84° 18' 33.15"		39.359329	-84.309208

Roadway Division	Divided Lane Direction of Travel	Number of Thru Lanes	Road Types or Milepost ²
<input type="checkbox"/> Divided <input checked="" type="checkbox"/> Undivided	<input type="checkbox"/> N - Northbound E - Eastbound <input type="checkbox"/> S - Southbound W - Westbound	04	AL - Alley CR - Circle HE - Heights MP - Milepost PL - Place ST - Street WA - Way AV - Avenue CT - Court HW - Highway PK - Parkway RD - Road TE - Terrace BL - Boulevard DR - Drive LA - Lane PI - Pike SQ - Square TL - Trail

Location Route Type ¹	Location Route Number	Loc Prefix	Location Road Name	Location Road Type ²	Route Types ³
		S	MASON MONTGOMERY	AD	IR - Interstate Route (inc. turnpike) CR - Numbered County Route US - US Route TR - Numbered Township Route SR - State Route

Distance From Reference	Dir From Ref	Reference Route Type ¹	Reference Route Number	Ref Prefix	Reference Name (Road, Milepost, House #)	Reference Road Type ²
<input type="checkbox"/> Miles <input type="checkbox"/> Feet <input type="checkbox"/> Yards	<input type="checkbox"/> N,S <input type="checkbox"/> E,W				# 113	

Reference Point Used	Crash Location	Intersection Related	Location of First Harmful Event
3 1 - Intersection 2 - Mile Post 3 - House Number	01 01 - Not an intersection 02 - Four-way Intersection 03 - T-Intersection 04 - Y-Intersection 05 - Traffic Circle/Roundabout 06 - Five-point, or more 07 - On Ramp 08 - Off Ramp 09 - Crossover 10 - Driveway/Alley Access 11 - Railway Grade Crossing 12 - Shared-Use Paths or Trails 99 - Unknown	<input type="checkbox"/>	1 1 - On Roadway 2 - On Shoulder 3 - In Median 4 - On Roadside 5 - On Gore 6 - Outside Trafficway 9 - Unknown

Road Contour	Road Conditions	Weather
2 1 - Straight Level 2 - Straight Grade 3 - Curve Level 4 - Curve Grade 9 - Unknown	02 Primary Secondary 01 - Dry 02 - Wet 03 - Snow 04 - Ice 05 - Sand, Mud, Dirt, Oil, Gravel 06 - Water (Standing, Moving) 07 - Slush 08 - Debris* 09 - Rut, Holes, Bumps, Uneven Pavement* 10 - Other 99 - Unknown	4 1 - Clear 2 - Cloudy 3 - Fog, Smog, Smoke 4 - Rain 5 - Sleet, Hail 6 - Snow 7 - Severe Crosswinds 8 - Blowing Sand, Soil, Dirt, Snow 9 - Other/Unknown

Manner of Crash Collision/Impact	Weather
6 1 - Not Collision Between Two Motor Vehicles In Transport 2 - Rear-End 3 - Head-On 4 - Rear-to-Rear 5 - Backing 6 - Angle 7 - Sideswipe, Same Direction 8 - Sideswipe, Opposite Direction 9 - Unknown	4 1 - Clear 2 - Cloudy 3 - Fog, Smog, Smoke 4 - Rain 5 - Sleet, Hail 6 - Snow 7 - Severe Crosswinds 8 - Blowing Sand, Soil, Dirt, Snow 9 - Other/Unknown

Road Surface	Light Conditions	School Bus Related
2 1 - Concrete 2 - Blacktop, Bituminous, Asphalt 3 - Brick/Block 4 - Slag, Gravel, Stone 5 - Dirt 6 - Other	4 Primary Secondary 1 - Daylight 2 - Dawn 3 - Dusk 4 - Dark - Lighted Roadway 5 - Dark - Roadway Not Lighted 6 - Dark - Unknown Roadway Lighting 7 - Glare* 8 - Other	<input type="checkbox"/> School Bus Related <input type="checkbox"/> Yes, School Bus Directly Involved <input type="checkbox"/> Yes, School Bus Indirectly Involved

Work Zone Related	Type of Work Zone	Location of Crash in Work Zone
<input type="checkbox"/> Workers Present <input type="checkbox"/> Law Enforcement Present (Officer/Vehicle) <input type="checkbox"/> Law Enforcement Present (Vehicle Only)	<input type="checkbox"/> 1 - Lane Closure 2 - Lane Shift/Crossover 3 - Work on Shoulder or Median 4 - Intermittent or Moving Work 5 - Other	<input type="checkbox"/> 1 - Before the First Work Zone Warning Sign 2 - Advance Warning Area 3 - Transition Area 4 - Activity Area 5 - Termination Area

Narrative

UNIT # 2 WAS TRAVELLING SOUTH ON MASON - MONTGOMERY ROAD NEAR # 113 WHEN UNIT # 1 ATTEMPTED TO TURN LEFT OUT OF #113 AND FAILED TO YIELD THE RIGHT OF WAY TO UNIT # 2, CAUSING UNIT # 2 TO STRIKE UNIT # 1

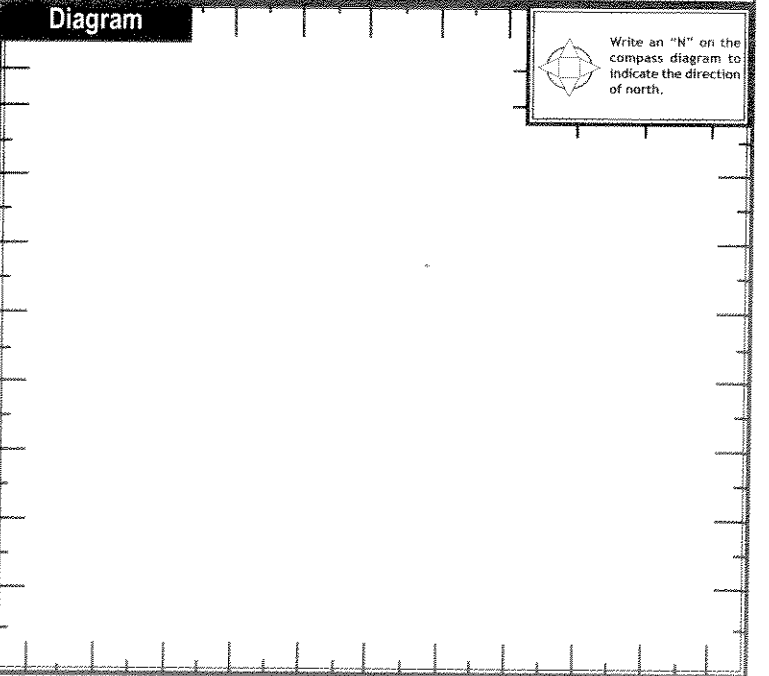

Report Taken By	Supplement (Correction or Addition to an Existing Report Sent to ODPS)	Date Crash Reported	Time Crash Reported	Dispatch Time	Arrival Time	Time Cleared	Other Investigation Time	Total Minutes
<input checked="" type="checkbox"/> Police Agency <input type="checkbox"/> Motorist	<input type="checkbox"/>	112082914	11818	11820	11821	11855	26	60
Officer's Name *	Officer's Badge Number	Checked By	Page 1 of 4					
MJ SECHRIST	1024	50						



MOTORIST / Non-MOTORIST / OCCUPANT

LOCAL REPORT NUMBER

20114-390039262

MOTORIST/Non-MOTORIST

UNIT NUMBER 01	NAME: LAST, FIRST, MIDDLE DAVIS, DAVID, GALEN STEPHEN	DATE OF BIRTH 01/14/1989	AGE 25	GENDER M - MALE
ADDRESS, CITY, STATE, ZIP 1 CHICKMANGA COURT WEST CRESTER, OHIO 45069			CONTACT PHONE - INCLUDE AREA CODE 513-628-3747	
INJURIES 1	INJURED TAKEN BY	EMS AGENCY	MEDICAL FACILITY INJURED TAKEN TO	SAFETY EQUIPMENT USED 04
DOT COMPLIANT MOTORCYCLE HELMET	SEATING POSITION 01	AIR BAG USAGE 1	EJECTION 1	TRAPPED 1
OL STATE OH	OPERATOR LICENSE NUMBER TH219691	OL CLASS 4	ALCOHOL/DRUG SUSPECTED 1	ALCOHOL TEST STATUS 1
ALCOHOL TEST TYPE 1	ALCOHOL TEST VALUE	DRUG TEST STATUS 1	DRUG TEST TYPE	
OFFENSE CHARGED 331.22	OFFENSE DESCRIPTION RIGHT OF WAY FROM PRIV. PROP	CITATION NUMBER 76676	HANDS-FREE DEVICE USED	DRIVER DISTRACTED BY

MOTORIST/Non-MOTORIST

UNIT NUMBER 012	NAME: LAST, FIRST, MIDDLE NECAMP, NICHOLAS, G	DATE OF BIRTH 12/28/1961	AGE 52	GENDER M - MALE
ADDRESS, CITY, STATE, ZIP 6184 MERE DRIVE MASON, OHIO 45040			CONTACT PHONE - INCLUDE AREA CODE 513-678-2962	
INJURIES 1	INJURED TAKEN BY	EMS AGENCY	MEDICAL FACILITY INJURED TAKEN TO	SAFETY EQUIPMENT USED 04
DOT COMPLIANT MOTORCYCLE HELMET	SEATING POSITION 01	AIR BAG USAGE 1	EJECTION 1	TRAPPED 1
OL STATE OH	OPERATOR LICENSE NUMBER RU204049	OL CLASS 4	ALCOHOL/DRUG SUSPECTED 1	ALCOHOL TEST STATUS 1
ALCOHOL TEST TYPE 1	ALCOHOL TEST VALUE	DRUG TEST STATUS 1	DRUG TEST TYPE	
OFFENSE CHARGED	OFFENSE DESCRIPTION	CITATION NUMBER	HANDS-FREE DEVICE USED	DRIVER DISTRACTED BY

INJURIES	INJURED TAKEN BY	SAFETY EQUIPMENT USED	99 - UNKNOWN SAFETY EQUIPMENT	Non-Motorist
1 - NO INJURY / NONE REPORTED	1 - NOT TRANSPORTED / TREATED AT SCENE	MOTORIST	01 - NONE USED - VEHICLE OCCUPANT	09 - NONE USED
2 - POSSIBLE	2 - EMS	02 - SHOULDER BELT ONLY USED	05 - CHILD RESTRAINT SYSTEM - FORWARD FACING	10 - HELMET USED
3 - NON-INCAPACITATING	3 - POLICE	03 - LAP BELT ONLY USED	06 - CHILD RESTRAINT SYSTEM - REAR FACING	11 - PROTECTIVE PADS USED (ELBOWS, KNEES, ETC)
4 - INCAPACITATING	4 - OTHER	04 - SHOULDER AND LAP BELT USED	07 - BOOSTER SEAT	12 - REFLECTIVE CLOTHING
5 - FATAL	9 - UNKNOWN		08 - HELMET USED	13 - LIGHTING
				14 - OTHER

SEATING POSITION	07 - THIRD - LEFT SIDE (MOTORCYCLE SEAT)	12 - PASSENGER IN UNENCLOSED CARGO AREA	AIR BAG USAGE
01 - FRONT - LEFT SIDE (MOTORCYCLE DRIVER)	08 - THIRD - MIDDLE	13 - TRAILING UNIT	1 - NOT DEPLOYED
02 - FRONT - MIDDLE	09 - THIRD - RIGHT SIDE	14 - RIDING ON VEHICLE EXTERIOR (NON-TRAILING UNIT)	2 - DEPLOYED FRONT
03 - FRONT - RIGHT SIDE	10 - SLEEPER SECTION OF CAB (TRUCK)	15 - NON-MOTORIST	3 - DEPLOYED SIDE
04 - SECOND - LEFT SIDE (MOTORCYCLE PASSENGER)	11 - PASSENGER IN OTHER ENCLOSED CARGO AREA (NON-TRAILING UNIT SUCH AS A SUB, PICKUP W/RY CAP)	16 - OTHER	4 - DEPLOYED BOTH FRONT/SIDE
05 - SECOND - MIDDLE		99 - UNKNOWN	5 - NOT APPLICABLE
06 - SECOND - RIGHT SIDE			9 - DEPLOYMENT UNKNOWN
EJECTION	TRAPPED	OPERATOR LICENSE CLASS	CONDITION
1 - NOT EJECTED	1 - NOT TRAPPED	1 - CLASS A	1 - APPARENTLY NORMAL
2 - TOTALLY EJECTED	2 - EXTRICATED BY MECHANICAL MEANS	2 - CLASS B	2 - PHYSICAL IMPAIRMENT
3 - PARTIALLY EJECTED	3 - EXTRICATED BY NON-MECHANICAL MEANS	3 - CLASS C	3 - EMOTIONAL (DEPRESSED, ANGRY, DISTURBED)
4 - NOT APPLICABLE		4 - REGULAR CLASS (OHIO H/D)	4 - ILLNESS
		5 - MC/MOPED ONLY	5 - FELL ASLEEP, FAINTED, FATIGUED
			6 - UNDER THE INFLUENCE OF MEDICATIONS, DRUGS, ALCOHOL
			7 - OTHER
ALCOHOL TEST STATUS	ALCOHOL TEST TYPE	DRUG TEST STATUS	DRUG TEST TYPE
1 - NONE GIVEN	1 - NONE	1 - NONE GIVEN	1 - NONE
2 - TEST REFUSED	2 - BLOOD	2 - TEST REFUSED	2 - BLOOD
3 - TEST GIVEN, CONTAMINATED SAMPLE/UNUSABLE	3 - URINE	3 - TEST GIVEN, CONTAMINATED SAMPLE/UNUSABLE	3 - URINE
4 - TEST GIVEN, RESULTS KNOWN	4 - BREATH	4 - TEST GIVEN, RESULTS KNOWN	4 - OTHER
5 - TEST GIVEN, RESULTS UNKNOWN	5 - OTHER	5 - TEST GIVEN, RESULTS UNKNOWN	
DRIVER DISTRACTED BY	1 - NO DISTRACTION REPORTED	6 - OTHER INSIDE THE VEHICLE	
	2 - PHONE	7 - EXTERNAL DISTRACTION	
	3 - TEXTING/E-MAILING		
	4 - ELECTRONIC COMMUNICATION DEVICE		
	5 - OTHER ELECTRONIC DEVICE (NAVIGATION DEVICE, RADIO, DVD)		

OCCUPANT

UNIT NUMBER 012	NAME: LAST, FIRST, MIDDLE NECAMP, PATRICK	DATE OF BIRTH 11/23/1997	AGE 16	GENDER M - MALE
ADDRESS, CITY, STATE, ZIP 6184 MERE DRIVE MASON OHIO 45040			CONTACT PHONE - INCLUDE AREA CODE 513-678-2962	
INJURIES 1	INJURED TAKEN BY	EMS AGENCY	MEDICAL FACILITY INJURED TAKEN TO	SAFETY EQUIPMENT USED 04
DOT COMPLIANT MOTORCYCLE HELMET	SEATING POSITION 03	AIR BAG USAGE 1	EJECTION 1	TRAPPED 1

OCCUPANT

UNIT NUMBER	NAME: LAST, FIRST, MIDDLE	DATE OF BIRTH	AGE	GENDER
ADDRESS, CITY, STATE, ZIP			CONTACT PHONE - INCLUDE AREA CODE	
INJURIES	INJURED TAKEN BY	EMS AGENCY	MEDICAL FACILITY INJURED TAKEN TO	SAFETY EQUIPMENT USED
DOT COMPLIANT MOTORCYCLE HELMET	SEATING POSITION	AIR BAG USAGE	EJECTION	TRAPPED

LOCAL REPORT NUMBER
2014-000039263

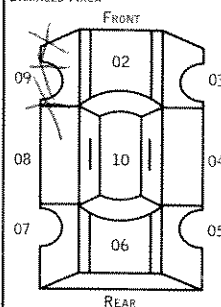
UNIT NUMBER 011	OWNER NAME: LAST, FIRST, MIDDLE <input checked="" type="checkbox"/> SAME AS DRIVER	OWNER PHONE NUMBER - INC. AREA CODE <input checked="" type="checkbox"/> SAME AS DRIVER	DAMAGE SCALE 4	DAMAGED AREA 
OWNER ADDRESS: CITY, STATE, ZIP <input checked="" type="checkbox"/> SAME AS DRIVER			1 - NONE	
LP STATE OH	LICENSE PLATE NUMBER GFE7851	VEHICLE IDENTIFICATION NUMBER JT15ST187K9P0132007	2 - MINOR	
VEHICLE YEAR 11/9/13	VEHICLE MAKE TOYOTA	VEHICLE MODEL CELLA	3 - FUNCTIONAL	
PROOF OF INSURANCE SHOWN <input type="checkbox"/>	INSURANCE COMPANY	POLICY NUMBER	4 - DISABLING	
CARRIER NAME, ADDRESS, CITY, STATE, ZIP			9 - UNKNOWN	
			CARRIER PHONE - INCLUDE AREA CODE	

US DOT	VEHICLE WEIGHT GVWR/GCWR 1 1 - LESS THAN OR EQUAL TO 10,000 LBS. 2 - 10,001 TO 26,000 LBS. 3 - MORE THAN 26,000 LBS.	CARGO BODY TYPE 01 01 - NO CARGO BODY TYPE/NOT APPLICABLE 02 - BUS/VAN (9-15 SEATS, INC DRIVER) 03 - BUS (16+ SEATS, INC DRIVER) 04 - VEHICLE TOWING ANOTHER VEHICLE 05 - LOGGING 06 - INTERMODAL CONTAINER CHASSIS 07 - CARGO VAN/ENCLOSED BOX 08 - GRAIN, CHIPS, GRAVEL	09 - POLE 10 - CARGO TANK 11 - FLAT BED 12 - DUMP 13 - CONCRETE MIXER 14 - AUTO TRANSPORTER 15 - GARBAGE/REFUSE 99 - OTHER/UNKNOWN	TRAFFICWAY DESCRIPTION 1 1 - TWO-WAY, NOT DIVIDED 2 - TWO-WAY, NOT DIVIDED, CONTIGUOUS LEFT TURN LANE 3 - TWO-WAY, DIVIDED, UNPROTECTED (PRINTED OR GRASS > 4 FT.) MEDIAN 4 - TWO-WAY, DIVIDED, POSITIVE MEDIAN BARRIER 5 - ONE-WAY TRAFFICWAY
HM PLACARD ID No.	<input type="checkbox"/> HAZARDOUS MATERIAL RELEASED			<input type="checkbox"/> HIT / STRIP UNIT
HM CLASS NUMBER				

NON-MOTORIST LOCATION PRIOR TO IMPACT 01 01 - INTERSECTION - MARKED CROSSWALK 02 - INTERSECTION - NO CROSSWALK 03 - INTERSECTION - OTHER 04 - MIDBLOCK - MARKED CROSSWALK 05 - TRAVEL LANE - OTHER LOCATION 06 - BICYCLE LANE 07 - SHOULDER/ROADSIDE 08 - SIDEWALK 09 - MEDIAN/CROSSING ISLAND 10 - DRIVEWAY ACCESS 11 - SHARED-USE PATH OR TRAIL 12 - NON-TRAFFICWAY AREA 99 - OTHER/UNKNOWN	TYPE OF USE 1 1 - PERSONAL 2 - COMMERCIAL 3 - GOVERNMENT <input type="checkbox"/> IN EMERGENCY RESPONSE	UNIT TYPE 02 99 - UNKNOWN OR HIT / STRIP	PASSENGER VEHICLES (LESS THAN 9 PASSENGERS) 01 - SUB-COMPACT 02 - COMPACT 03 - MID SIZE 04 - FULL SIZE 05 - MINIVAN 06 - SPORT UTILITY VEHICLE 07 - PICKUP 08 - VAN 09 - MOTORCYCLE 10 - MOTORIZED BICYCLE 11 - SNOWMOBILE/ATV 12 - OTHER PASSENGER VEHICLE	MED/HEAVY TRUCKS OR COMBO UNITS > 10K LBS 13 - SINGLE UNIT TRUCK OR VAN 2AXLE, 6 TIRES 14 - SINGLE UNIT TRUCK 3+ AXLES 15 - SINGLE UNIT TRUCK / TRAILER 16 - TRUCK/TRACTOR (BOBTAIL) 17 - TRACTOR/SEMI-TRAILER 18 - TRACTOR/DOUBLE 19 - TRACTOR/TRIPLES 20 - OTHER MED/HEAVY VEHICLE	BUS/VAN/LIMO (9 OR MORE INCLUDING DRIVER) 21 - BUS/VAN (9-15 SEATS, INC DRIVER) 22 - BUS (16+ SEATS, INC DRIVER)	NON-MOTORIST 23 - ANIMAL WITH RIDER 24 - ANIMAL WITH BUGGY, WAGON, SURREY 25 - BICYCLE/PEDESTALIAN 26 - PEDESTRIAN/SKATER 27 - OTHER NON-MOTORIST
			<input type="checkbox"/> HAS HM PLACARD			

SPECIAL FUNCTION 01 01 - NONE 02 - TAXI 03 - RENTAL TRUCK (OVER 10K LBS) 04 - BUS - SCHOOL (PUBLIC OR PRIVATE) 05 - BUS - TRANSIT 06 - BUS - CHARTER 07 - BUS - SHUTTLE 08 - BUS - OTHER	09 - AMBULANCE 10 - FIRE 11 - HIGHWAY/MAINTENANCE 12 - MILITARY 13 - POLICE 14 - PUBLIC UTILITY 15 - OTHER GOVERNMENT 16 - CONSTRUCTION EQUIP.	17 - FARM VEHICLE 18 - FARM EQUIPMENT 19 - MOTORHOME 20 - GOLF CART 21 - TRAIN 22 - OTHER (EXPLAIN IN NARRATIVE)	MOST DAMAGED AREA 09 01 - NONE 02 - CENTER FRONT 03 - RIGHT FRONT 04 - RIGHT SIDE 05 - RIGHT REAR 06 - REAR CENTER 07 - LEFT REAR	08 - LEFT SIDE 09 - LEFT FRONT 10 - TOP AND WINDOWS 11 - UNDERCARRIAGE 12 - LOAD/TRAILER 13 - TOTAL (ALL AREAS) 14 - OTHER	ACTION 4 1 - NON-CONTACT 2 - NON-COLLISION 3 - STRIKING 4 - STRUCK 5 - STRIKING/STRUCK 9 - UNKNOWN
--	---	---	--	--	--

PRE-CRASH ACTIONS 06 99 - UNKNOWN	MOTORIST 01 - STRAIGHT AHEAD 02 - BACKING 03 - CHANGING LANES 04 - OVERTAKING/PASSING 05 - MAKING RIGHT TURN 06 - MAKING LEFT TURN	07 - MAKING U-TURN 08 - ENTERING TRAFFIC LANE 09 - LEAVING TRAFFIC LANE 10 - PARKED 11 - SLOWING OR STOPPED IN TRAFFIC 12 - DRIVERLESS	13 - NEGOTIATING A CURVE 14 - OTHER MOTORIST ACTION	NON-MOTORIST 15 - ENTERING OR CROSSING SPECIFIED LOCATION 16 - WALKING, RUNNING, JOGGING, PLAYING, CYCLING 17 - WORKING 18 - PUSHING VEHICLE 19 - APPROACHING OR LEAVING VEHICLE 20 - STANDING 21 - OTHER NON-MOTORIST ACTION
--	--	---	--	--

CONTRIBUTING CIRCUMSTANCES PRIMARY 02 SECONDARY 01 99 - UNKNOWN	MOTORIST 01 - NONE 02 - FAILURE TO YIELD 03 - RAN RED LIGHT 04 - RAN STOP SIGN 05 - EXCEEDED SPEED LIMIT 06 - UNSAFE SPEED 07 - IMPROPER TURN 08 - LEFT OF CENTER 09 - FOLLOWED TOO CLOSELY/ACCDA 10 - IMPROPER LANE CHANGE /PASSING/OFF ROAD	11 - IMPROPER BACKING 12 - IMPROPER START FROM PARKED POSITION 13 - STOPPED OR PARKED ILLEGALLY 14 - OPERATING VEHICLE IN NEGLIGENT MANNER 15 - SWERVING TO AVOID (DUE TO EXTERNAL CONDITIONS) 16 - WRONG SIDE/WRONG WAY 17 - FAILURE TO CONTROL 18 - VISION OBSTRUCTION 19 - OPERATING DEFECTIVE EQUIPMENT 20 - LOAD SHIFTING/FALLING/SPILLING 21 - OTHER IMPROPER ACTION	NON-MOTORIST 22 - NONE 23 - IMPROPER CROSSING 24 - DARTING 25 - LYING AND/OR ILLEGALLY IN ROADWAY 26 - FAILURE TO YIELD RIGHT OF WAY 27 - NOT VISIBLE (DARK CLOTHING) 28 - INATTENTIVE 29 - FAILURE TO OBEY TRAFFIC SIGNS /SIGNALS/OFFICER 30 - WRONG SIDE OF THE ROAD 31 - OTHER NON-MOTORIST ACTION	VEHICLE DEFECTS 01 01 - TURN SIGNALS 02 - HEAD LAMPS 03 - TAIL LAMPS 04 - BRAKES 05 - STEERING 06 - TIRE BLOWOUT 07 - WORN OR SLICK TIRES 08 - TRAILER EQUIPMENT DEFECTIVE 09 - MOTOR TROUBLE 10 - DISABLED FROM PRIOR ACCIDENT 11 - OTHER DEFECTS
--	---	--	---	---

SEQUENCE OF EVENTS 1 20 2 01 3 01 4 01 5 01 6 01 FIRST HARMFUL EVENT 1 MOST HARMFUL EVENT 1 99 - UNKNOWN	NON-COLLISION EVENTS 01 - OVERTURN/ROLLOVER 02 - FIRE/EXPLOSION 03 - IMMERSION 04 - JACKKNIFE 05 - CARGO/EQUIPMENT LOSS OR SHIFT	06 - EQUIPMENT FAILURE (BLOWN TIRE, BRAKE FAILURE, ETC) 07 - SEPARATION OF UNITS 08 - RAN OFF ROAD RIGHT 09 - RAN OFF ROAD LEFT	10 - CROSS MEDIAN 11 - CROSS CENTER LINE OPPOSITE DIRECTION OF TRAVEL 12 - DOWNHILL RUNAWAY 13 - OTHER NON-COLLISION
COLLISION WITH PERSON, VEHICLE OR OBJECT NOT FIXED 14 - PEDESTRIAN 15 - PEDALCYCLE 16 - RAILWAY VEHICLE (TRAIN, ENGINE) 17 - ANIMAL - FARM 18 - ANIMAL - DEER 19 - ANIMAL - OTHER 20 - MOTOR VEHICLE IN TRANSPORT		COLLISION WITH FIXED OBJECT 25 - IMPACT ATTENUATOR/CRASH CUSHION 26 - BRIDGE OVERHEAD STRUCTURE 27 - BRIDGE PIER OR ABUTMENT 28 - BRIDGE PARAPET 29 - BRIDGE RAIL 30 - GUARDRAIL FACE 31 - GUARDRAIL END 32 - PORTABLE BARRIER	
		33 - MEDIAN CABLE BARRIER 34 - MEDIAN GUARDRAIL BARRIER 35 - MEDIAN CONCRETE BARRIER 36 - MEDIAN OTHER BARRIER 37 - TRAFFIC SIGN POST 38 - OVERHEAD SIGN POST 39 - LIGHT/LUMINARIES SUPPORT 40 - UTILITY POLE	
		41 - GROUP POST, POLE OR SUPPORT 42 - CULVERT 43 - CURB 44 - DITCH 45 - EMBANKMENT 46 - FENCE 47 - MAILBOX	
		48 - TREE 49 - FIRE HYDRANT 50 - WORK ZONE MAINTENANCE EQUIPMENT 51 - WALL, BUILDING, TUNNEL 52 - OTHER FIXED OBJECT	

UNIT SPEED 51	POSTED SPEED 25	TRAFFIC CONTROL 12 01 - NO CONTROLS 02 - STOP SIGN 03 - YIELD SIGN 04 - TRAFFIC SIGNAL 05 - TRAFFIC FLASHERS 06 - SCHOOL ZONE	07 - RAILROAD CROSSINGS 08 - RAILROAD FLASHERS 09 - RAILROAD GATES 10 - CONSTRUCTION BARRICADE 11 - PERSON (FLAGGER, OFFICER) 12 - PAVEMENT MARKINGS	13 - CROSSWALK LINES 14 - WALK/DORTY WALK 15 - OTHER 16 - NOT REPORTED	UNIT DIRECTION FROM 3 TO 1 1 - NORTH 2 - SOUTH 3 - EAST 4 - WEST	5 - NORTHEAST 6 - NORTHWEST 7 - SOUTHEAST 8 - SOUTHWEST 9 - UNKNOWN
-------------------------	---------------------------	---	---	---	---	---



UNIT

LOCAL REPORT NUMBER

2014-000039262

UNIT NUMBER 02A	OWNER NAME: LAST, FIRST, MIDDLE (<input type="checkbox"/> SAME AS DRIVER) DEBRA - KUEMPEL	OWNER PHONE NUMBER - INC. AREA CODE (<input type="checkbox"/> SAME AS DRIVER) 513.271.6500	DAMAGE SCALE 2	DAMAGED AREA
OWNER ADDRESS: CITY, STATE, ZIP (<input type="checkbox"/> SAME AS DRIVER) 3976 S. AVE CINCINNATI, OHIO 45227			1 - NONE	
LP STATE OH	LICENSE PLATE NUMBER PHP 2143	VEHICLE IDENTIFICATION NUMBER 1G1EMCPEX9K2240563	# OCCUPANTS 02	2 - MINOR
VEHICLE YEAR 2012	VEHICLE MAKE CHEVROLET	VEHICLE MODEL SILVERADO	VEHICLE COLOR WHITE	3 - FUNCTIONAL
<input checked="" type="checkbox"/> PROOF OF INSURANCE SHOWN	INSURANCE COMPANY CINCINNATI INSURANCE	POLICY NUMBER CAAS878036	TOWED BY	4 - DISABLING
CARRIER NAME, ADDRESS, CITY, STATE, ZIP			CARRIER PHONE - INCLUDE AREA CODE	

US DOT	VEHICLE WEIGHT GVWR/GCWR 1 - LESS THAN OR EQUAL TO 10K LBS. 2 - 10,001 TO 26,000 LBS. 3 - MORE THAN 26,000 LBS.	CARGO BODY TYPE 01 - NO CARGO BODY TYPE/NOT APPLICABLE 02 - BUS/VAN (9-15 SEATS, INC DRIVER) 03 - BUS (16+ SEATS, INC DRIVER) 04 - VEHICLE TOWING ANOTHER VEHICLE 05 - LOGGING 06 - INTERMODAL CONTAINER CHASSIS 07 - CARGO VAN/ENCLOSED BOX 08 - GRAIN, CHIPS, GRAVEL	09 - POLE 10 - CARGO TANK 11 - FLAT BED 12 - DUMP 13 - CONCRETE MIXER 14 - AUTO TRANSPORTER 15 - GARBAGE/REFUSE 99 - OTHER/UNKNOWN	TRAFFICWAY DESCRIPTION 1 - TWO-WAY, NOT DIVIDED 2 - TWO-WAY, NOT DIVIDED, CONTINUOUS LEFT TURN LANE 3 - TWO-WAY, DIVIDED, UNPROTECTED (PAINTED OR GRASS 74 FT.) MEDIAN 4 - TWO-WAY, DIVIDED, POSITIVE MEDIAN BARRIER 5 - ONE-WAY TRAFFICWAY
HM PLACARD ID No.	<input type="checkbox"/> HAZARDOUS MATERIAL RELEASED	<input type="checkbox"/> HIT / SKIP UNIT		
HM CLASS NUMBER				

NON-MOTORIST LOCATION PRIOR TO IMPACT 01 - INTERSECTION - MARKED CROSSWALK 02 - INTERSECTION - NO CROSSWALK 03 - INTERSECTION - OTHER 04 - MIDDLEBLOCK - MARKED CROSSWALK 05 - TRAVEL LANE - OTHER LOCATION 06 - BICYCLE LANE 07 - SHOULDER/ROADSIDE 08 - SIDEWALK 09 - MEDIAN/CROSSING ISLAND 10 - DRIVEWAY ACCESS 11 - SHARED-USE PATH OR TRAIL 12 - NON-TRAFFICWAY AREA 99 - OTHER/UNKNOWN	TYPE OF USE 1 - PERSONAL 2 - COMMERCIAL 3 - GOVERNMENT <input type="checkbox"/> IN EMERGENCY RESPONSE	UNIT TYPE 07 99 - UNKNOWN OR HIT / SKIP	PASSENGER VEHICLES (LESS THAN 9 PASSENGERS) 01 - SUB-COMPACT 02 - COMPACT 03 - MID SIZE 04 - FULL SIZE 05 - MINIVAN 06 - SPORT UTILITY VEHICLE 07 - PICKUP 08 - VAN 09 - MOTORCYCLE 10 - MOTORIZED BICYCLE 11 - SNOWMOBILE/ATV 12 - OTHER PASSENGER VEHICLE	MED/HEAVY TRUCKS OR COMBO UNITS > 10K LBS 13 - SINGLE UNIT TRUCK OR VAN AXLE, 6 TIRES 14 - SINGLE UNIT TRUCK/ 3+ AXLES 15 - SINGLE UNIT TRUCK / TRAILER 16 - TRUCK/TRACTOR (BOBTAIL) 17 - TRACTOR/SEMI-TRAILER 18 - TRACTOR/DOUBLE 19 - TRACTOR/TRIPLES 20 - OTHER MED/HEAVY VEHICLE	BUS/VAN/LIMO (9 OR MORE INCLUDING DRIVER) 21 - BUS/VAN (9-15 SEATS, INC DRIVER) 22 - BUS (16+ SEATS, INC DRIVER) NON-MOTORIST 23 - ANIMAL WITH RIDER 24 - ANIMAL WITH BOGGY, WAGON, SURREY 25 - BICYCLE/PEDESTALCYCLIST 26 - PEDESTRIAN/SCATER 27 - OTHER NON-MOTORIST
			<input type="checkbox"/> HAS HM PLACARD		

SPECIAL FUNCTION 01 - NONE 02 - TAXI 03 - RENTAL TRUCK (OVER 10K LBS) 04 - BUS - SCHOOL (PUBLIC OR PRIVATE) 05 - BUS - TRANSIT 06 - BUS - CHARTER 07 - BUS - SHUTTLE 08 - BUS - OTHER	09 - AMBULANCE 10 - FIRE 11 - HIGHWAY/MAINTENANCE 12 - MILITARY 13 - POLICE 14 - PUBLIC UTILITY 15 - OTHER GOVERNMENT 16 - CONSTRUCTION EQUIP.	17 - FARM VEHICLE 18 - FARM EQUIPMENT 19 - MOTORHOME 20 - GOLF CART 21 - TRAIN 22 - OTHER (EXPLAIN IN NARRATIVE)	MOST DAMAGED AREA 01 - NONE 02 - CENTER FRONT 03 - RIGHT FRONT 04 - RIGHT SIDE 05 - RIGHT REAR 06 - REAR CENTER 07 - LEFT REAR	08 - LEFT SIDE 09 - LEFT FRONT 10 - TOP AND WINDOWS 11 - UNDERCARRIAGE 12 - LOAD/TRAILER 13 - TOTAL(ALL AREAS) 14 - OTHER	99 - UNKNOWN	ACTION 3 1 - NON-CONTACT 2 - NON-COLLISION 3 - STRIKING 4 - STRUCK 5 - STRIKING/STRUCK 9 - UNKNOWN
---	---	---	---	---	--------------	---

PRE-CRASH ACTIONS 01 99 - UNKNOWN	MOTORIST 01 - STRAIGHT AHEAD 02 - BACKING 03 - CHANGING LANES 04 - OVERTAKING/PASSING 05 - MAKING RIGHT TURN 06 - MAKING LEFT TURN 07 - MAKING U-TURN 08 - ENTERING TRAFFIC LANE 09 - LEAVING TRAFFIC LANE 10 - PARKED 11 - SLOWING OR STOPPED IN TRAFFIC 12 - DRIVERLESS	13 - NEGOTIATING A CURVE 14 - OTHER MOTORIST ACTION	NON-MOTORIST 15 - ENTERING OR CROSSING SPECIFIED LOCATION 16 - WALKING, RUNNING, JOGGING, PLAYING, CYCLING 17 - WORKING 18 - PUSHING VEHICLE 19 - APPROACHING OR LEAVING VEHICLE 20 - STANDING 21 - OTHER NON-MOTORIST ACTION
---	---	--	--

CONTRIBUTING CIRCUMSTANCES PRIMARY 01 99 - UNKNOWN	MOTORIST 01 - NONE 02 - FAILURE TO YIELD 03 - RAN RED LIGHT 04 - RAN STOP SIGN 05 - EXCEEDED SPEED LIMIT 06 - UNSAFE SPEED 07 - IMPROPER TURN 08 - LEFT OF CENTER 09 - FOLLOWED TOO CLOSELY/ACDA 10 - IMPROPER LANE CHANGE /PASSING/OFF ROAD	11 - IMPROPER BACKING 12 - IMPROPER START FROM PARKED POSITION 13 - STOPPED OR PARKED ILLEGALLY 14 - OPERATING VEHICLE IN NEGLIGENT MANNER 15 - SWERVING TO AVOID (DUE TO EXTERNAL CONDITIONS) 16 - WRONG SIDE/WRONG WAY 17 - FAILURE TO CONTROL 18 - VISION OBSTRUCTION 19 - OPERATING DEFECTIVE EQUIPMENT 20 - LOAD SHIFTING/FALLING/SPILLING 21 - OTHER IMPROPER ACTION	NON-MOTORIST 22 - NONE 23 - IMPROPER CROSSING 24 - DARTING 25 - LYING AND/OR ILLEGALLY IN ROADWAY 26 - FAILURE TO YIELD RIGHT OF WAY 27 - NOT VISIBLE (DARK CLOTHING) 28 - INATTENTIVE 29 - FAILURE TO OBEY TRAFFIC SIGNS /SIGNALS/OFFICER 30 - WRONG SIDE OF THE ROAD 31 - OTHER NON-MOTORIST ACTION	VEHICLE DEFECTS 01 01 - TURN SIGNALS 02 - HEAD LAMPS 03 - TAIL LAMPS 04 - BRAKES 05 - STEERING 06 - TIRE BLOWOUT 07 - WORN OR SLICK TIRES 08 - TRAILER EQUIPMENT DEFECTIVE 09 - MOTOR TROUBLE 10 - DISABLED FROM PRIOR ACCIDENT 11 - OTHER DEFECTS
---	--	--	---	--

SEQUENCE OF EVENTS 1 20 2 3 4 5 6 FIRST HARMFUL EVENT MOST HARMFUL EVENT 99 - UNKNOWN	NON-COLLISION EVENTS 01 - OVERTURN/ROLLOVER 02 - FIRE/EXPLOSION 03 - IMMERSION 04 - JACKKNIFE 05 - CARGO/EQUIPMENT LOSS OR SHIFT 06 - EQUIPMENT FAILURE (BLOWN TIRE, BRAKE FAILURE, ETC) 07 - SEPARATION OF UNITS 08 - RAN OFF ROAD RIGHT 09 - RAN OFF ROAD LEFT 10 - CROSS MEDIAN 11 - CROSS CENTER LINE 12 - DOWNHILL RUNAWAY 13 - OTHER NON-COLLISION	COLLISION WITH FIXED OBJECT 25 - IMPACT ATTENUATOR/CRASH CUSHION 26 - BRIDGE OVERHEAD STRUCTURE 27 - BRIDGE PIER OR ABUTMENT 28 - BRIDGE PARAPET 29 - BRIDGE RAIL 30 - GUARDRAIL FACE 31 - GUARDRAIL END 32 - PORTABLE BARRIER 33 - MEDIAN CABLE BARRIER 34 - MEDIAN GUARDRAIL BARRIER 35 - MEDIAN CONCRETE BARRIER 36 - MEDIAN OTHER BARRIER 37 - TRAFFIC SIGN POST 38 - OVERHEAD SIGN POST 39 - LIGHT/LUMINARIES SUPPORT 40 - UTILITY POLE 41 - OTHER POST, POLE OR SUPPORT 42 - CURB 43 - DITCH 44 - DITCH 45 - EMBANKMENT 46 - FENCE 47 - MAILBOX 48 - TREE 49 - FIRE HYDRANT 50 - WORK ZONE MAINTENANCE EQUIPMENT 51 - WALL, BUILDING, TUNNEL 52 - OTHER FIXED OBJECT
---	---	--

UNIT SPEED 15	POSTED SPEED 25	TRAFFIC CONTROL 01 - NO CONTROL 02 - STOP SIGN 03 - YIELD SIGN 04 - TRAFFIC SIGNAL 05 - TRAFFIC FLASHERS 06 - SCHOOL ZONE 07 - RAILROAD CROSSBUCKS 08 - RAILROAD FLASHERS 09 - RAILROAD GATES 10 - CONSTRUCTION BARRIAGE 11 - PERSON (FLAGGER, OFFICER) 12 - PAVEMENT MARKINGS 13 - CROSSWALK LINES 14 - WALK/DON'T WALK 15 - OTHER 16 - NOT REPORTED	UNIT DIRECTION FROM 1 TO 2 1 - NORTH 2 - SOUTH 3 - EAST 4 - WEST 5 - NORTHEAST 6 - NORTHWEST 7 - SOUTHEAST 8 - SOUTHWEST 9 - UNKNOWN
------------------	--------------------	---	--

OHIO TRAFFIC ACCIDENT - DIAGRAM/NARRATIVE CONTINUATION

OH-2 (REV. 1/82)

LOCAL REPORT NUMBER 2014-39262	REPORTING AGENCY MASON POLICE DEPT.	DATE OF ACCIDENT M 10 - 10 08 10 2014
IN COUNTY OF WARREN	ACCIDENT LOCATION MASON MONTGOMERY & LAUREL WOOD CT.	

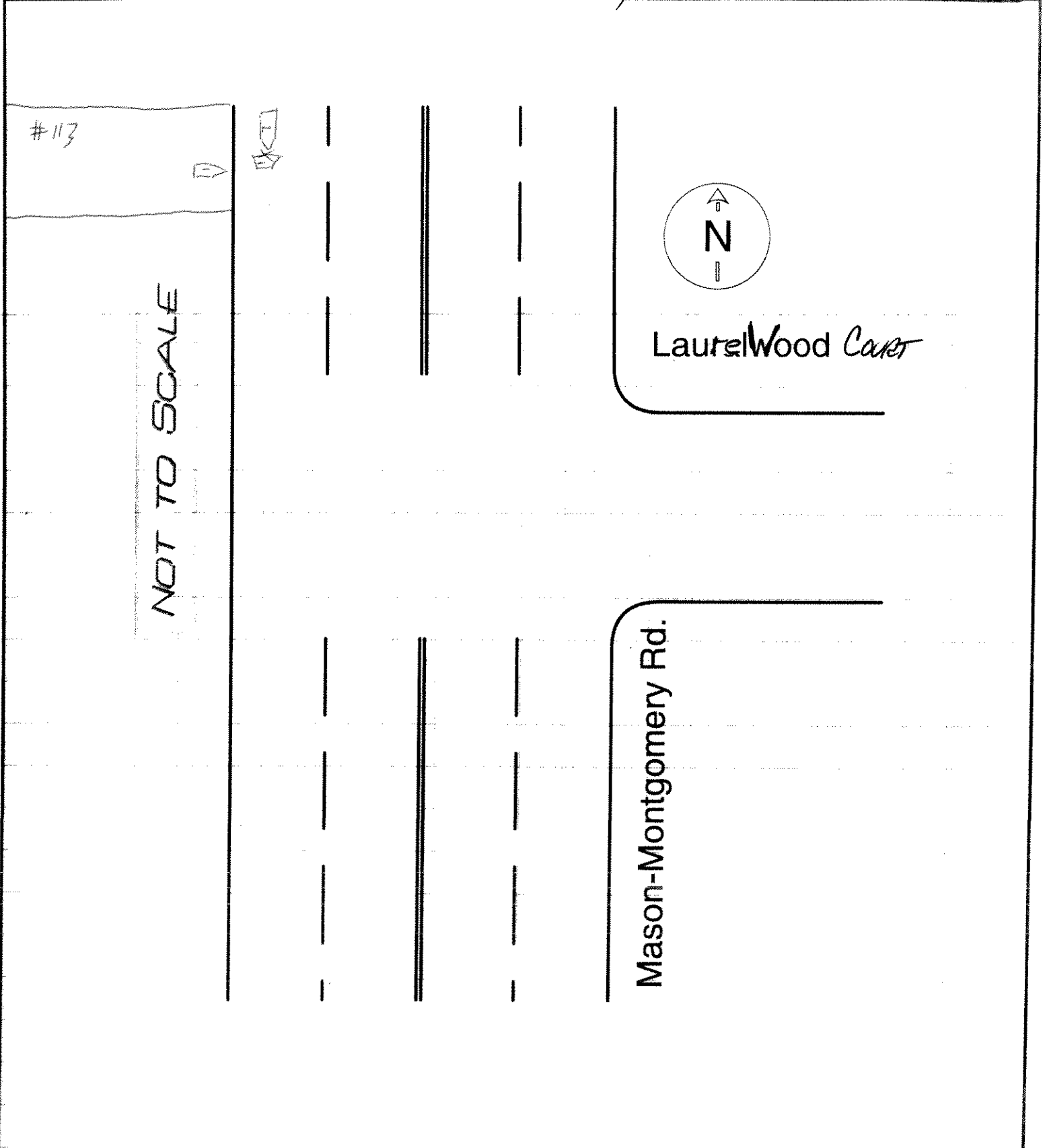

OFFICERS SIGNATURE

[Handwritten Signature]

BADGE NO.

1024



LOCAL REPORT NUMBER 2014 - 39262	REPORTING AGENCY MASON P.D.	DATE OF CRASH M 12 10 8 14
-------------------------------------	---------------------------------------	-------------------------------

FOR LOCAL USE ONLY - DO NOT SUBMIT TO THE STATE EXCEPT FOR FATAL CRASHES

I, David Glen Stephen Davis HEREBY MAKE THIS VOLUNTARY STATEMENT TO
PRINTED
SECHRIST #24 AT 113 Mason Montgomery Rd.
OFFICER'S NAME LOCATION

Attempting to take a left on Mason Hwy, saw a driver headed
 toward 42 lane to wave me to pass my left. After a rusty visual check
 of the oncoming lane, I began to pull left. I completely failed to see
 the other driver.

Q: INJURIES? No
Q: WEARING SEATBELT? Yes
Q: YOUR SPEED? 5 mph
Q: WERE YOU DISTRACTED? Yes

ADDRESS OF WITNESS <u>1 Chickadee Ct. West Chester OH 45690</u>	PHONE <u>513-625-3747</u>
SIGNATURE OF WITNESS X <u>[Signature]</u>	OFFICER'S SIGNATURE X <u>[Signature]</u>



LOCAL REPORT NUMBER 2014-39262	REPORTING AGENCY MASON POLICE	DATE OF CRASH 12/08/14
-----------------------------------	----------------------------------	---------------------------

FOR LOCAL USE ONLY - DO NOT SUBMIT TO THE STATE EXCEPT FOR FATAL CRASHES

I, Nicholas G. NeCamp HEREBY MAKE THIS VOLUNTARY STATEMENT TO
PRINTED
P.O. SECHRIST AT 113 MASON-MONTGOMERY RD
OFFICER'S NAME LOCATION

Going South on Mason Montgomery Rd.
and a white Toyota pulled out in front
of me and I hit the drivers side
door.

NAME - PATRICK NECAMP

DOB + AGE - ~~12/8/14~~^{MS} 12/30/1997

Q. WERE YOU, OR ANYONE IN YOUR VEHICLE INJURED? Not apparent now

Q. WERE YOU WEARING YOUR SEAT BELT? Yes

Q. WHAT DIRECTION WERE YOU GOING? South

Q. WHAT WAS YOUR SPEED? 15 mph

Q. WERE YOU USING A CELL PHONE AT THE TIME OF THE CRASH? No

ADDRESS OF WITNESS: 6184 Meve Dr. Mason Ohio 45040 PHONE: 513-678-2962

SIGNATURE OF WITNESS: [Signature]

SIGNATURE OF OFFICER: [Signature]