



Traffic Crash Report

Local Report Number *	Crash Severity	Hit/Skip
2014-37250	2 1 - Fatal 2 - Injury 3 - PDO	<input type="checkbox"/> 1 - Solved <input type="checkbox"/> 2 - Unsolved

Photos Taken <input checked="" type="checkbox"/> OH-2 <input type="checkbox"/> OH-1P <input type="checkbox"/> OH-3 <input type="checkbox"/> Other	PDO Under State Reportable Dollar Amount	Private Property	Reporting Agency NCIC *	Reporting Agency Name *	Number of Units	Unit in error
			08304	MASON POLICE	02	02 98 - Animal 99 - Unknown

County *	City *	City, Village, Township *	Crash Date	Time of Crash	Day of Week
83	<input checked="" type="checkbox"/> City <input type="checkbox"/> Village <input type="checkbox"/> Township	CITY OF MASON	11/21/2014	07:45	FRI

Degrees / Minutes / Seconds Latitude	Longitude	Decimal Degrees Latitude	Longitude
0 / / "	0 / / "	39.356647	-84.315765

Roadway Division	Divided Lane Direction of Travel	Number of Thru Lanes	Road Types or Milepost ²
<input type="checkbox"/> Divided <input checked="" type="checkbox"/> Undivided	<input type="checkbox"/> N - Northbound E - Eastbound <input type="checkbox"/> S - Southbound W - Westbound	03	AL - Alley CR - Circle HE - Heights MP - Milepost PL - Place ST - Street WA - Way AV - Avenue CT - Court HW - Highway PK - Parkway RD - Road TE - Terrace BL - Boulevard DR - Drive LA - Lane PI - Pike SQ - Square TL - Trail

Location Route Type ¹	Location Route Number	Loc. Prefix	Location Road Name	Location Road Type ²	Route Types ¹
US	42	<input type="checkbox"/> N, S <input type="checkbox"/> E, W	READING	RD	IR - Interstate Route (inc. turnpike) CR - Numbered County Route US - US Route TR - Numbered Township Route SR - State Route

Distance From Reference	Dir From Ref	Reference Route Number	Ref. Prefix	Reference Name (Road, Milepost, House #)	Reference Road Type ²
30 Miles Feet Yards	<input checked="" type="checkbox"/> N <input type="checkbox"/> S <input type="checkbox"/> E <input type="checkbox"/> W		<input type="checkbox"/> N, S <input type="checkbox"/> E, W	FOURTH	ST

Reference Point Used	Crash Location	Intersection Related	Location of First Harmful Event
<input type="checkbox"/> 1 - Intersection <input type="checkbox"/> 2 - Mile Post <input type="checkbox"/> 3 - House Number	<input checked="" type="checkbox"/> 01 - Not an intersection <input type="checkbox"/> 02 - Four-way intersection <input type="checkbox"/> 03 - T-Intersection <input type="checkbox"/> 04 - Y-Intersection <input type="checkbox"/> 05 - Traffic Circle/Roundabout <input type="checkbox"/> 06 - Five-point, or more <input type="checkbox"/> 07 - On Ramp <input type="checkbox"/> 08 - Off Ramp <input type="checkbox"/> 09 - Crossover <input type="checkbox"/> 10 - Driveway/Alley Access <input type="checkbox"/> 11 - Railway Grade Crossing <input type="checkbox"/> 12 - Shared-Use Paths or Trails <input type="checkbox"/> 99 - Unknown	<input type="checkbox"/>	<input type="checkbox"/> 1 - On Roadway <input type="checkbox"/> 2 - On Shoulder <input type="checkbox"/> 3 - In Median <input type="checkbox"/> 4 - On Roadside <input type="checkbox"/> 5 - On Gore <input type="checkbox"/> 6 - Outside Trafficway <input type="checkbox"/> 9 - Unknown

Road Contour	Road Conditions	Secondary	01 - Dry	05 - Sand, Mud, Dirt, Oil, Gravel	09 - Rut, Holes, Bumps, Uneven Pavement*
<input type="checkbox"/> 1 - Straight Level <input type="checkbox"/> 2 - Straight Grade <input type="checkbox"/> 3 - Curve Level <input type="checkbox"/> 4 - Curve Grade <input type="checkbox"/> 9 - Unknown	<input checked="" type="checkbox"/> 01 <input type="checkbox"/>	<input type="checkbox"/>	02 - Wet 03 - Snow 04 - Ice	06 - Water (Standing, Moving) 07 - Slush 08 - Debris*	10 - Other 99 - Unknown

Manner of Crash Collision/Impact	Weather
<input checked="" type="checkbox"/> 2 - Not Collision Between Two Motor Vehicles In Transport <input type="checkbox"/> 1 - Rear-End <input type="checkbox"/> 3 - Head-On <input type="checkbox"/> 4 - Rear-to-Rear <input type="checkbox"/> 5 - Backing <input type="checkbox"/> 6 - Angle <input type="checkbox"/> 7 - Sideswipe, Same Direction <input type="checkbox"/> 8 - Sideswipe, Opposite Direction <input type="checkbox"/> 9 - Unknown	<input type="checkbox"/> 1 - Clear <input type="checkbox"/> 2 - Cloudy <input type="checkbox"/> 3 - Fog, Smog, Smoke <input type="checkbox"/> 4 - Rain <input type="checkbox"/> 5 - Sleet, Hail <input type="checkbox"/> 6 - Snow <input type="checkbox"/> 7 - Severe Crosswinds <input type="checkbox"/> 8 - Blowing Sand, Soil, Dirt, Snow <input type="checkbox"/> 9 - Other/Unknown

Road Surface	Light Conditions	Secondary	5 - Dark - Roadway Not Lighted	9 - Unknown	<input checked="" type="checkbox"/> School Bus Related
<input checked="" type="checkbox"/> 2 - Concrete <input type="checkbox"/> 1 - Asphalt <input type="checkbox"/> 3 - Brick/Block <input type="checkbox"/> 4 - Slag, Gravel, Stone <input type="checkbox"/> 5 - Dirt <input type="checkbox"/> 6 - Other	<input type="checkbox"/> 1 - Daylight <input type="checkbox"/> 2 - Dawn <input type="checkbox"/> 3 - Dusk <input type="checkbox"/> 4 - Dark - Lighted Roadway	<input type="checkbox"/>	6 - Dark - Unknown Roadway Lighting 7 - Glare*	8 - Other	<input checked="" type="checkbox"/> Yes, School Bus Directly Involved <input type="checkbox"/> Yes, School Bus Indirectly Involved

Work Zone Related	Workers Present	Type of Work Zone	Location of Crash in Work Zone
<input type="checkbox"/>	<input type="checkbox"/> Law Enforcement Present (Officer/Vehicle) <input type="checkbox"/> Law Enforcement Present (Vehicle Only)	<input type="checkbox"/> 1 - Lane Closure <input type="checkbox"/> 2 - Lane Shift/Crossover <input type="checkbox"/> 3 - Work on Shoulder or Median <input type="checkbox"/> 4 - Intermittent or Moving Work <input type="checkbox"/> 5 - Other	<input type="checkbox"/> 1 - Before the First Work Zone Warning Sign <input type="checkbox"/> 2 - Advance Warning Area <input type="checkbox"/> 3 - Transition Area <input type="checkbox"/> 4 - Activity Area <input type="checkbox"/> 5 - Termination Area

Narrative

UNIT #1 AND UNIT #2 WERE SOUTHBOUND ON READING ROAD IN THE 300 BLOCK. UNIT #1 STOPPED FOR TRAFFIC AND WAS STRUCK IN THE REAR BY UNIT #2

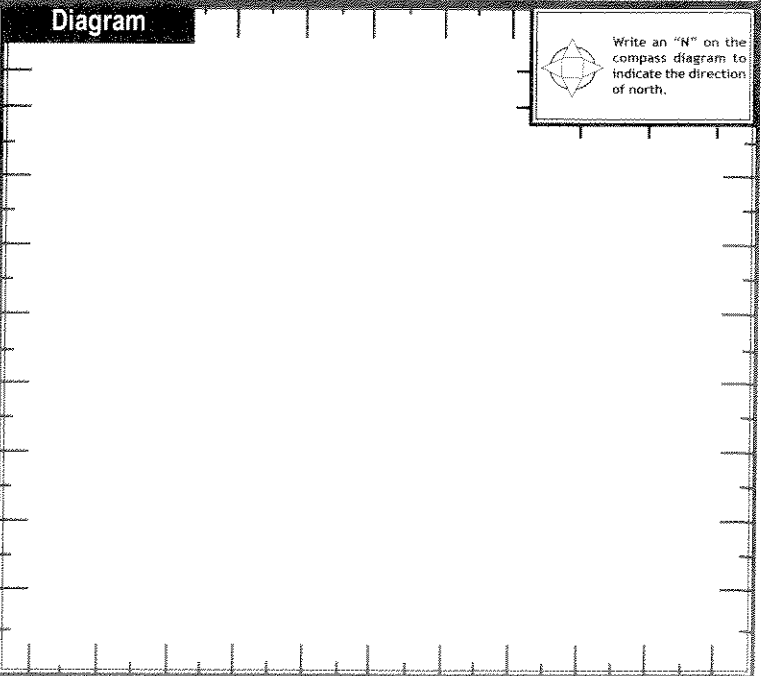

Report Taken By	Supplement (Correction or Addition to an Existing Report Sent to ODPS)	Date Crash Reported	Time Crash Reported	Dispatch Time	Arrival Time	Time Cleared	Other Investigation Time	Total Minutes
Police Agency		11/21/2014	07:46	07:46	07:51	08:30	10	49
Officer's Name *	Officer's Badge Number	Checked By						
A.S. HERRLINGER	1042	50						



MOTORIST / Non-MOTORIST / OCCUPANT

LOCAL REPORT NUMBER

UNIT NUMBER 011	NAME: LAST, FIRST, MIDDLE MULLANEY, THOMAS	DATE OF BIRTH 09.09.1959	AGE 55	GENDER M F - FEMALE M - MALE
---------------------------	--	------------------------------------	------------------	---

ADDRESS, CITY, STATE, ZIP 4721 HOMESTRETCH LN. MASON OHIO 45040	CONTACT PHONE - INCLUDE AREA CODE (513) 379 8279
---	--

INJURIES 1	INJURED TAKEN BY <input type="checkbox"/>	EMS AGENCY <input type="checkbox"/>	MEDICAL FACILITY INJURED TAKEN TO <input type="checkbox"/>	SAFETY EQUIPMENT USED 04	DOT COMPLIANT <input type="checkbox"/> MOTORCYCLE HELMET	SEATING POSITION 01	AIR BAG USAGE 1	EJECTION 1	TRAPPED 1
----------------------	--	--	---	------------------------------------	---	-------------------------------	---------------------------	----------------------	---------------------

OL STATE OH	OPERATOR LICENSE NUMBER RR560602	OL CLASS 4	No VALID OL <input type="checkbox"/>	M/C END. <input type="checkbox"/>	CONDITION 1	ALCOHOL/DRUG SUSPECTED 1	ALCOHOL TEST STATUS 1	ALCOHOL TEST TYPE 1	ALCOHOL TEST VALUE 0.000	DRUG TEST STATUS 1	DRUG TEST TYPE 1
-----------------------	--	----------------------	---	--------------------------------------	-----------------------	------------------------------------	---------------------------------	-------------------------------	------------------------------------	------------------------------	----------------------------

OFFENSE CHARGED (<input type="checkbox"/> LOCAL CODE)	OFFENSE DESCRIPTION	CITATION NUMBER	HANDS-FREE <input type="checkbox"/> DEVICE USED	DRIVER DISTRACTED BY 1 <input type="checkbox"/>
---	---------------------	-----------------	--	---

UNIT NUMBER 012	NAME: LAST, FIRST, MIDDLE WILSON, MARY R.	DATE OF BIRTH 09.24.1957	AGE 57	GENDER F F - FEMALE M - MALE
---------------------------	---	------------------------------------	------------------	---

ADDRESS, CITY, STATE, ZIP 3600 NIGHTWIND DR. MAINEVILLE, OH. 45039	CONTACT PHONE - INCLUDE AREA CODE (513) 697 0405
--	--

INJURIES 1	INJURED TAKEN BY <input type="checkbox"/>	EMS AGENCY <input type="checkbox"/>	MEDICAL FACILITY INJURED TAKEN TO <input type="checkbox"/>	SAFETY EQUIPMENT USED 04	DOT COMPLIANT <input type="checkbox"/> MOTORCYCLE HELMET	SEATING POSITION 01	AIR BAG USAGE 1	EJECTION 1	TRAPPED 1
----------------------	--	--	---	------------------------------------	---	-------------------------------	---------------------------	----------------------	---------------------

OL STATE OH	OPERATOR LICENSE NUMBER RT141010	OL CLASS 2	No VALID OL <input type="checkbox"/>	M/C END. <input type="checkbox"/>	CONDITION 1	ALCOHOL/DRUG SUSPECTED 1	ALCOHOL TEST STATUS 1	ALCOHOL TEST TYPE 1	ALCOHOL TEST VALUE 0.000	DRUG TEST STATUS 1	DRUG TEST TYPE 1
-----------------------	--	----------------------	---	--------------------------------------	-----------------------	------------------------------------	---------------------------------	-------------------------------	------------------------------------	------------------------------	----------------------------

OFFENSE CHARGED (<input checked="" type="checkbox"/> LOCAL CODE) 333-03	OFFENSE DESCRIPTION A.C.D.A.	CITATION NUMBER 77457	HANDS-FREE <input type="checkbox"/> DEVICE USED	DRIVER DISTRACTED BY 1 <input type="checkbox"/>
---	--	---------------------------------	--	---

INJURIES 1 - NO INJURY / NONE REPORTED 2 - POSSIBLE 3 - NON-INCAPACITATING 4 - INCAPACITATING 5 - FATAL	INJURED TAKEN BY 1 - NOT TRANSPORTED / TREATED AT SCENE 2 - EMS 3 - POLICE 4 - OTHER 9 - UNKNOWN	SAFETY EQUIPMENT USED MOTORIST 01 - NONE USED - VEHICLE OCCUPANT 02 - SHOULDER BELT ONLY USED 03 - LAP BELT ONLY USED 04 - SHOULDER AND LAP BELT USED 99 - UNKNOWN SAFETY EQUIPMENT	Non-Motorist 05 - CHILD RESTRAINT SYSTEM - FORWARD FACING 06 - CHILD RESTRAINT SYSTEM - REAR FACING 07 - BOOSTER SEAT 08 - HELMET USED 09 - NONE USED 10 - HELMET USED 11 - PROTECTIVE PADS USED (ELBOWS, KNEES, ETC.) 12 - REFLECTIVE CLOTHING 13 - LIGHTING 14 - OTHER
---	--	--	---

SEATING POSITION 01 - FRONT - LEFT SIDE (MOTORCYCLE DRIVER) 02 - FRONT - MIDDLE 03 - FRONT - RIGHT SIDE 04 - SECOND - LEFT SIDE (MOTORCYCLE PASSENGER) 05 - SECOND - MIDDLE 06 - SECOND - RIGHT SIDE 07 - THIRD - LEFT SIDE (MOTORCYCLE SIDE CAR) 08 - THIRD - MIDDLE 09 - THIRD - RIGHT SIDE 10 - SLEEPER SECTION OF CAB (TRUCK) 11 - PASSENGER IN OTHER ENCLOSED CARGO AREA (NON-TRAILING UNIT SUCH AS A BUS, PICK-UP WITH CAB) 12 - PASSENGER IN UNENCLOSED CARGO AREA 13 - TRAILING UNIT 14 - RIDING ON VEHICLE EXTERIOR (NON-TRAILING UNIT) 15 - NON-MOTORIST 16 - OTHER 99 - UNKNOWN	AIR BAG USAGE 1 - NOT DEPLOYED 2 - DEPLOYED FRONT 3 - DEPLOYED SIDE 4 - DEPLOYED BOTH FRONT/SIDE 5 - NOT APPLICABLE 9 - DEPLOYMENT UNKNOWN
--	---

EJECTION 1 - NOT EJECTED 2 - TOTALLY EJECTED 3 - PARTIALLY EJECTED 4 - NOT APPLICABLE	TRAPPED 1 - NOT TRAPPED 2 - EXTRICATED BY MECHANICAL MEANS 3 - EXTRICATED BY NON-MECHANICAL MEANS	OPERATOR LICENSE CLASS 1 - CLASS A 2 - CLASS B 3 - CLASS C 4 - REGULAR CLASS (OH) IS "D" 5 - MC/MOPED ONLY	CONDITION 1 - APPARENTLY NORMAL 2 - PHYSICAL IMPAIRMENT 3 - EMOTIONAL (DEPRESSED, ANGRY, DISTURBED) 4 - ILLNESS 5 - FELL ASLEEP, FAINTED, FATIGUED 6 - UNDER THE INFLUENCE OF MEDICATIONS, DRUGS, ALCOHOL 7 - OTHER	ALCOHOL/DRUG SUSPECTED 1 - NONE 2 - YES - ALCOHOL SUSPECTED 3 - YES - HBD NOT IMPAIRED 4 - YES - DRUGS SUSPECTED 5 - YES - ALCOHOL AND DRUGS SUSPECTED
--	---	--	---	--

ALCOHOL TEST STATUS 1 - NONE GIVEN 2 - TEST REFUSED 3 - TEST GIVEN, CONTAMINATED SAMPLE/UNUSABLE 4 - TEST GIVEN, RESULTS KNOWN 5 - TEST GIVEN, RESULTS UNKNOWN	ALCOHOL TEST TYPE 1 - NONE 2 - BLOOD 3 - URINE 4 - BREATH 5 - OTHER	DRUG TEST STATUS 1 - NONE GIVEN 2 - TEST REFUSED 3 - TEST GIVEN, CONTAMINATED SAMPLE/UNUSABLE 4 - TEST GIVEN, RESULTS KNOWN 5 - TEST GIVEN, RESULTS UNKNOWN	DRUG TEST TYPE 1 - NONE 2 - BLOOD 3 - URINE 4 - OTHER	DRIVER DISTRACTED BY 1 - NO DISTRACTION REPORTED 2 - PHONE 3 - TEXTING/E-MAILING 4 - ELECTRONIC COMMUNICATION DEVICE 5 - OTHER ELECTRONIC DEVICE (NAVIGATOR DEVICE, RADIO, DVD) 6 - OTHER INSIDE THE VEHICLE 7 - EXTERNAL DISTRACTION
--	---	---	--	---

UNIT NUMBER 011	NAME: LAST, FIRST, MIDDLE MULLANEY, MEGAN	DATE OF BIRTH 05.17.2002	AGE 12	GENDER F F - FEMALE M - MALE
---------------------------	---	------------------------------------	------------------	---

ADDRESS, CITY, STATE, ZIP 4721 HOMESTRETCH LN. MASON, OH. 45040	CONTACT PHONE - INCLUDE AREA CODE (513) 379 8279
---	--

INJURIES 2	INJURED TAKEN BY 2	EMS AGENCY MASON SI	MEDICAL FACILITY INJURED TAKEN TO CHILDREN'S LIBERTY	SAFETY EQUIPMENT USED 04	DOT COMPLIANT <input type="checkbox"/> MOTORCYCLE HELMET	SEATING POSITION 03	AIR BAG USAGE 1	EJECTION 1	TRAPPED 1
----------------------	------------------------------	-------------------------------	--	------------------------------------	---	-------------------------------	---------------------------	----------------------	---------------------

UNIT NUMBER	NAME: LAST, FIRST, MIDDLE	DATE OF BIRTH	AGE	GENDER
-------------	---------------------------	---------------	-----	--------

ADDRESS, CITY, STATE, ZIP	CONTACT PHONE - INCLUDE AREA CODE
---------------------------	-----------------------------------

INJURIES	INJURED TAKEN BY	EMS AGENCY	MEDICAL FACILITY INJURED TAKEN TO	SAFETY EQUIPMENT USED	DOT COMPLIANT <input type="checkbox"/> MOTORCYCLE HELMET	SEATING POSITION	AIR BAG USAGE	EJECTION	TRAPPED
----------	------------------	------------	-----------------------------------	-----------------------	---	------------------	---------------	----------	---------



UNIT

LOCAL REPORT NUMBER

UNIT NUMBER 011	OWNER NAME: LAST, FIRST, MIDDLE (☑ SAME AS DRIVER)	OWNER PHONE NUMBER - INC. AREA CODE (☑ SAME AS DRIVER)	DAMAGE SCALE 2	DAMAGED AREA
---------------------------	--	--	--------------------------	--------------

OWNER ADDRESS: CITY, STATE, ZIP (☑ SAME AS DRIVER)	1 - NONE	
--	----------	--

LP STATE PA	LICENSE PLATE NUMBER CB79 ST	VEHICLE IDENTIFICATION NUMBER ST DBT44A32S112916	# OCCUPANTS 02
-----------------------	--	--	--------------------------

VEHICLE YEAR 2002	VEHICLE MAKE TOYOTA	VEHICLE MODEL SEQUOIA	VEHICLE COLOR GOLD
-----------------------------	-------------------------------	---------------------------------	------------------------------

PROOF OF INSURANCE SHOWN <input checked="" type="checkbox"/>	INSURANCE COMPANY GRANITE	POLICY NUMBER PA108743	TOWED BY
---	-------------------------------------	----------------------------------	----------

CARRIER NAME, ADDRESS, CITY, STATE, ZIP	CARRIER PHONE - INCLUDE AREA CODE
---	-----------------------------------

US DOT	VEHICLE WEIGHT GVWR/GCWR 1 1 - LESS THAN OR EQUAL TO 10K LBS. 2 - 10,001 TO 26,000 LBS. 3 - MORE THAN 26,000 LBS.	CARGO BODY TYPE 01 01 - NO CARGO BODY TYPE/NOT APPLICABLE 02 - BUS/VAN (9-15 SEATS, INC DRIVER) 03 - BUS (16+ SEATS, INC DRIVER) 04 - VEHICLE TOWING ANOTHER VEHICLE 05 - LOGGING 06 - INTERMEDIATE CONTAINER CHASSIS 07 - CARGO VAN/ENCLOSED BOX 08 - GRAIN, CHIPS, GRAVEL	TRAFFICWAY DESCRIPTION 1 1 - TWO-WAY, NOT DIVIDED 2 - TWO-WAY, NOT DIVIDED, CONTINUOUS LEFT TURN LANE 3 - TWO-WAY, DIVIDED, UNPROTECTED (PAINTED OR GRASS 7-4 FT.) MEDIAN 4 - TWO-WAY, DIVIDED, POSITIVE MEDIAN BARRIER 5 - ONE-WAY TRAFFICWAY
--------	--	---	---

HM PLACARD ID No.	HM CLASS NUMBER	HAZARDOUS MATERIAL RELEASED <input type="checkbox"/>	NON-MOTORIST LOCATION PRIOR TO IMPACT 01 01 - INTERSECTION - MARKED CROSSWALK 02 - INTERSECTION - NO CROSSWALK 03 - INTERSECTION - OTHER 04 - MIDBLOCK - MARKED CROSSWALK 05 - TRAVEL LANE - OTHER LOCATION 06 - BICYCLE LANE 07 - SHOULDER/ROADSIDE 08 - SIDEWALK 09 - MEDIAN/CROSSING ISLAND 10 - DRIVEWAY ACCESS 11 - SHARED-USE PATH OR TRAIL 12 - NON-TRAFFICWAY AREA 99 - OTHER/UNKNOWN	TYPE OF USE 1 1 - PERSONAL 2 - COMMERCIAL 3 - GOVERNMENT <input type="checkbox"/> IN EMERGENCY RESPONSE	UNIT TYPE 06 99 - UNKNOWN OR HIT / SKIP	PASSENGER VEHICLES (LESS THAN 9 PASSENGERS) 01 - SUB-COMPACT 02 - COMPACT 03 - MID SIZE 04 - FULL SIZE 05 - MINIVAN 06 - SPORT UTILITY VEHICLE 07 - PICKUP 08 - VAN 09 - MOTORCYCLE 10 - MOTORIZED BICYCLE 11 - SNOWMOBILE/ATV 12 - OTHER PASSENGER VEHICLE	MED/HEAVY TRUCKS OR COMBO UNITS > 10K LBS 13 - SINGLE UNIT TRUCK OR VAN TRAILER, 6 TYRES 14 - SINGLE UNIT TRUCK, 3+ AXLES 15 - SINGLE UNIT TRUCK / TRAILER 16 - TRUCK/TRACTOR (BOBTAIL) 17 - TRACTOR/SEMI-TRAILER 18 - TRACTOR/DOUBLE 19 - TRACTOR/TRIPLES 20 - OTHER MED/HEAVY VEHICLE	BUS/VAN/LIMO (9 OR MORE INCLUDING DRIVER) 21 - BUS/VAN (9-15 SEATS, INC DRIVER) 22 - BUS (16+ SEATS, INC DRIVER) NON-MOTORIST 23 - ANIMAL WITH RIDER 24 - ANIMAL WITH BUGGY, WAGON, SURREY 25 - BICYCLE/PEGASUS/BIKE 26 - PEDESTRIAN/SKATER 27 - OTHER NON-MOTORIST
-------------------	-----------------	---	--	---	--	---	---	--

SPECIAL FUNCTION 01 01 - NONE 02 - TAXI 03 - RENTAL TRUCK (OVER 10K LBS) 04 - BUS - SCHOOL (PUBLIC OR PRIVATE) 05 - BUS - TRANSIT 06 - BUS - CHARTER 07 - BUS - SHUTTLE 08 - BUS - OTHER	09 - AMBULANCE 10 - FIRE 11 - HIGHWAY/MAINTENANCE 12 - MILITARY 13 - POLICE 14 - PUBLIC UTILITY 15 - OTHER GOVERNMENT 16 - CONSTRUCTION EQUIP.	17 - FARM VEHICLE 18 - FARM EQUIPMENT 19 - MOTORHOME 20 - GOLF CART 21 - TRAIN 22 - OTHER (EXPLAIN IN NARRATIVE)	MOST DAMAGED AREA 06 01 - NONE 02 - CENTER FRONT 03 - RIGHT FRONT 04 - RIGHT SIDE 05 - RIGHT REAR 06 - REAR CENTER 07 - LEFT REAR	08 - LEFT SIDE 09 - LEFT FRONT 10 - TOP AND WINDOWS 11 - UNDERCARRIAGE 12 - LOAD/TRAILER 13 - TOTAL(ALL AREAS) 14 - OTHER	ACTION 9 1 - NON-CONTACT 2 - NON-COLLISION 3 - STRIKING 4 - STRUCK 5 - STRIKING/STRUCK 9 - UNKNOWN
--	---	---	--	---	--

PRE-CRASH ACTIONS 111 99 - UNKNOWN	MOTORIST 01 - STRAIGHT AHEAD 02 - BACKING 03 - CHANGING LANES 04 - OVERTAKING/PASSING 05 - MAKING RIGHT TURN 06 - MAKING LEFT TURN	07 - MAKING U-TURN 08 - ENTERING TRAFFIC LANE 09 - LEAVING TRAFFIC LANE 10 - PARKED 11 - SLOWING OR STOPPED IN TRAFFIC 12 - DRIVERLESS	13 - NEGOTIATING A CURVE 14 - OTHER MOTORIST ACTION	NON-MOTORIST 15 - ENTERING OR CROSSING SPECIFIED LOCATION 16 - WALKING, RUNNING, JOGGING, PLAYING, CYCLING 17 - WORKING 18 - PUSHING VEHICLE 19 - APPROACHING OR LEAVING VEHICLE 20 - STANDING	21 - OTHER NON-MOTORIST ACTION
---	--	---	--	--	--------------------------------

CONTRIBUTING CIRCUMSTANCES 01	MOTORIST 01 - NONE 02 - FAILURE TO YIELD 03 - RAN RED LIGHT 04 - RAN STOP SIGN 05 - EXCEEDED SPEED LIMIT 06 - UNSAFE SPEED 07 - IMPROPER TURN 08 - LEFT OF CENTER 09 - FOLLOWED TOO CLOSELY/ACDA 10 - IMPROPER LANE CHANGE /PASSING/OFF ROAD	11 - IMPROPER BACKING 12 - IMPROPER START FROM PARKED POSITION 13 - STOPPED OR PARKED ILLEGALLY 14 - OPERATING VEHICLE IN NEGLIGENT MANNER 15 - SWERVING TO AVOID (DUE TO EXTERNAL CONDITIONS) 16 - WRONG SIDE/WRONG WAY 17 - FAILURE TO CONTROL 18 - VISION OBSTRUCTION 19 - OPERATING DEFECTIVE EQUIPMENT 20 - LOAD SHIFTING/FALLING/SPILLING 21 - OTHER IMPROPER ACTION	NON-MOTORIST 22 - NONE 23 - IMPROPER CROSSING 24 - DARTING 25 - LYING AND/OR ILLEGALLY IN ROADWAY 26 - FAILURE TO YIELD RIGHT OF WAY 27 - NOT VISIBLE (DARK CLOTHING) 28 - INATTENTIVE 29 - FAILURE TO OBEY TRAFFIC SIGNS /SIGNALS/OFFICER 30 - WRONG SIDE OF THE ROAD 31 - OTHER NON-MOTORIST ACTION	VEHICLE DEFECTS 01 01 - TURN SIGNALS 02 - HEAD LAMPS 03 - TAIL LAMPS 04 - BRAKES 05 - STEERING 06 - TIRE BLOWOUT 07 - WORN OR SICK TIRES 08 - TRAILER EQUIPMENT DEFECTIVE 09 - MOTOR TROUBLE 10 - DISABLED FROM PRIOR ACCIDENT 11 - OTHER DEFECTS
---	--	--	---	--

SEQUENCE OF EVENTS 1 20 2 01 3 01 4 01 5 01 6 01	NON-COLLISION EVENTS 01 - OVERTURN/ROLLOVER 02 - FIRE/EXPLOSION 03 - IMMISSION 04 - JACKKNIFE 05 - CARGO/EQUIPMENT LOSS OR SHUT	06 - EQUIPMENT FAILURE (BURNED TIRE, BRAKE FAILURE, ETC) 07 - SEPARATION OF UNITS 08 - RAN OFF ROAD RIGHT 09 - RAN OFF ROAD LEFT	10 - CROSS MEDIAN 11 - CROSS CENTER LINE 12 - DOWNHILL RUNAWAY 13 - OTHER NON-COLLISION
---	--	---	--

COLLISION WITH PERSON, VEHICLE OR OBJECT NOT FIXED 14 - PEDESTRIAN 15 - PEDALCYCLE 16 - RAILWAY VEHICLE (TRAIN, ENGINE) 17 - ANIMAL - FARM 18 - ANIMAL - DEER 19 - ANIMAL - OTHER 20 - MOTOR VEHICLE IN TRANSPORT	21 - PARKED MOTOR VEHICLE 22 - WORK ZONE MAINTENANCE EQUIPMENT 23 - STUCK BY FALLING, SHIFTING CARGO OR ANYTHING SET IN MOTION BY A MOTOR VEHICLE 24 - OTHER MOVABLE OBJECT	25 - IMPACT ATTENUATOR/CRASH CUSHION 26 - BRIDGE OVERHEAD STRUCTURE 27 - BRIDGE PIER OR ABUTMENT 28 - BRIDGE PARAPET 29 - BRIDGE RAIL 30 - GUARDRAIL FACE 31 - GUARDRAIL END 32 - PORTABLE BARRIER	33 - MEDIAN CABLE BARRIER 34 - MEDIAN GUARDRAIL BARRIER 35 - MEDIAN CONCRETE BARRIER 36 - MEDIAN OTHER BARRIER 37 - TRAFFIC SIGN POST 38 - OVERHEAD SIGN POST 39 - LIGHT/LUMINARIES SUPPORT 40 - UGLY POLE	41 - OTHER POST, POLE OR SUPPORT 42 - CULVERT 43 - CURB 44 - DITCH 45 - EMBANKMENT 46 - FENCE 47 - MAILBOX	48 - TREE 49 - FIRE HYDRANT 50 - WORK ZONE MAINTENANCE EQUIPMENT 51 - WALL, BUILDING, TUNNEL 52 - OTHER FIXED OBJECT
--	--	---	---	--	--

UNIT SPEED 0	POSTED SPEED 25	TRAFFIC CONTROL 12 01 - NO CONTROL 02 - STOP SIGN 03 - YIELD SIGN 04 - TRAFFIC SIGNAL 05 - TRAFFIC FLASHERS 06 - SCHOOL ZONE	07 - RAILROAD CROSSINGS 08 - RAILROAD FLASHERS 09 - RAILROAD GATES 10 - CONSTRUCTION BARRIAGE 11 - PERSON (FLAGGER, OFFICER) 12 - PAVEMENT MARKINGS	CROSSWALK LINES WALK/DON'T WALK DITCH NOT REPORTED	UNIT DIRECTION FROM 1 TO 2 1 - NORTH 2 - SOUTH 3 - EAST 4 - WEST	5 - NORTHEAST 6 - NORTHWEST 7 - SOUTHEAST 8 - SOUTHWEST 9 - UNKNOWN
------------------------	---------------------------	--	--	---	---	---

LOCAL REPORT NUMBER

UNIT NUMBER 012	OWNER NAME: LAST, FIRST, MIDDLE (<input type="checkbox"/> SAME AS DRIVER) MASON CITY SCHOOLS	OWNER PHONE NUMBER - INC. AREA CODE (<input type="checkbox"/> SAME AS DRIVER) (513) 398-6682	DAMAGE SCALE 2	DAMAGED AREA
OWNER ADDRESS: CITY, STATE, ZIP (<input type="checkbox"/> SAME AS DRIVER) 211 N. EAST STREET MASON, OHIO 45040			1 - NONE	
LP STATE OH	LICENSE PLATE NUMBER 18837	VEHICLE IDENTIFICATION NUMBER 11BAB1K1KASSF2P71271117	2 - MINOR	
VEHICLE YEAR 2004	VEHICLE MAKE BLUEBIRD	VEHICLE MODEL SCHOOL BUS	3 - FUNCTIONAL	
PROOF OF INSURANCE SHOWN <input checked="" type="checkbox"/>	INSURANCE COMPANY OHIO CASUALTY	POLICY NUMBER BA8941011	4 - DISABLING	
CARRIER NAME, ADDRESS, CITY, STATE, ZIP			9 - UNKNOWN	
CARRIER PHONE - INCLUDE AREA CODE				

US DOT	VEHICLE WEIGHT GVWR/GCWR 2 1 - LESS THAN OR EQUAL TO 10K LBS. 2 - 10,001 TO 26,000 LBS. 3 - MORE THAN 26,000 LBS.	CARGO BODY TYPE 03 01 - NO CARGO BODY TYPE/NOT APPLICABLE 02 - BUS/VAN (9-15 SEATS, INC DRIVER) 03 - BUS (16+ SEATS, INC DRIVER) 04 - VEHICLE TOWING ANOTHER VEHICLE 05 - LOGGING 06 - INTERMODAL CONTAINER CHASSIS 07 - CARGO VAN/ENCLOSED BOX 08 - GRAIN, CHIPS, GRAVEL	TRAFFICWAY DESCRIPTION 1 1 - TWO-WAY, NOT DIVIDED 2 - TWO-WAY, NOT DIVIDED, CONTINUOUS LEFT TURN LANE 3 - TWO-WAY, DIVIDED, UNPROTECTED (PAINTED OR GRASS 4-4 FT) MEDIAN 4 - TWO-WAY, DIVIDED, POSITIVE MEDIAN BARRIER 5 - ONE-WAY TRAFFICWAY
HM PLACARD ID No.	<input type="checkbox"/> HAZARDOUS MATERIAL RELEASED	09 - POLE 10 - CARGO TANK 11 - FLAT BED 12 - DUMP 13 - CONCRETE MIXER 14 - AUTO TRANSPORTER 15 - GARBAGE/REFUSE 99 - OTHER/UNKNOWN	<input type="checkbox"/> HIT / SKIP UNIT
HM CLASS NUMBER			

NON-MOTORIST LOCATION PRIOR TO IMPACT 01 01 - INTERSECTION - MARKED CROSSWALK 02 - INTERSECTION - NO CROSSWALK 03 - INTERSECTION - OTHER 04 - MIDBLOCK - MARKED CROSSWALK 05 - TRAVEL LANE - OTHER LOCATION 06 - BICYCLE LANE 07 - SHOULDER/ROADSIDE 08 - SIDEWALK 09 - MEDIAN/CROSSING ISLAND 10 - DRIVEWAY ACCESS 11 - SHARED-USE PATH OR TRAIL 12 - NON-TRAFFICWAY AREA 99 - OTHER/UNKNOWN	TYPE OF USE 3 1 - PERSONAL 2 - COMMERCIAL 3 - GOVERNMENT <input type="checkbox"/> IN EMERGENCY RESPONSE	UNIT TYPE 22 99 - UNKNOWN OR HIT / SKIP	PASSENGER VEHICLES (LESS THAN 9 PASSENGERS) 01 - SUB-COMPACT 02 - COMPACT 03 - MID SIZE 04 - FULL SIZE 05 - MINIVAN 06 - SPORT UTILITY VEHICLE 07 - PICKUP 08 - VAN 09 - MOTORCYCLE 10 - MODIFIED BICYCLE 11 - SNOWMOBILE/ATV 12 - OTHER PASSENGER VEHICLE	MED/HEAVY TRUCKS OR COMBO UNITS > 10K LBS 13 - SINGLE UNIT TRUCK OR VAN 2 AXLE, 6 TIRES 14 - SINGLE UNIT TRUCK 3+ AXLES 15 - SINGLE UNIT TRUCK / TRAILER 16 - TRUCK/TRACTOR (BOBTAIL) 17 - TRACTOR/SEMI-TRAILER 18 - TRACTOR/DOUBLE 19 - TRACTOR/TRIPLE 20 - OTHER MED/HEAVY VEHICLE	BUS/VAN/LIMO (9 OR MORE INCLUDING DRIVER) 21 - BUS/VAN (9-15 SEATS, INC DRIVER) 22 - BUS (16+ SEATS, INC DRIVER) NON-MOTORIST 23 - ANIMAL WITH RIDER 24 - ANIMAL WITH BUGGY, WAGON, SURREY 25 - BICYCLE/PEGACYCLIST 26 - PEDESTRIAN/SEATER 27 - OTHER NON-MOTORIST
<input type="checkbox"/> HAS HM PLACARD					

SPECIAL FUNCTION 04 01 - NONE 02 - TAXI 03 - RENTAL TRUCK (OVER 10K LBS) 04 - BUS - SCHOOL (PUBLIC OR PRIVATE) 05 - BUS - TRANSIT 06 - BUS - CHARTER 07 - BUS - SHUTTLE 08 - BUS - OTHER	09 - AMBULANCE 10 - FIRE 11 - HIGHWAY/MAINTENANCE 12 - MILITARY 13 - POLICE 14 - PUBLIC UTILITY 15 - OTHER GOVERNMENT 16 - CONSTRUCTION EQUIP.	17 - FARM VEHICLE 18 - FARM EQUIPMENT 19 - MOTORHOME 20 - GOLF CART 21 - TRAIN 22 - OTHER (EXPLAIN IN NARRATIVE)	MOST DAMAGED AREA 02 01 - NONE 02 - CENTER FRONT 03 - RIGHT FRONT 04 - RIGHT SIDE 05 - RIGHT REAR 06 - REAR CENTER 07 - LEFT REAR	08 - LEFT SIDE 09 - LEFT FRONT 10 - TOP AND WINDOWS 11 - UNDERCARRIAGE 12 - LOAD/TRAILER 13 - TOTAL(ALL AREAS) 14 - OTHER	99 - UNKNOWN	ACTION 3 1 - NON-CONTACT 2 - NON-COLLISION 3 - STRIKING 4 - STRUCK 5 - STRIKING/STRUCK 9 - UNKNOWN
--	---	---	--	---	--------------	--

PRE-CRASH ACTIONS 01 99 - UNKNOWN	MOTORIST 01 - STRAIGHT AHEAD 02 - BACKING 03 - CHANGING LANES 04 - OVERTAKING/PASSING 05 - MAKING RIGHT TURN 06 - MAKING LEFT TURN	07 - MAKING U-TURN 08 - ENTERING TRAFFIC LANE 09 - LEAVING TRAFFIC LANE 10 - PARKED 11 - SLOWING OR STOPPED IN TRAFFIC 12 - DRIVERLESS	13 - NEGOTIATING A CURVE 14 - OTHER MOTORIST ACTION	NON-MOTORIST 15 - ENTERING OR CROSSING SPECIFIED LOCATION 16 - WALKING, RUNNING, JOGGING, PLAYING, CYCLING 17 - WORKING 18 - PUSHING VEHICLE 19 - APPROACHING OR LEAVING VEHICLE 20 - STANDING	21 - OTHER NON-MOTORIST ACTION
--	--	---	--	--	--------------------------------

CONTRIBUTING CIRCUMSTANCES	PRIMARY 09	MOTORIST 01 - NONE 02 - FAILURE TO YIELD 03 - RAN RED LIGHT 04 - RAN STOP SIGN 05 - EXCEEDED SPEED LIMIT 06 - UNSAFE SPEED 07 - IMPROPER TURN 08 - LEFT OF CENTER 09 - FOLLOWED TOO CLOSELY/ACDA 10 - IMPROPER LANE CHANGE /PASSING/OFF ROAD	11 - IMPROPER BACKING 12 - IMPROPER START FROM PARKED POSITION 13 - STOPPED OR PARKED ILLEGALLY 14 - OPERATING VEHICLE IN NEGLIGENT MANNER 15 - SWERVING TO AVOID (DUE TO EXTERNAL CONDITIONS) 16 - WRONG SIDE/WRONG WAY 17 - FAILURE TO CONTROL 18 - VISION OBSTRUCTION 19 - OPERATING DEFECTIVE EQUIPMENT 20 - LOAD SHIFTING/FALLING/SPILLING 21 - OTHER IMPROPER ACTION	NON-MOTORIST 22 - NONE 23 - IMPROPER CROSSING 24 - DARTING 25 - LYING AND/OR ILLEGALLY IN ROADWAY 26 - FAILURE TO YIELD RIGHT OF WAY 27 - NOT VISIBLE (DARK CLOTHING) 28 - INATTENTIVE 29 - FAILURE TO OBEY TRAFFIC SIGNS /SIGNALS/OFFICER 30 - WRONG SIDE OF THE ROAD 31 - OTHER NON-MOTORIST ACTION	VEHICLE DEFECTS 01 01 - TURN SIGNALS 02 - HEAD LAMPS 03 - TAIL LAMPS 04 - BRAKES 05 - STEERING 06 - TIRE BLOWOUT 07 - WORN OR SLICK TIRES 08 - TRAILER EQUIPMENT DEFECTIVE 09 - MOTOR TROUBLE 10 - DISABLED FROM PRIOR ACCIDENT 11 - OTHER DEFECTS
----------------------------	----------------------	--	--	---	---

SEQUENCE OF EVENTS	1 30	2	3	4	5	6	NON-COLLISION EVENTS 01 - OVERTURN/ROLLOVER 02 - FIRE/EXPLOSION 03 - IMMERSION 04 - JACKKNIFE 05 - CARGO/EQUIPMENT LOSS OR SHIFT	06 - EQUIPMENT FAILURE (BLOWN TIRE, BRAKE FAILURE, ETC) 07 - SEPARATION OF UNITS 08 - RAN OFF ROAD RIGHT 09 - RAN OFF ROAD LEFT	10 - CROSS MEDIAN 11 - CROSS CENTER LANE 12 - DOWNHILL RUNAWAY 13 - OTHER NON-COLLISION
	FIRST HARMFUL EVENT		MOST HARMFUL EVENT				99 - UNKNOWN		
COLLISION WITH PERSON, VEHICLE OR OBJECT NOT FIXED									
14 - PEDESTRIAN 15 - PEGACYCLE 16 - RAILWAY VEHICLE (TRAIN/ENGINE) 17 - ANIMAL - FARM 18 - ANIMAL - DEER 19 - ANIMAL - OTHER 20 - MOTOR VEHICLE IN TRANSPORT	21 - PARKED MOTOR VEHICLE 22 - WORK ZONE MAINTENANCE EQUIPMENT 23 - STUCK BY FALLING, SHIFTING CARGO OR ANYTHING SET IN MOTION BY A MOTOR VEHICLE 24 - OTHER MOVABLE OBJECT	25 - IMPACT ATTENUATOR/CRASH CUSHION 26 - BRIDGE OVERHEAD STRUCTURE 27 - BRIDGE PIER OR ABUTMENT 28 - BRIDGE PARAPET 29 - BRIDGE RAIL 30 - GUARDRAIL FACE 31 - GUARDRAIL END 32 - PORTABLE BARRIER	33 - MEDIAN CABLE BARRIER 34 - MEDIAN GUARDRAIL BARRIER 35 - MEDIAN CONCRETE BARRIER 36 - MEDIAN OTHER BARRIER 37 - TRAFFIC SIGN POST 38 - OVERHEAD SIGN POST 39 - LIGHT/LUMINAIRE SUPPORT 40 - UTILITY POLE	41 - OTHER POST, POLE OR SUPPORT 42 - CURB 43 - CURB 44 - DITCH 45 - EMBANKMENT 46 - FENCE 47 - MAILBOX	48 - TREE 49 - FIRE HYDRANT 50 - WORK ZONE MAINTENANCE EQUIPMENT 51 - WALL, BUILDING, TUNNEL 52 - OTHER FIXED OBJECT				

UNIT SPEED 25	POSTED SPEED 25	TRAFFIC CONTROL 12 01 - NO CONTROLS 02 - STOP SIGN 03 - YIELD SIGN 04 - TRAFFIC SIGNAL 05 - TRAFFIC FLASHERS 06 - SCHOOL ZONE	07 - RAILROAD CROSSINGS 08 - RAILROAD FLASHERS 09 - RAILROAD GATES 10 - CONSTRUCTION BARRICADE 11 - PERSON (FLAGGER, OFFICER) 12 - PAVEMENT MARKINGS	13 - CROSSWALK LINES 14 - WALK/DON'T WALK 15 - OTHER 16 - NOT REPORTED	UNIT DIRECTION From 1 To 2 1 - NORTH 2 - SOUTH 3 - EAST 4 - WEST	5 - NORTHEAST 6 - NORTHWEST 7 - SOUTHEAST 8 - SOUTHWEST 9 - UNKNOWN
-------------------------	---------------------------	---	---	---	---	---



LOCAL REPORT NUMBER	REPORTING AGENCY MASON POLICE	DATE OF CRASH M 11 D 21 Y 14
IN COUNTY OF WARREN	CRASH LOCATION 400 READING ROAD	

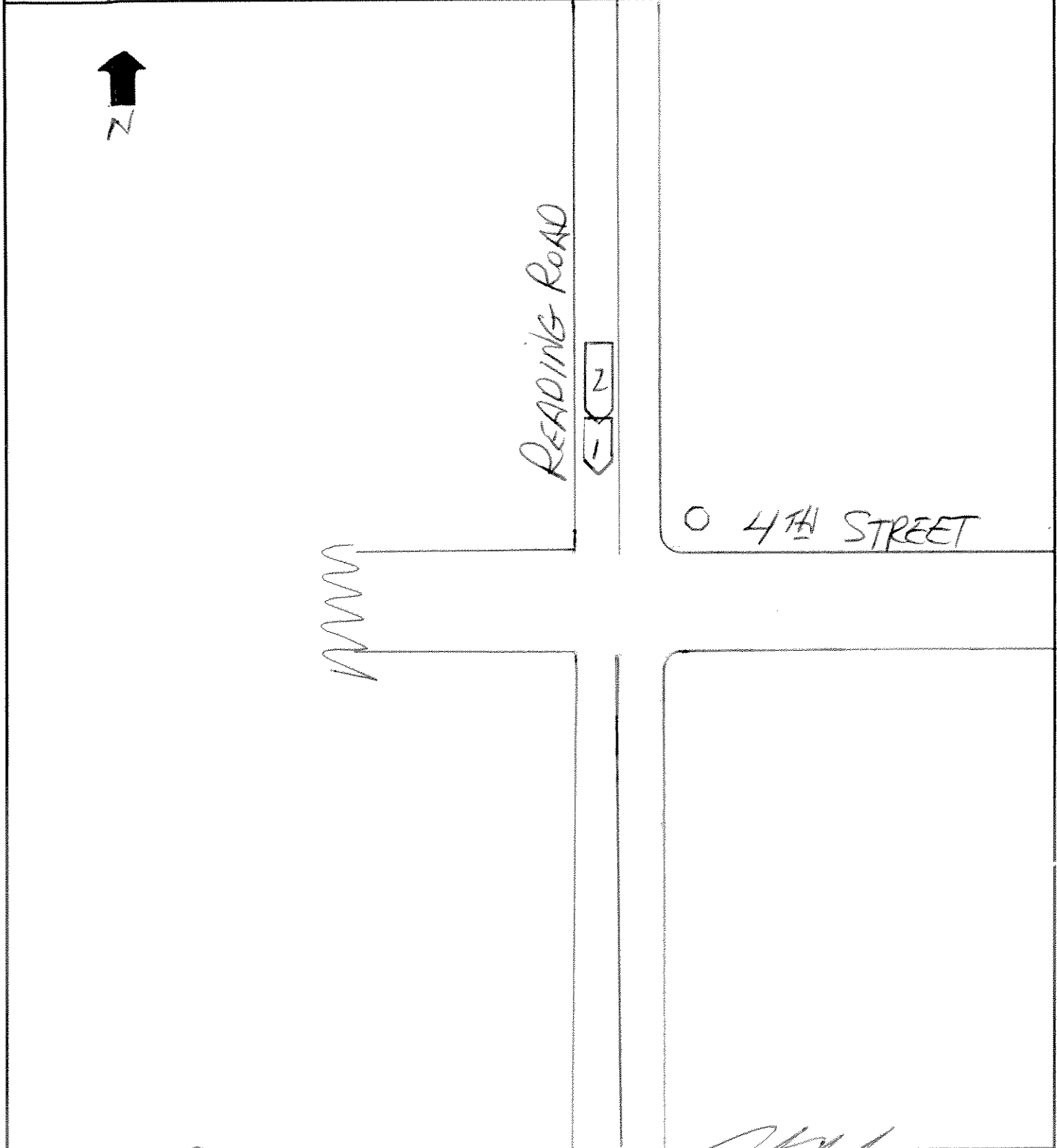

NOT TO SCALE

OFFICER'S SIGNATURE X <i>[Signature]</i>	BADGE NUMBER 42
---	--------------------



LOCAL REPORT NUMBER

REPORTING AGENCY

MASON POLICE

11 21 14

FOR LOCAL USE ONLY - DO NOT SUBMIT TO THE STATE EXCEPT FOR FATAL CRASHES

I, Mary Wilson PRINTED HEREBY MAKE THIS VOLUNTARY STATEMENT TO
P.O. Andrew Herrlinger OFFICER'S NAME AT 14th Street on Reading Road LOCATION

At 8:45 was driving bus down Reading. Heard something & glanced in mirror. When I looked up car had stopped in front of me. Tried to stop But still hit car in front of me.

Q. WERE YOU, OR ANYONE IN YOUR VEHICLE INJURED? NO

Q. WERE YOU WEARING YOUR SEAT BELT? Yes

Q. WHAT DIRECTION WERE YOU GOING? South

Q. WHAT WAS YOUR SPEED? 25 mph

Q. WERE YOU USING A CELL PHONE AT THE TIME OF THE CRASH? NO

ADDRESS OF WITNESS
300 Nightwind Drive Mainerville, Ohio 45039

PHONE
(513) 697-0405

SIGNATURE OF WITNESS
X Mary Wilson

OFFICER'S SIGNATURE
X Andrew Herrlinger 42