



Traffic Crash Report

Local Report Number *	Crash Severity	Hit/Skip
2014-13134	<input checked="" type="checkbox"/> 1 - Fatal <input type="checkbox"/> 2 - Injury <input type="checkbox"/> 3 - PDO	<input type="checkbox"/> 1 - Solved <input type="checkbox"/> 2 - Unsolved

Local Information		Reporting Agency NCIC *	Reporting Agency Name *	Number of Units	Unit in error
<input checked="" type="checkbox"/> Photos Taken <input type="checkbox"/> OH-2 <input type="checkbox"/> OH-1P <input checked="" type="checkbox"/> OH-3 <input type="checkbox"/> Other	<input type="checkbox"/> PDO Under State Reportable Dollar Amount	<input type="checkbox"/> Private Property	08304 Mason Police Dept.	02	<input type="checkbox"/> 98 - Animal <input type="checkbox"/> 99 - Unknown

County *	City *	City, Village, Township *	Crash Date *	Time of Crash	Day of Week
013	<input checked="" type="checkbox"/> City * <input type="checkbox"/> Village * <input type="checkbox"/> Township *	City of Mason	04262014	1234	SAT

Degrees / Minutes / Seconds	Longitude	Decimal Degrees	Longitude
Latitude: 39° 20' 14.58"	39.337384	Latitude: 84° 19' 22.67"	84.322965

Roadway Division	Divided Lane Direction of Travel	Number of Thru Lanes	Road Types or Milepost *
<input type="checkbox"/> Divided <input checked="" type="checkbox"/> Undivided	<input type="checkbox"/> N - Northbound E - Eastbound <input type="checkbox"/> S - Southbound W - Westbound	02	AL - Alley CR - Circle HE - Heights MP - Milepost PL - Place ST - Street WA - Way AV - Avenue CT - Court HW - Highway PK - Parkway RD - Road TE - Terrace BL - Boulevard DR - Drive LA - Lane PI - Pike SQ - Square TL - Trail

Location Route Number	Location Road Name	Location Road Type	Route Types
03	Indianwood	DR	IR - Interstate Route (inc. turnpike) CR - Numbered County Route US - US Route TR - Numbered Township Route SR - State Route

Distance From Reference	Dir From Ref	Reference	Reference Route Number	Ref Prefix	Reference Name (Road, Milepost, House #)	Reference Road Type
0	<input type="checkbox"/> Miles <input type="checkbox"/> Feet <input type="checkbox"/> Yards	<input type="checkbox"/> N, S, E, W	03	<input type="checkbox"/> N, S, E, W	Western Row	RD

Reference Point Used	Crash Location	Intersection Related	Location of First Harmful Event
<input checked="" type="checkbox"/> 1 - Intersection <input type="checkbox"/> 2 - Mile Post <input type="checkbox"/> 3 - House Number	<input checked="" type="checkbox"/> 01 - Not an intersection <input type="checkbox"/> 02 - Four-way Intersection <input type="checkbox"/> 03 - T-Intersection <input type="checkbox"/> 04 - Y-Intersection <input type="checkbox"/> 05 - Traffic Circle/Roundabout	<input type="checkbox"/> 06 - Five-point, or more <input type="checkbox"/> 07 - On Ramp <input type="checkbox"/> 08 - Off Ramp <input type="checkbox"/> 09 - Crossover <input type="checkbox"/> 10 - Driveway/Alley Access	<input checked="" type="checkbox"/> 1 - On Roadway <input type="checkbox"/> 2 - On Shoulder <input type="checkbox"/> 3 - In Median <input type="checkbox"/> 4 - On Roadside <input type="checkbox"/> 5 - On Gore <input type="checkbox"/> 6 - Outside Trafficway <input type="checkbox"/> 9 - Unknown

Road Contour	Road Conditions	Weather
<input checked="" type="checkbox"/> 1 - Straight Level <input type="checkbox"/> 2 - Straight Grade <input type="checkbox"/> 3 - Curve Level <input type="checkbox"/> 4 - Curve Grade <input type="checkbox"/> 9 - Unknown	<input checked="" type="checkbox"/> 01 - Dry <input type="checkbox"/> 02 - Wet <input type="checkbox"/> 03 - Snow <input type="checkbox"/> 04 - Ice <input type="checkbox"/> 05 - Sand, Mud, Dirt, Oil, Gravel <input type="checkbox"/> 06 - Water (Standing, Moving) <input type="checkbox"/> 07 - Slush <input type="checkbox"/> 08 - Debris* <input type="checkbox"/> 09 - Rut, Holes, Bumps, Uneven Pavement* <input type="checkbox"/> 10 - Other <input type="checkbox"/> 99 - Unknown	<input checked="" type="checkbox"/> 1 - Clear <input type="checkbox"/> 2 - Cloudy <input type="checkbox"/> 3 - Fog, Smog, Smoke <input type="checkbox"/> 4 - Rain <input type="checkbox"/> 5 - Sleet, Hail <input type="checkbox"/> 6 - Snow <input type="checkbox"/> 7 - Severe Crosswinds <input type="checkbox"/> 8 - Blowing Sand, Soil, Dirt, Snow <input type="checkbox"/> 9 - Other/Unknown

Manner of Crash Collision/Impact	Weather
<input checked="" type="checkbox"/> 1 - Not Collision Between Two Motor Vehicles In Transport <input type="checkbox"/> 2 - Rear-End <input type="checkbox"/> 3 - Head-On <input type="checkbox"/> 4 - Rear-to-Rear <input type="checkbox"/> 5 - Backing <input type="checkbox"/> 6 - Angle <input type="checkbox"/> 7 - Sideswipe, Same Direction <input type="checkbox"/> 8 - Sideswipe, Opposite Direction <input type="checkbox"/> 9 - Unknown	<input checked="" type="checkbox"/> 1 - Clear <input type="checkbox"/> 2 - Cloudy <input type="checkbox"/> 3 - Fog, Smog, Smoke <input type="checkbox"/> 4 - Rain <input type="checkbox"/> 5 - Sleet, Hail <input type="checkbox"/> 6 - Snow <input type="checkbox"/> 7 - Severe Crosswinds <input type="checkbox"/> 8 - Blowing Sand, Soil, Dirt, Snow <input type="checkbox"/> 9 - Other/Unknown

Road Surface	Light Conditions	School Bus Related
<input checked="" type="checkbox"/> 1 - Concrete <input type="checkbox"/> 2 - Blacktop, Bituminous, Asphalt <input type="checkbox"/> 3 - Brick/Block <input type="checkbox"/> 4 - Slag, Gravel, Stone <input type="checkbox"/> 5 - Dirt <input type="checkbox"/> 6 - Other	<input checked="" type="checkbox"/> Primary <input type="checkbox"/> Secondary	<input type="checkbox"/> School Zone Related <input type="checkbox"/> Yes, School Bus Directly Involved <input type="checkbox"/> Yes, School Bus Indirectly Involved

Work Zone Related	Type of Work Zone	Location of Crash in Work Zone
<input type="checkbox"/> Workers Present <input type="checkbox"/> Law Enforcement Present (Officer/Vehicle) <input type="checkbox"/> Law Enforcement Present (Vehicle Only)	<input type="checkbox"/> 1 - Lane Closure <input type="checkbox"/> 2 - Lane Shift/Crossover <input type="checkbox"/> 3 - Work on Shoulder or Median <input type="checkbox"/> 4 - Intermittent or Moving Work <input type="checkbox"/> 5 - Other	<input type="checkbox"/> 1 - Before the First Work Zone Warning Sign <input type="checkbox"/> 2 - Advance Warning Area <input type="checkbox"/> 3 - Transition Area <input type="checkbox"/> 4 - Activity Area <input type="checkbox"/> 5 - Termination Area

Narrative

Unit #1 was stopped on Indianwood Dr. @ the intersection of Western Row Rd. Unit #2 was stopped directly behind Unit #1 on Indianwood Dr. Unit #1 proceeded to start to turn left, but saw another on Western Row Rd. approaching from the west and had to back up to avoid it. Unit #1 failed to look behind and improperly backed into Unit #2.

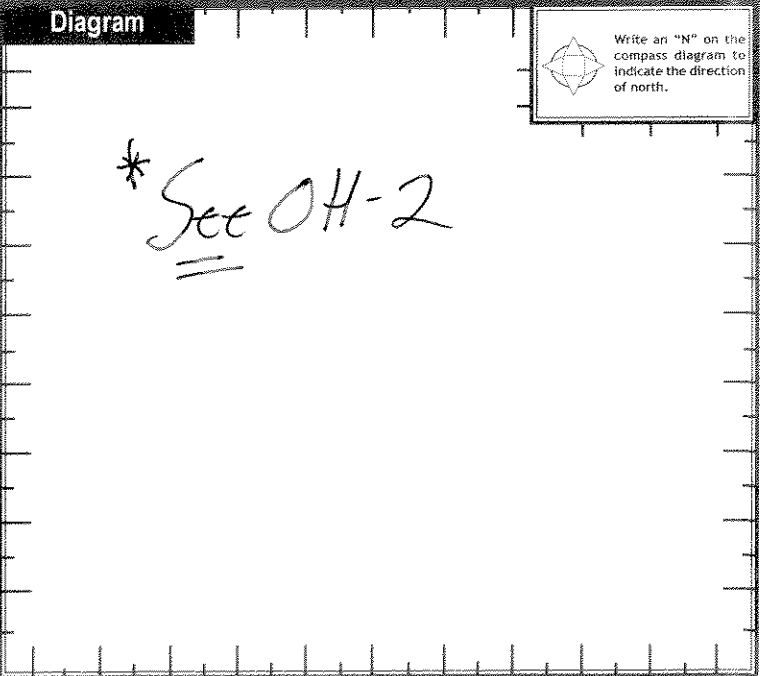

Report Taken By	Supplement (Correction or Addition to an Existing Report Sent to GDPS)	Date Crash Reported	Time Crash Reported	Dispatch Time	Arrival Time	Time Cleared	Other Investigation Time	Total Minutes
<input checked="" type="checkbox"/> Police Agency <input type="checkbox"/> Motorist	<input type="checkbox"/>	04262014	1234	11234	11253	11324	11319	11910
Officer's Name *	Officer's Badge Number	Checked By	Page 1 of 4					
P.O. Budwick	1045	55/50						



Unit

Local Report Number
2014-13138

Unit Number 011	Owner Name: Last, First, Middle (<input checked="" type="checkbox"/> Same As Driver)	Owner Phone Number - inc. area code (<input checked="" type="checkbox"/> Same As Driver)	Damage Scale 2	
Owner Address: City, State, Zip (<input checked="" type="checkbox"/> Same As Driver)			1 - None	
LP State OH	License Plate Number EEM7389	Vehicle Identification Number J.F.T.P.P.W.H.V.6.B.K.4.78438	2 - Minor	
Vehicle Year 2006	Vehicle Make Ford	Vehicle Model F-150	3 - Functional	
Vehicle Color gold	Proof of Insurance shown <input checked="" type="checkbox"/>	Insurance Company Motorist Mutual	4 - Disabling	
	Policy Number 7175-06-51515354	Towed By	9 - Unknown	

Carrier Name, Address, City, State, Zip	Carrier Phone- include area code
US DOT	Vehicle Weight GVWR/GCWR 1 - Less Than or Equal to 10k lbs. 2 - 10,001 to 26,000 lbs. 3 - More Than 26,000 lbs.
HM Placard ID No.	Cargo Body Type 01 - No Cargo Body Type/Not Applicable 02 - Bus/Van (9-15 Seats, Inc Driver) 03 - Bus (16+ Seats, Inc Driver) 04 - Vehicle Towing Another Vehicle 05 - Logging 06 - Intermodal Container Chassis 07 - Cargo Van/Enclosed Box 08 - Grain, Chips, Gravel
HM Class Number	Trafficway Description 1 - Two-Way, Not Divided 2 - Two-Way, Not Divided, Continuous Left Turn Lane 3 - Two-Way, Divided, Unprotected/Passive or (2+ ft) Median 4 - Two-Way, Divided, Positive Median Barrier 5 - One-Way Trafficway
<input type="checkbox"/> Hazardous Material Released	<input type="checkbox"/> Hit / Skip Unit

Non-Motorist Location Prior to Impact 01 - Intersection - Marked Crosswalk 02 - Intersection - No Crosswalk 03 - Intersection - Other 04 - Midblock - Marked Crosswalk 05 - Travel Lane - Other Location 06 - Bicycle Lane 07 - Shoulder/Roadside 08 - Sidewalk 09 - Median/Crossing Island 10 - Driveway Access 11 - Shared-Use Path or Trail 12 - Non-Trafficway Area 99 - Other/Unknown	Type of Use 1 - Personal 2 - Commercial 3 - Government <input type="checkbox"/> In Emergency Response	Unit Type 01 - Passenger Vehicles (less than 9 passengers) 02 - Sub-Compact 03 - Compact 04 - Mid Size 05 - Full Size 06 - Minivan 07 - Sport Utility Vehicle 08 - Pickup 09 - Van 10 - Motorcycle 11 - Motorized Bicycle 12 - Other Passenger Vehicle	Med/Heavy Trucks or Combo Units > 10k lbs 13 - Single Unit Truck or Van 2axle, 6 tires 14 - Single Unit Truck; 3+ axles 15 - Single Unit Truck / Trailer 16 - Truck/Tractor (Bobtail) 17 - Tractor/Semi-Trailer 18 - Tractor/Double 19 - Tractor/Triples 20 - Other Med/Heavy Vehicle	Bus/Van/Limo (9 or More Including Driver) 21 - Bus/Van (9-15 Seats, Inc Driver) 22 - Bus (16+ Seats, Inc Driver) Non-Motorist 23 - Animal with Rider 24 - Animal with Buggy, Wagon, Surrey 25 - Bicycle/Pedacyclist 26 - Pedestrian/Skater 27 - Other Non-Motorist
<input type="checkbox"/> Has HM Placard				

Special Function 01 - None 02 - Taxi 03 - Rental Truck (Over 10k lbs) 04 - Bus - School (Public or Private) 05 - Bus - Transit 06 - Bus - Charter 07 - Bus - Shuttle 08 - Bus - Other	09 - Ambulance 10 - Fire 11 - Highway/Maintenance 12 - Military 13 - Police 14 - Public Utility 15 - Other Government 16 - Construction Equip.	17 - Farm Vehicle 18 - Farm Equipment 19 - Motorhome 20 - Golf Cart 21 - Train 22 - Other (Explain in Narrative)	Most Damaged Area 01 - None 02 - Center Front 03 - Right Front 04 - Right Side 05 - Right Rear 06 - Rear Center 07 - Left Rear	08 - Left Side 09 - Left Front 10 - Top and Windows 11 - Undercarriage 12 - Load/Trailer 13 - Total/All Areas 14 - Other	Action 01 - Non-Contact 02 - Non-Collision 03 - Striking 04 - Struck 05 - Striking/Struck 09 - Unknown
---	---	---	---	--	--

Pre-Crash Actions 01 - Motorist 02 - Straight Ahead 03 - Backing 04 - Changing Lanes 05 - Overtaking/Passing 06 - Making Right Turn 07 - Making Left Turn 99 - Unknown	07 - Making U-Turn 08 - Entering Traffic Lane 09 - Leaving Traffic Lane 10 - Parked 11 - Slowing or Stopped in Traffic 12 - Driverless	13 - Negotiating a Curve 14 - Other Motorist Action	Non-Motorist 15 - Entering or Crossing Specified Location 16 - Walking, Running, Jogging, Playing, Cycling 17 - Working 18 - Pushing Vehicle 19 - Approaching or Leaving Vehicle 20 - Standing	21 - Other Non-Motorist Action
--	---	--	--	--------------------------------

Contributing Circumstances Primary 01 - None 02 - Failure to Yield 03 - Ran Red Light 04 - Ran Stop Sign 05 - Exceeded Speed Limit 06 - Unsafe Speed 07 - Improper Turn 08 - Left of Center 09 - Followed Too Closely/ACDA 10 - Improper Lane Change /Passing/Off Road	Motorist 11 - Improper Backing 12 - Improper Start From Parked Position 13 - Stopped or Parked Illegally 14 - Operating Vehicle in Negligent Manner 15 - Swerving to Avoid (Due to External Conditions) 16 - Wrong Side/Wrong Way 17 - Failure to Control 18 - Vision Obstruction 19 - Operating Defective Equipment 20 - Load Shifting/Falling/Spilling 21 - Other Improper Action	Non-Motorist 22 - None 23 - Improper Crossing 24 - Dangling 25 - Lying and/or Illegally in Roadway 26 - Failure to Yield Right of Way 27 - Not Visible (Dark Clothing) 28 - Inattentive 29 - Failure to Obey Traffic Signs /Signals/Officer 30 - Wrong Side of the Road 31 - Other Non-Motorist Action	Vehicle Defects 01 - Turn Signals 02 - Head Lamps 03 - Tail Lamps 04 - Brakes 05 - Steering 06 - Tire Blowout 07 - Worn or Stick tires 08 - Trailer Equipment Defective 09 - Motor Trouble 10 - Disabled From Prior Accident 11 - Other Defects
---	--	--	--

Sequence of Events 1 20 2 <input type="checkbox"/> 3 <input type="checkbox"/> 4 <input type="checkbox"/> 5 <input type="checkbox"/> 6 <input type="checkbox"/> First Harmful Event 1 Most Harmful Event 1 99 - Unknown	Non-Collision Events 01 - Overturn/Rollover 02 - Fire/Explosion 03 - Immersion 04 - Jackknife 05 - Cargo/Equipment Loss or Shift	06 - Equipment Failure (Blown Tire, Brake Failure, etc) 07 - Separation of Units 08 - Ran Off Road Right 09 - Ran Off Road Left 10 - Cross Median 11 - Cross Center Line Opposite Direction of Travel 12 - Downhill Runaway 13 - Other Non-Collision
Collision with Person, Vehicle or Object Not Fixed 14 - Pedestrian 15 - Pedacycle 16 - Railway Vehicle (Tram, Light Rail) 17 - Animal - Farm 18 - Animal - Deer 19 - Animal - Other 20 - Motor Vehicle in Transport	21 - Parked Motor Vehicle 22 - Work Zone Maintenance Equipment 23 - Struck by Falling, Shifting Cargo or Anything Set in Motion by a Motor Vehicle 24 - Other Movable Object	Collision With Fixed Object 25 - Impact Attenuator/Crash Cushion 26 - Bridge Overhead Structure 27 - Bridge Pier or Abutment 28 - Bridge Parapet 29 - Bridge Rail 30 - Guardrail Face 31 - Guardrail End 32 - Portable Barrier
33 - Median Cable Barrier 34 - Median Guardrail Barrier 35 - Median Concrete Barrier 36 - Median Other Barrier 37 - Traffic Sign Post 38 - Overhead Sign Post 39 - Light/Luminaries Support 40 - Utility Pole	41 - Other Post, Pole or Support 42 - Culvert 43 - Curb 44 - Ditch 45 - Embankment 46 - Fence 47 - Mailbox	48 - Tree 49 - Fire Hydrant 50 - Work Zone Maintenance Equipment 51 - Wall, Building, Tunnel 52 - Other Fixed Object

Unit Speed 15	Posted Speed 25	Traffic Control 02	Unit Direction From 1 To 2
<input type="checkbox"/> Stated <input checked="" type="checkbox"/> Estimated		01 - No Controls 02 - Stop Sign 03 - Yield Sign 04 - Traffic Signal 05 - Traffic Flashers 06 - School Zone 07 - Railroad Crossbucks 08 - Railroad Flashers 09 - Railroad Gates 10 - Construction Barricade 11 - Person (Flagger, Officer) 12 - Pavement Markings 13 - Crosswalk Lines 14 - Walk/Dom Walk 15 - Other 16 - Not Reported	1 - North 2 - South 3 - East 4 - West 5 - Northeast 6 - Northwest 7 - Southeast 8 - Southwest 9 - Unknown

Unit Number 02	Owner Name: Last, First, Middle (<input checked="" type="checkbox"/> Same As Driver)	Owner Phone Number - inc. area code (<input checked="" type="checkbox"/> Same As Driver)	Damage Scale 2	Damaged Area
LP State OH	License Plate Number EMP 2554	Vehicle Identification Number 3A1B1FY581949T611631131	# Occupants 13	
Vehicle Year 2009	Vehicle Make Chrysler	Vehicle Model PT Cruiser	Vehicle Color Silver	
<input type="checkbox"/> Proof of Insurance Shown	Insurance Company Safeco Ins.	Policy Number K1706266	Towed By	

Carrier Name, Address, City, State, Zip _____ Carrier Phone- include area code _____

US DOT	Vehicle Weight GVWR/GCWR 1 1 - Less Than or Equal to 10k Lbs. 2 - 10,001 to 26,000 Lbs. 3 - More Than 26,000 Lbs.	Cargo Body Type 01 01 - No Cargo Body Type/Not Applicable 02 - Bus/Van (9-15 Seats, Inc Driver) 03 - Bus (16+ Seats, Inc Driver) 04 - Vehicle Towing Another Vehicle 05 - Logging 06 - Intermodal Container Chassis 07 - Cargo Van/Enclosed Box 08 - Grain, Chips, Gravel	Trafficway Description 1 1 - Two-Way, Not Divided 2 - Two-Way, Not Divided, Continuous Left Turn Lane 3 - Two-Way, Divided, Unprotected (Paved or Gravel - 4 Ft.) Median 4 - Two-Way, Divided, Positive Median Barrier 5 - One-Way Trafficway
HM Placard ID No.	<input type="checkbox"/> Hazardous Material Released		<input type="checkbox"/> Hit / Skip Unit

Non-Motorist Location Prior to Impact 01 01 - Intersection - Marked Crosswalk 02 - Intersection - No Crosswalk 03 - Intersection - Other 04 - Midblock - Marked Crosswalk 05 - Travel Lane - Other Location 06 - Bicycle Lane 07 - Shoulder/Roadside 08 - Sidewalk 09 - Median/Crossing Island 10 - Driveway Access 11 - Shared-Use Path or Trail 12 - Non-Trafficway Area 99 - Other/Unknown	Type of Use 1 1 - Personal 2 - Commercial 3 - Government <input type="checkbox"/> In Emergency Response	Unit Type 03 Passenger Vehicles (less than 9 passengers) 01 - Sub-Compact 02 - Compact 03 - Mid Size 04 - Full Size 05 - Minivan 06 - Sport Utility Vehicle 07 - Pickup 08 - Van 09 - Motorcycle 10 - Motorized Bicycle 11 - Snowmobile/ATV 12 - Other Passenger Vehicle	Med/Heavy Trucks or Combo Units > 10k lbs 13 - Single Unit Truck or Van 2axle, 6 tires 14 - Single Unit Truck; 3+ axles 15 - Single Unit Truck / Trailer 16 - Truck/Tractor (Bobtail) 17 - Tractor/Semi-Trailer 18 - Tractor/Double 19 - Tractor/Trigles 20 - Other Med/Heavy Vehicle	Bus/Van/Limo (9 or More Including Driver) 21 - Bus/Van (9-15 Seats, Inc Driver) 22 - Bus (16+ Seats, Inc Driver) Non-Motorist 23 - Animal with Rider 24 - Animal with Buggy, Wagon, Sundry 25 - Bicycle/Pedacyclist 26 - Pedestrian/Skater 27 - Other Non-Motorist
<input type="checkbox"/> Has HM Placard				

Special Function 01 01 - None 02 - Taxi 03 - Rental Truck (over 10k lbs) 04 - Bus - School (Public or Private) 05 - Bus - Transit 06 - Bus - Charter 07 - Bus - Shuttle 08 - Bus - Other	09 - Ambulance 10 - Fire 11 - Highway/Maintenance 12 - Military 13 - Police 14 - Public Utility 15 - Other Government 16 - Construction Equip.	17 - Farm Vehicle 18 - Farm Equipment 19 - Motorhome 20 - Golf Carr 21 - Train 22 - Other (Explain in Narrative)	Most Damaged Area 02 01 - None 02 - Center Front 03 - Right Front 04 - Right Side 05 - Right Rear 06 - Rear Center 07 - Left Rear	08 - Left Side 09 - Left Front 10 - Top and Windows 11 - Undercarriage 12 - Load/Trailer 13 - Total(AH Area) 14 - Other	Action 4 1 - Non-Contact 2 - Non-Collision 3 - Striking 4 - Struck 5 - Striking/Struck 9 - Unknown
--	---	---	--	---	--

Pre-Crash Actions 01 99 - Unknown	Motorist 01 - Straight Ahead 02 - Backing 03 - Changing Lanes 04 - Overtaking/Passing 05 - Making Right Turn 06 - Making Left Turn	07 - Making U-Turn 08 - Entering Traffic Lane 09 - Leaving Traffic Lane 10 - Parked 11 - Slowing or Stopped in Traffic 12 - Driverless	13 - Negotiating a Curve 14 - Other Motorist Action	Non-Motorist 15 - Entering or Crossing Specified Location 16 - Walking, Running, Jogging, Playing, Cycling 17 - Working 18 - Pushing Vehicle 19 - Approaching or Leaving Vehicle 20 - Standing	21 - Other Non-Motorist Action
--	--	---	--	--	--------------------------------

Contributing Circumstances 01 99 - Unknown	Motorist 01 - None 02 - Failure to Yield 03 - Ran Red Light 04 - Ran Stop Sign 05 - Exceeded Speed Limit 06 - Unsafe Speed 07 - Improper Turn 08 - Left of Center 09 - Followed Too Closely/ACDA 10 - Improper Lane Change /Passing/Off Road	11 - Improper Backing 12 - Improper Start From Parked Position 13 - Stopped or Parked Illegally 14 - Operating Vehicle in Negligent Manner 15 - Swerving to Avoid (Due to External Conditions) 16 - Wrong Side/Wrong Way 17 - Failure to Control 18 - Vision Obstruction 19 - Operating Defective Equipment 20 - Load Shifting/Falling/Spilling 21 - Other Improper Action	Non-Motorist 22 - None 23 - Improper Crossing 24 - Dairing 25 - Lying and/or Illegally in Roadway 26 - Failure to Yield Right of Way 27 - Not Visible (Dark Clothing) 28 - Inattentive 29 - Failure to Obey Traffic Signs /Signals/Officer 30 - Wrong Side of the Road 31 - Other Non-Motorist Action	Vehicle Defects 01 01 - Turn Signals 02 - Head Lamps 03 - Tail Lamps 04 - Brakes 05 - Steering 06 - Tire Blowout 07 - Worn or Slick tires 08 - Trailer Equipment Defective 09 - Motor Trouble 10 - Disabled From Prior Accident 11 - Other Defects
---	--	--	---	---

Sequence of Events 1 06 2 01 3 01 4 01 5 01 6 01 First Harmful Event 1 Most Harmful Event 1 99 - Unknown	Non-Collision Events 01 - Overturn/Rollover 02 - Fire/Explosion 03 - Immersion 04 - Jackknife 05 - Cargo/Equipment Loss or Shift	06 - Equipment Failure (Broken Tire, Brake Failure, etc) 07 - Separation of Units 08 - Ran Off Road Right 09 - Ran Off Road Left	10 - Cross Median 11 - Cross Center Line (Opposite Direction of Travel) 12 - Downhill Runaway 13 - Other Non-Collision
Collision with Person, Vehicle or Object Not Fixed 14 - Pedestrian 15 - Pedalcycle 16 - Railway Vehicle (Train, Engine) 17 - Animal - Farm 18 - Animal - Deer 19 - Animal - Other 20 - Motor Vehicle in Transport	21 - Parked Motor Vehicle 22 - Work Zone Maintenance Equipment 23 - Struck by Falling, Shifting Cargo or Anything Set in Motion by a Motor Vehicle 24 - Other Movable Object	Collision With Fixed Object 25 - Impact Attenuator/Crash Cushion 26 - Bridge Overhead Structure 27 - Bridge Pier or Abutment 28 - Bridge Parapet 29 - Bridge Rail 30 - Guardrail Face 31 - Guardrail End 32 - Portable Barrier	33 - Median Cable Barrier 34 - Median Guardrail Barrier 35 - Median Concrete Barrier 36 - Median Other Barrier 37 - Traffic Sign Post 38 - Overhead Sign Post 39 - Light/Luminaries Support 40 - Utility Pole
41 - Other Post, Pole or Support 42 - Culvert 43 - Curb 44 - Ditch 45 - Embankment 46 - Fence 47 - Mailbox	48 - Tree 49 - Fire Hydrant 50 - Work Zone Maintenance Equipment 51 - Wall, Building, Tunnel 52 - Other Fixed Object		

Unit Speed 00 <input checked="" type="checkbox"/> Scaled <input type="checkbox"/> Estimated	Posted Speed 25	Traffic Control 02 01 - No Controls 02 - Stop Sign 03 - Yield Sign 04 - Traffic Signal 05 - Traffic Flashers 06 - School Zone	07 - Railroad Crossbucks 08 - Railroad Flashers 09 - Railroad Gates 10 - Construction Barricade 11 - Person (Flagger, Officer) 12 - Pavement Markings	13 - Crosswalk Lines 14 - Walk/Don't Walk 15 - Other 16 - Not Reported	Unit Direction From 1 To 2 1 - North 2 - South 3 - East 4 - West 5 - Northeast 6 - Northwest 7 - Southeast 8 - Southwest 9 - Unknown
---	---------------------------	---	--	---	--



MOTORIST / NON-MOTORIST / OCCUPANT

LOCAL REPORT NUMBER
2014-13138

MOTORIST/Non-Motorist

MOTORIST/Non-Motorist

OCCUPANT

OCCUPANT

UNIT NUMBER 011	NAME: LAST, FIRST, MIDDLE Hilton, Susan L.	DATE OF BIRTH 08/21/1947	AGE 66	GENDER <input checked="" type="checkbox"/> F - FEMALE <input type="checkbox"/> M - MALE
---------------------------	--	------------------------------------	------------------	---

ADDRESS, CITY, STATE, ZIP 7044 Woodward Claypool Rd. Norrow, OH 45752	CONTACT PHONE- INCLUDE AREA CODE 513-313-8773
---	---

INJURIES <input checked="" type="checkbox"/>	INJURED TAKEN BY <input checked="" type="checkbox"/>	EMS AGENCY	MEDICAL FACILITY INJURED TAKEN TO	SAFETY EQUIPMENT USED 04	DOT COMPLIANT <input type="checkbox"/> MOTORCYCLE HELMET	SEATING POSITION 01	AIR BAG USAGE <input checked="" type="checkbox"/>	EJECTION <input checked="" type="checkbox"/>	TRAPPED <input checked="" type="checkbox"/>
---	---	------------	-----------------------------------	------------------------------------	---	-------------------------------	--	---	--

OL STATE OH	OPERATOR LICENSE NUMBER RF436063	OL CLASS 4	<input type="checkbox"/> NO VALID OL	<input type="checkbox"/> M/C END.	CONDITION <input checked="" type="checkbox"/>	ALCOHOL/DRUG SUSPECTED <input checked="" type="checkbox"/>	ALCOHOL TEST STATUS <input checked="" type="checkbox"/>	ALCOHOL TEST TYPE <input checked="" type="checkbox"/>	ALCOHOL TEST VALUE	DRUG TEST STATUS <input checked="" type="checkbox"/>	DRUG TEST TYPE <input checked="" type="checkbox"/>
-----------------------	--	----------------------	--------------------------------------	-----------------------------------	--	---	--	--	--------------------	---	---

OFFENSE CHARGED (<input checked="" type="checkbox"/> LOCAL CODE) 331.13	OFFENSE DESCRIPTION Improper Backing	CITATION NUMBER 75907	HANDS-FREE <input type="checkbox"/> DEVICE USED	DRIVER DISTRACTED BY <input checked="" type="checkbox"/>
--	--	---------------------------------	--	---

UNIT NUMBER 012	NAME: LAST, FIRST, MIDDLE King, Tina L.	DATE OF BIRTH 11/11/1970	AGE 43	GENDER <input checked="" type="checkbox"/> F - FEMALE <input type="checkbox"/> M - MALE
---------------------------	---	------------------------------------	------------------	---

ADDRESS, CITY, STATE, ZIP 6481 Indianwood Dr. Mason, OH 45040	CONTACT PHONE- INCLUDE AREA CODE 513-377-1187
---	---

INJURIES <input type="checkbox"/>	INJURED TAKEN BY <input type="checkbox"/>	EMS AGENCY	MEDICAL FACILITY INJURED TAKEN TO	SAFETY EQUIPMENT USED 04	DOT COMPLIANT <input type="checkbox"/> MOTORCYCLE HELMET	SEATING POSITION 01	AIR BAG USAGE <input checked="" type="checkbox"/>	EJECTION <input checked="" type="checkbox"/>	TRAPPED <input checked="" type="checkbox"/>
--------------------------------------	--	------------	-----------------------------------	------------------------------------	---	-------------------------------	--	---	--

OL STATE OH	OPERATOR LICENSE NUMBER RG580865	OL CLASS 4	<input type="checkbox"/> NO VALID OL	<input type="checkbox"/> M/C END.	CONDITION <input checked="" type="checkbox"/>	ALCOHOL/DRUG SUSPECTED <input checked="" type="checkbox"/>	ALCOHOL TEST STATUS <input checked="" type="checkbox"/>	ALCOHOL TEST TYPE <input checked="" type="checkbox"/>	ALCOHOL TEST VALUE	DRUG TEST STATUS <input checked="" type="checkbox"/>	DRUG TEST TYPE <input checked="" type="checkbox"/>
-----------------------	--	----------------------	--------------------------------------	-----------------------------------	--	---	--	--	--------------------	---	---

OFFENSE CHARGED (<input type="checkbox"/> LOCAL CODE)	OFFENSE DESCRIPTION	CITATION NUMBER	HANDS-FREE <input type="checkbox"/> DEVICE USED	DRIVER DISTRACTED BY <input type="checkbox"/>
--	---------------------	-----------------	--	--

INJURIES 1 - NO INJURY / NONE REPORTED 2 - POSSIBLE 3 - NON-IMPACTING 4 - IMPACTING 5 - FATAL	INJURED TAKEN BY 1 - NOT TRANSPORTED / TREATED AT SCENE 2 - EMS 3 - POLICE 4 - OTHER 9 - UNKNOWN	SAFETY EQUIPMENT USED MOTORIST 01 - NONE USED - VEHICLE OCCUPANT 02 - SHOULDER BELT ONLY USED 03 - LAP BELT ONLY USED 04 - SHOULDER AND LAP BELT USED	99 - UNKNOWN SAFETY EQUIPMENT NON-MOTORIST 09 - NONE USED 10 - HELMET USED 11 - PROTECTIVE PADS USED (ELBOWS, KNEES, ETC.) 12 - REFLECTIVE CLOTHING 13 - LIGHTING 14 - OTHER
--	---	--	---

SEATING POSITION 01 - FRONT - LEFT SIDE (MOTORCYCLE DRIVER) 02 - FRONT - MIDDLE 03 - FRONT - RIGHT SIDE 04 - SECOND - LEFT SIDE (MOTORCYCLE PASSENGER) 05 - SECOND - MIDDLE 06 - SECOND - RIGHT SIDE	07 - THIRD - LEFT SIDE (MOTORCYCLE SIDE CAR) 08 - THIRD - MIDDLE 09 - THIRD - RIGHT SIDE 10 - SLEEPER SECTION OF CAB (TRUCK) 11 - PASSENGER IN OTHER ENCLOSED CARGO AREA (NON-TRAILING UNIT SUCH AS A BUS, TRUCK WITH CAB)	12 - PASSENGER IN UNENCLOSED CARGO AREA 13 - TRAILING UNIT 14 - RIDING ON VEHICLE EXTERIOR (NON-TRAILING UNIT) 15 - NON-MOTORIST 16 - OTHER 99 - UNKNOWN	AIR BAG USAGE 1 - NOT DEPLOYED 2 - DEPLOYED FRONT 3 - DEPLOYED SIDE 4 - DEPLOYED BOTH FRONT/SIDE 5 - NOT APPLICABLE 9 - DEPLOYMENT UNKNOWN
--	--	---	--

EJECTION 1 - NOT EJECTED 2 - TOTALLY EJECTED 3 - PARTIALLY EJECTED 4 - NOT APPLICABLE	TRAPPED 1 - NOT TRAPPED 2 - EXTRICATED BY MECHANICAL MEANS 3 - EXTRICATED BY NON-MECHANICAL MEANS	OPERATOR LICENSE CLASS 1 - CLASS A 2 - CLASS B 3 - CLASS C 4 - REGULAR CLASS (OHIO'S "D") 5 - MC/MOPED ONLY	CONDITION 1 - APPARENTLY NORMAL 2 - PHYSICAL IMPAIRMENT 3 - EMOTIONAL (DEPRESSED, ANGRY, DISTURBED) 4 - ILLNESS 5 - FELL, ASLBER, FAINTED, FATIGUED UNDER THE INFLUENCE OF MEDICATIONS, DRUGS, ALCOHOL 7 - OTHER	ALCOHOL/DRUG SUSPECTED 1 - NONE 2 - YES - ALCOHOL SUSPECTED 3 - YES - HBD NOT IMPAIRED 4 - YES - DRUGS SUSPECTED 5 - YES - ALCOHOL AND DRUGS SUSPECTED
---	--	--	--	---

ALCOHOL TEST STATUS 1 - NONE GIVEN 2 - TEST REFUSED 3 - TEST GIVEN, CONTAMINATED SAMPLE/UNUSABLE 4 - TEST GIVEN, RESULTS KNOWN 5 - TEST GIVEN, RESULTS UNKNOWN	ALCOHOL TEST TYPE 1 - NONE 2 - BLOOD 3 - URINE 4 - BREATH 5 - OTHER	DRUG TEST STATUS 1 - NONE GIVEN 2 - TEST REFUSED 3 - TEST GIVEN, CONTAMINATED SAMPLE/UNUSABLE 4 - TEST GIVEN, RESULTS KNOWN 5 - TEST GIVEN, RESULTS UNKNOWN	DRUG TEST TYPE 1 - NONE 2 - BLOOD 3 - URINE 4 - OTHER	DRIVER DISTRACTED BY 1 - NO DISTRACTION REPORTED 2 - PHONE 3 - TEXTING/EMAILING 4 - ELECTRONIC COMMUNICATION DEVICE 5 - OTHER ELECTRONIC DEVICE (WALKMAN DEVICE, MP3, DVD) 6 - OTHER INSIDE THE VEHICLE 7 - EXTERNAL DISTRACTION
---	--	--	---	---

UNIT NUMBER 012	NAME: LAST, FIRST, MIDDLE Tidd, Irene	DATE OF BIRTH 07/12/2001	AGE 12	GENDER <input checked="" type="checkbox"/> F - FEMALE <input type="checkbox"/> M - MALE
---------------------------	---	------------------------------------	------------------	---

ADDRESS, CITY, STATE, ZIP 6481 Indianwood Dr. Mason, OH 45040	CONTACT PHONE- INCLUDE AREA CODE 513-377-1187
---	---

INJURIES <input checked="" type="checkbox"/>	INJURED TAKEN BY <input checked="" type="checkbox"/>	EMS AGENCY	MEDICAL FACILITY INJURED TAKEN TO Family Doctor	SAFETY EQUIPMENT USED 03	DOT COMPLIANT <input type="checkbox"/> MOTORCYCLE HELMET	SEATING POSITION 04	AIR BAG USAGE <input type="checkbox"/>	EJECTION <input type="checkbox"/>	TRAPPED <input checked="" type="checkbox"/>
---	---	------------	---	------------------------------------	---	-------------------------------	---	--------------------------------------	--

UNIT NUMBER 012	NAME: LAST, FIRST, MIDDLE Tidd, Owen	DATE OF BIRTH 09/21/1997	AGE 16	GENDER <input checked="" type="checkbox"/> F - FEMALE <input type="checkbox"/> M - MALE
---------------------------	--	------------------------------------	------------------	---

ADDRESS, CITY, STATE, ZIP 6481 Indianwood Dr. Mason, OH 45040	CONTACT PHONE- INCLUDE AREA CODE 513-377-1187
---	---

INJURIES <input type="checkbox"/>	INJURED TAKEN BY <input type="checkbox"/>	EMS AGENCY	MEDICAL FACILITY INJURED TAKEN TO	SAFETY EQUIPMENT USED 04	DOT COMPLIANT <input type="checkbox"/> MOTORCYCLE HELMET	SEATING POSITION 04	AIR BAG USAGE <input checked="" type="checkbox"/>	EJECTION <input checked="" type="checkbox"/>	TRAPPED <input checked="" type="checkbox"/>
--------------------------------------	--	------------	-----------------------------------	------------------------------------	---	-------------------------------	--	---	--



LOCAL REPORT NUMBER 14-13134	REPORTING AGENCY Mason Police Dept.	DATE OF CRASH MOX 10 26 12
IN COUNTY OF Warren	CRASH LOCATION Indianwood Dr. @ Western Row Rd.	

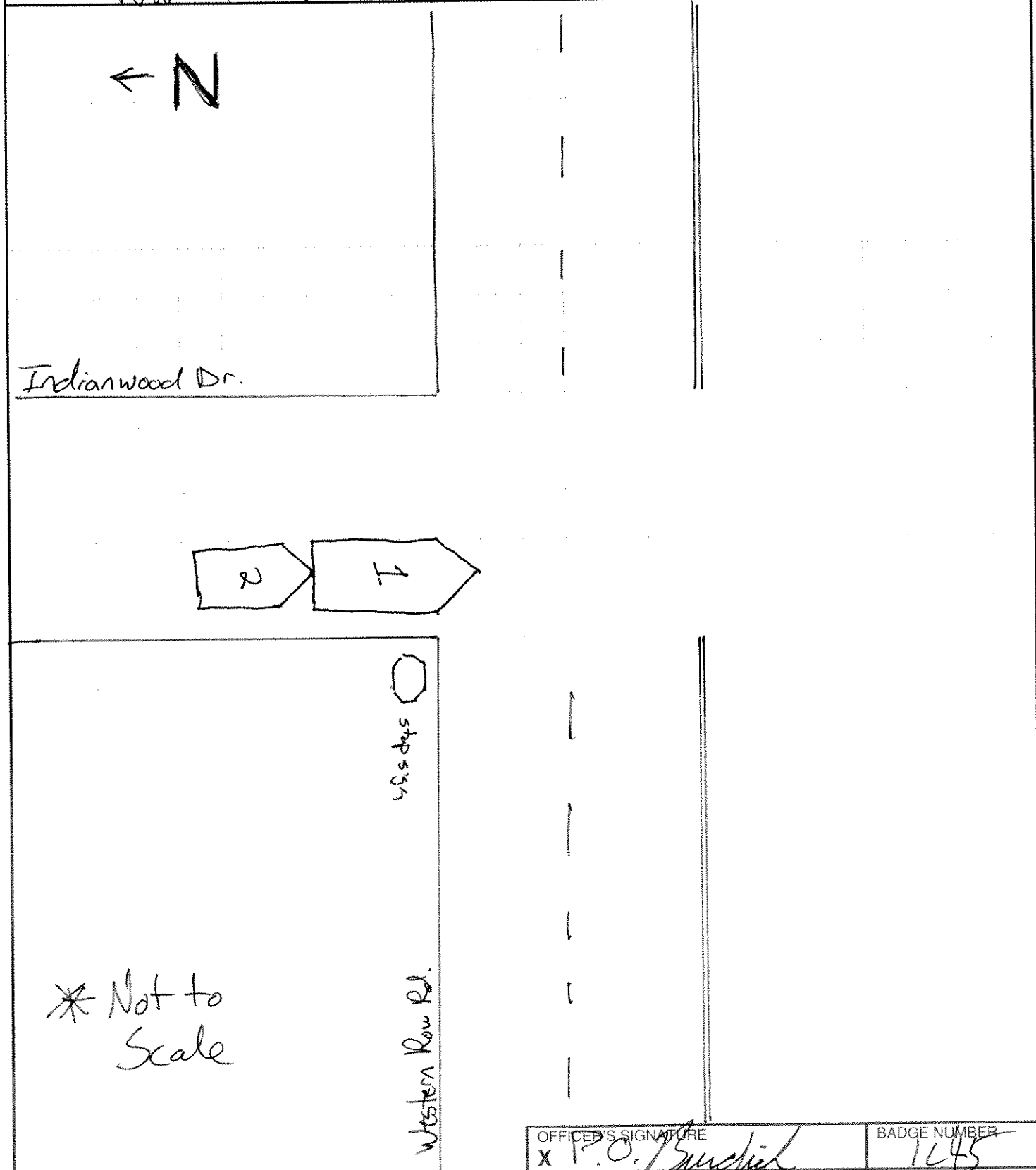

OFFICER'S SIGNATURE X P.O. Buchiel	BADGE NUMBER 1645
---------------------------------------	----------------------



LOCAL REPORT NUMBER 14-13138	REPORTING AGENCY Mason Police Dept.	DATE OF CRASH M 4 D 26 Y 14
---------------------------------	--	------------------------------------

FOR LOCAL USE ONLY - DO NOT SUBMIT TO THE STATE EXCEPT FOR FATAL CRASHES

I, SUSAN HILTON PRINTED HEREBY MAKE THIS VOLUNTARY STATEMENT TO
P.O. Buschick OFFICER'S NAME AT Indianwood @ Western Row LOCATION

I was pulling out onto western Row from Indianwood at approx 12:30. A car was coming from the left at a great enough distance that I could make the left hand turn. After checking traffic I began to pull out, when I was totally blocking the left lane of western Row, I saw a car speeding from the right. I backed up into Indianwood to avoid being hit by the car coming from the right. I hit the PT server behind me

ADDRESS OF WITNESS	PHONE 513-313-8773
SIGNATURE OF WITNESS X <u>Susan Hilton</u>	OFFICER'S SIGNATURE X <u>P.O. Buschick</u>



LOCAL REPORT NUMBER 14-13138	REPORTING AGENCY Mason Police Dept.	DATE OF CRASH M 4 D 26 Y 14
---------------------------------	--	------------------------------------

FOR LOCAL USE ONLY - DO NOT SUBMIT TO THE STATE EXCEPT FOR FATAL CRASHES

I, Tina King HEREBY MAKE THIS VOLUNTARY STATEMENT TO
PRINTED

P.O. Bueckel AT Indianwood @ Western Row
OFFICER'S NAME LOCATION

I was stopped behind a Ford F-150 truck at the stop sign at Indianwood Dr. where it meets Western Row. The truck suddenly backed up into my car. I tried to alert her with my horn but she did not stop.

6481 Indianwood Dr.
ADDRESS OF WITNESS Mason, OH 45040 PHONE 513-377-1187

Tina King SIGNATURE OF WITNESS P.O. Bueckel OFFICER'S SIGNATURE